



WINDOW TECHNOLOGY
DOOR TECHNOLOGY
AUTOMATIC ENTRANCE SYSTEMS
BUILDING MANAGEMENT SYSTEMS



WINDOW TECHNOLOGY

PSL – Parallel-Slide lightweight hardware



Securing technology for you



The Gretsch-Unitas group

Opening, moving, closing, securing – true to its motto "Securing technology for you", Gretsch-Unitas group provides groundbreaking solutions for window and door technology, automatic entrance systems and building management systems. With its system brands, the group delivers solutions for burglar inhibition at doors and windows, barrier-free construction, doors in escape and rescue routes through to bespoke facade solutions for projects.

INTERNATIONALITÄT

SYSTEM-LÖSUNGEN

INNOVATION

Gretsch-Unitas GmbH Baubeschläge



GU in Ditzingen is the headquarters of the group, development, administration and the production of modern architectural hardware for window and door technology. Apart from different flexible assembly departments, the production site comprises a high-tech punching and galvanising facility.

BKS GmbH



BKS manufactures mechanical and electronic locking cylinders, locks, locking systems and panic locks for escape and rescue routes. Harmonised mechanical and electronic system solutions are available for access control.

FERCO International S.A.S.



Ferco is the largest production site for window hardware in France. As a subsidiary of the Gretsch-Unitas group, Ferco also offers customer support and distribution in France for all products of the group.



GU Automatic



GU Automatic offers innovative, secure and reliable solutions for automatic entrance systems and automatic door systems, revolving doors, all-glass sliding walls, security curved sliding doors and controlled physical access.

ela-soft



With the successful GEMOS advanced physical security information and organisation system, ela-soft is one of the market and technology leaders in the building technology branch.

The new Parallel-Slide lightweight hardware PSL

The PSL hardware by Gretsch-Unitas is an exceptionally tight Parallel-Slide system for PVC, aluminium, timber and timber-aluminium profiles. It is particularly suitable for high buildings requiring a high degree of tightness, and for sash weights up to 200 kg. The smooth opening and closing operation is mechanically actuated via the handle, increasing ease of use and preventing mishandling. When closing, the sash is pressed against the frame with the two circumferential sealing layers, resulting in a very high tightness. Easy quiet movement of the PSL door due to precision-manufactured bogies with ball bearing supported rollers.

Overview of the PSL hardware:

- The sash position can be adapted to the corresponding frame situation by adjusting the height of the PSL bogie.
- The strikers secure the frame cams in all important positions. The frame cam is in the secure position in the striker **and also in the ventilation position.**
- The gasket pressure can be adapted to the individual installation situation via the frame cams. If the sash and/or frame sags, the frame cams can also subsequently be adjusted to the current situation.

1	The PSL bogie	6
2	The PSL guide unit	7
3	The PSL pressure unit	8
4	The PSL striker	12
5	The PSL central locking system	13
6	Thresholds for timber and timber-aluminium systems	14
	Table of contents with order pages	15



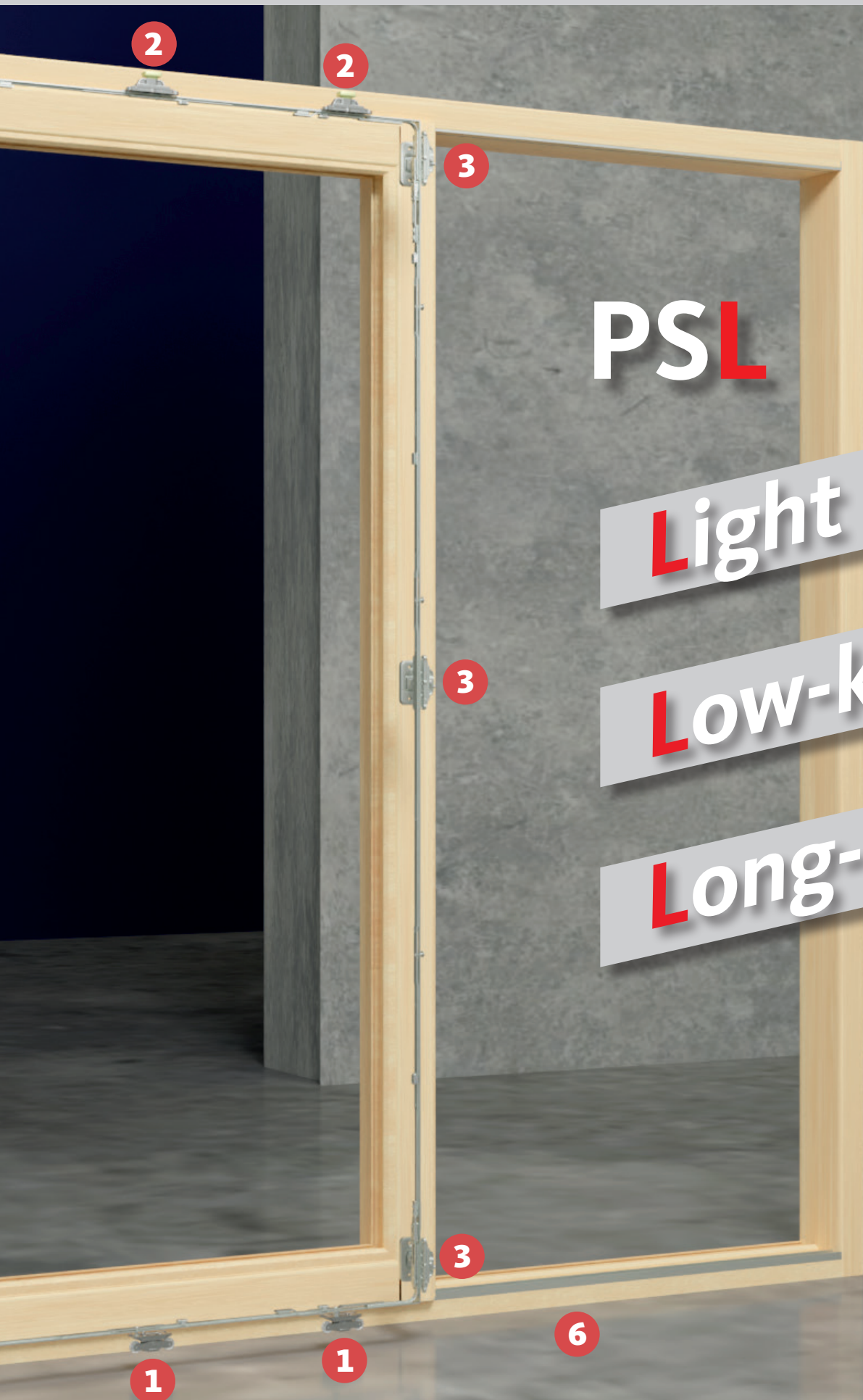

PSL

Light

Low-keyed

Long-lasting

Running smoothness due to high-quality bearing technology

The PSL bogie

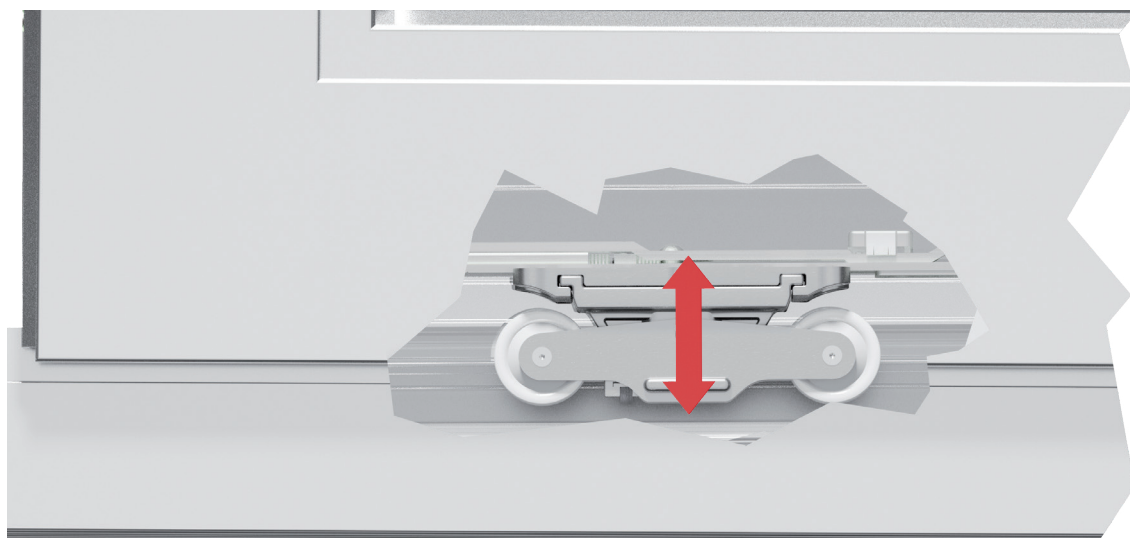

Front PSL bogie



+/- 1.5 mm

The PSL bogie – always at the right angle

The sash position can be adapted to the corresponding frame situation by adjusting the height of the PSL bogie. Parallel height adjustment of the sash is also possible.

Product characteristics

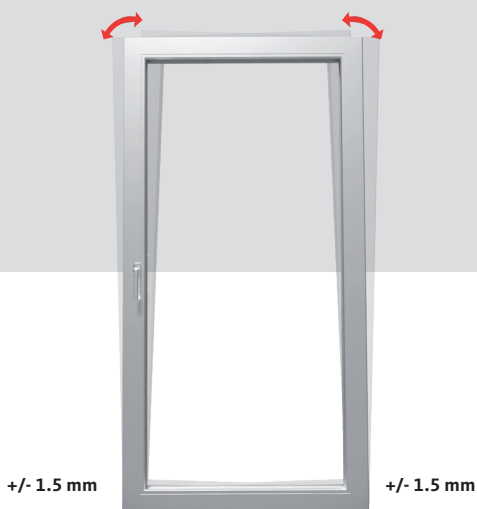
- Maintenance-free
- Reduced mounting time
- Easy quiet movement of the PSL door due to precision-manufactured PSL bogie with ball bearing supported rollers.



Lateral PSL adjustment range

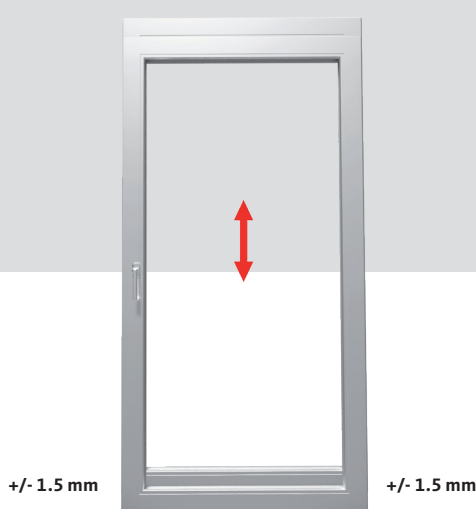

Vertical PSL adjustment range

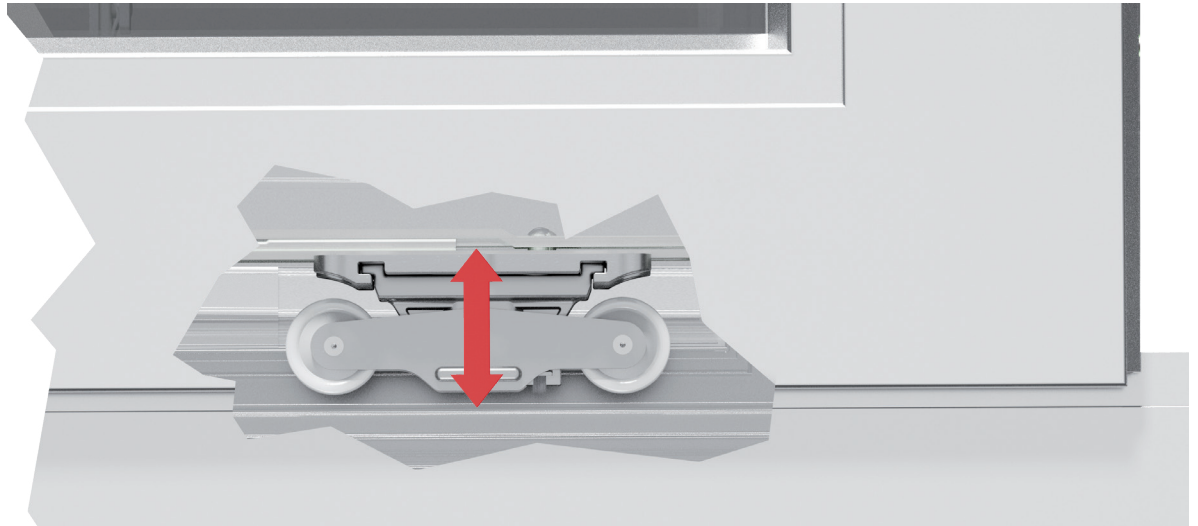

+/- 1.5 mm Rear PSL bogie

The PSL bogie – a tidy solution

The cleaning brush is a standard feature of the bogie, and cleans the roller track each time the door is opened and closed.



PSL bogie

Always correctly set

The PSL pressure unit MS and the PSL centre lock

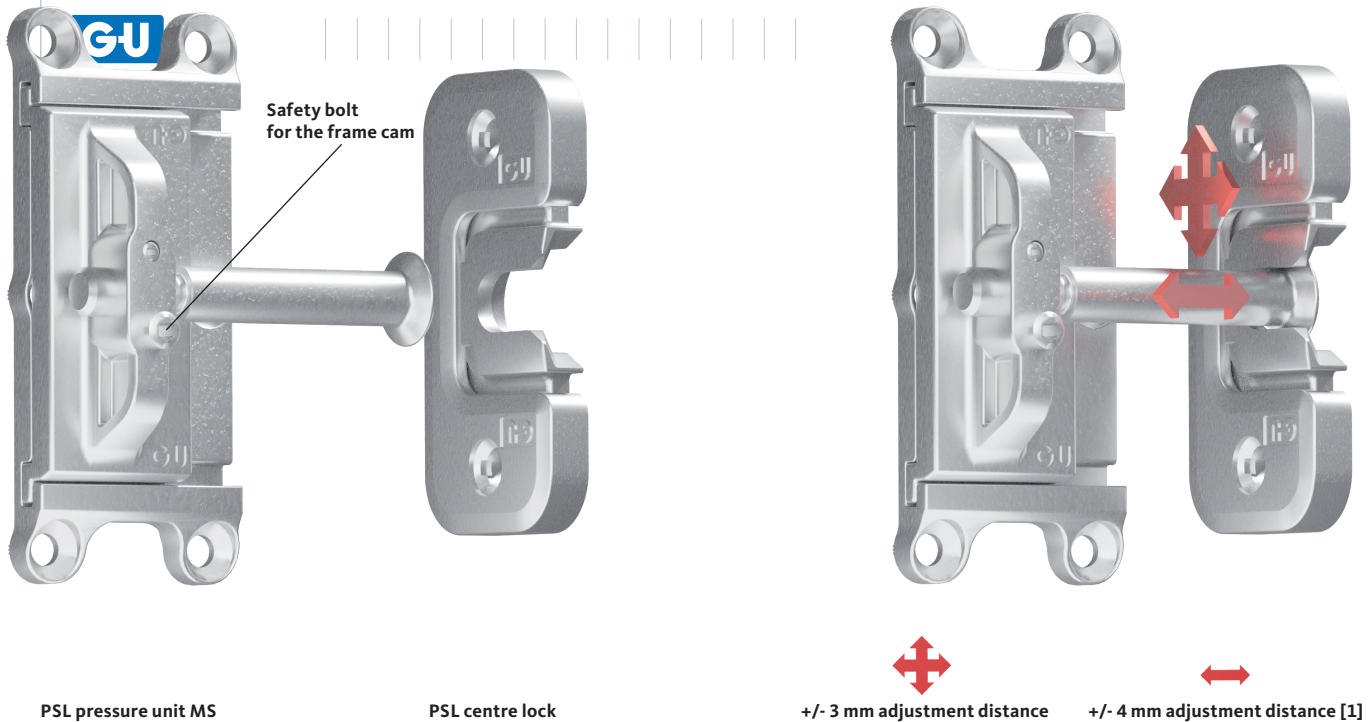

The PSL frame cam – simply individual

The gasket pressure can be adapted to the individual installation situation via the frame cams.

Product characteristics

- The PSL pressure unit MS with frame cam and PSL centre lock are maintenance-free
- Short installation time
- Reduced scope for errors

The installation is complete in just 3 steps

The position of the receiver in the PSL centre lock is automatically predetermined by the frame cam during installation. This reduces the installation time and ensures errors are kept to a minimum.

Step 1: Leave receiver in the PSL centre lock in the as-delivered position, slightly screw on the PSL centre lock in the installation position.

Step 2: Close PSL door. The frame cam now moves the receiver in the PSL centre lock to the required position.

Step 3: Open PSL door. Screw down the PSL centre lock and safety bolt for the frame cam.

[1] If the sash and/or frame sags, the frame cam can be adjusted by +/- 4 mm to compensate for the new situation

Precisely guided

The PSL guide unit

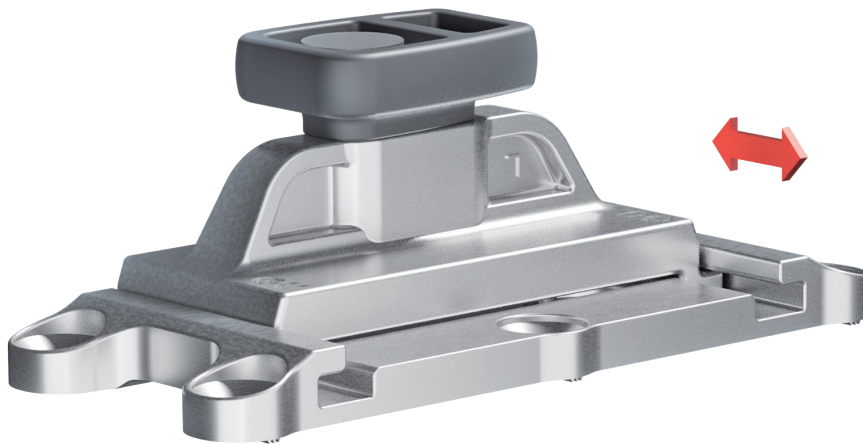

PSL guide unit

 max. 8 mm

The PSL guide unit – simply light

Product characteristics

- Maintenance-free (PSL guide unit)
- Reduced mounting time
- High degree of running smoothness

Completely tight

The PSL installation



Closed position

CLOSED handle position

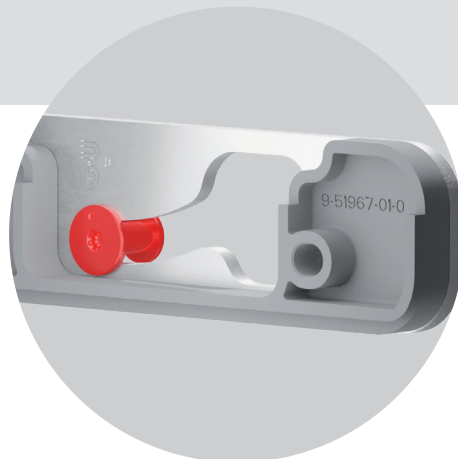
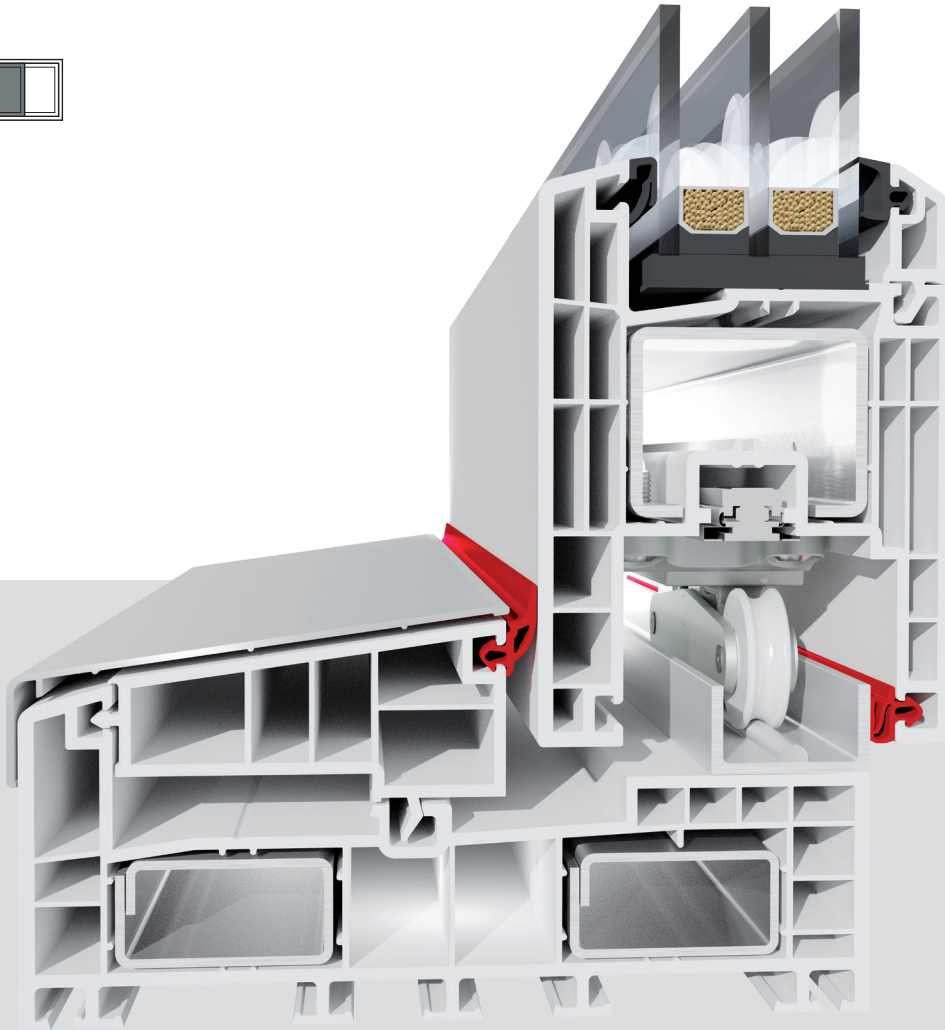
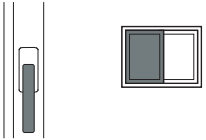

Well ventilated

The PSL ventilation function



Ventilation position

Night vent handle position

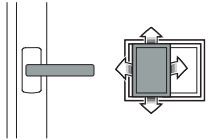

Open position

OPEN handle position

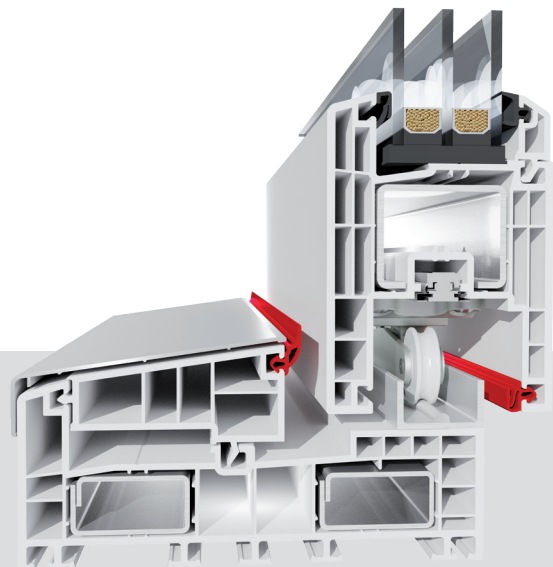
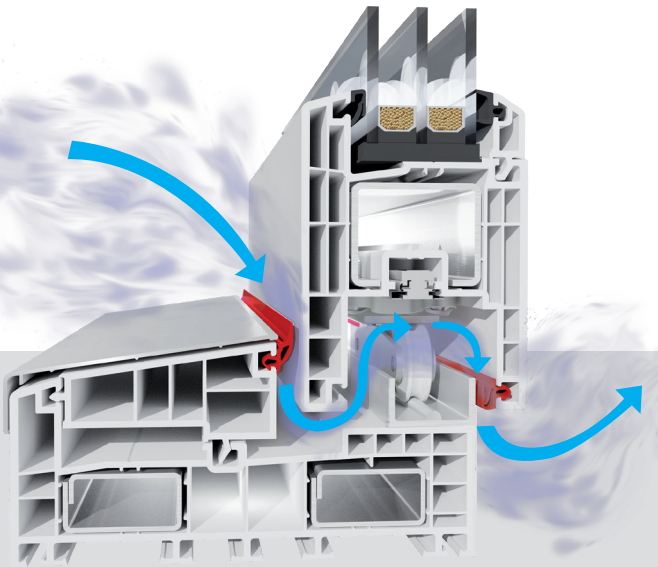
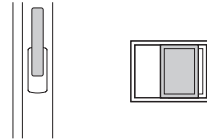

In the ventilation position, exhaust room air exits to the outside via the upper section of the sash and fresh air enters to the inside via the lower section. This ensures a constant supply of fresh air.

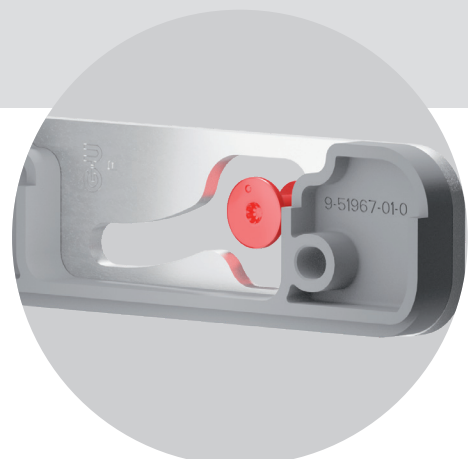
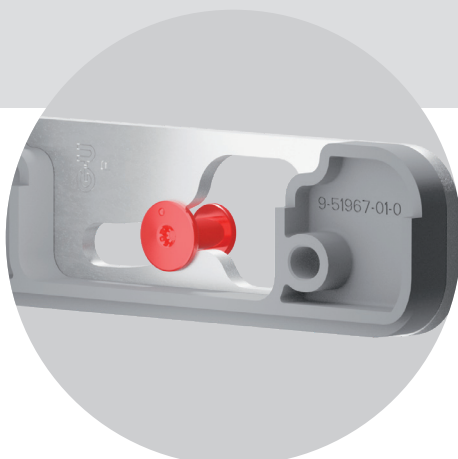

High quality with certainty

The PSL striker



PSL striker – DIN left



PSL striker – DIN right

The PSL striker – simply secure

The strikers secure the locking cams in the night ventilation position **as standard**, in other words when the locking cam is in the night ventilation position it is still inside the striker.

Product characteristics

- High level of security
- Non-handed



PSL striker on the left

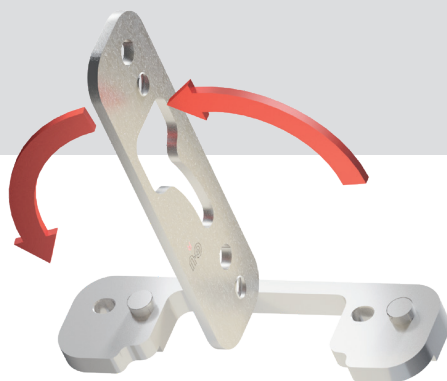

Turn round PSL striker



PSL striker on the right

A new member of the UNI-JET product family

The PSL central locking system



An all-encompassing solution

The central locking system for the PSL hardware used with the 16 mm sash groove comes from the UNI-JET product family. All customers who already use GU products need to do is supplement the PSL-specific products which enables them to fabricate and offer an entirely new window/door system.

The PSL central locking system consists of only 8 components:

- 4 x corner drive
- 3 x centre lock
- 1 x drive

Cleverle

The Cleverle automatic cam compensates for rebate clearance tolerances.

System solution for PSL doors

The PSL threshold

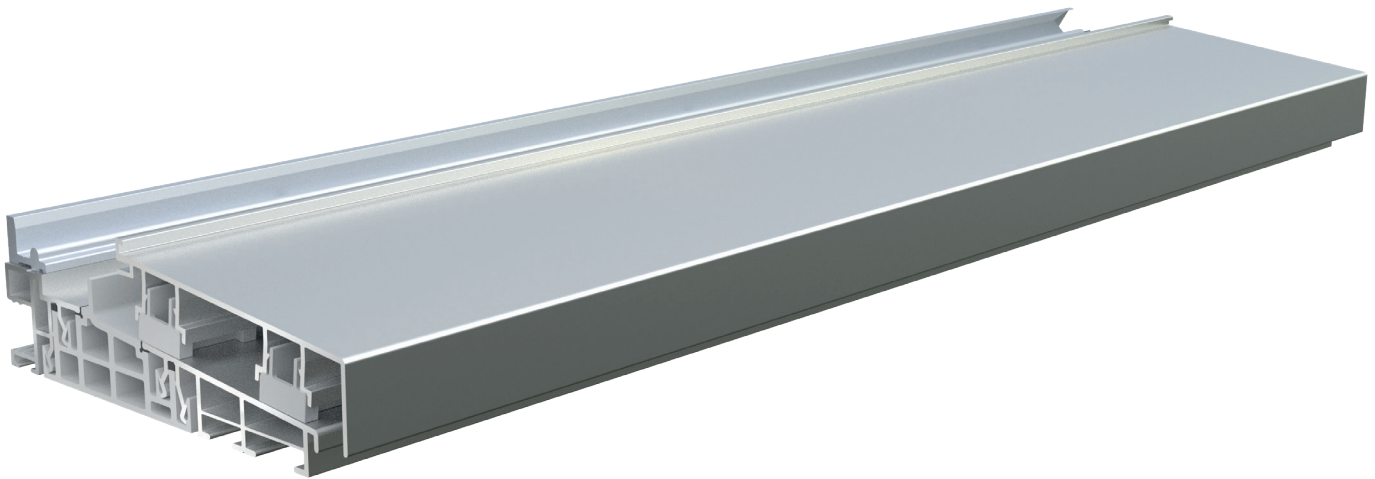

The PSL hardware combines high-quality design and innovative technology with the threshold specially developed for timber and timber/aluminium systems.

The inner area of the threshold can be widened to the required size using the same material as the PSL door. This gives the threshold the same design on the inside as the entire PSL door.

Product characteristics

- High tightness against driving rain according to EN 12208 up to class 9A
- Optimum thermal break integrated in the threshold
- High stability
- Recyclable thanks to clever choice of materials
- Reduced mounting time and usual processing
- Solid, perfected technology for a high degree of functional reliability in daily use



Hardware sets

UNI-JET central locking system – PVC/timber	Page 16
UNI-JET – PVC Hardware set	Page 20
UNI-JET Hardware set accessories – PVC RC2	Page 22
UNI-JET Central locking system – Timber and timber-aluminium systems	Page 28
ALU-JET 10 central locking system – Aluminium	Page 30
Aluminium – Hardware set	Page 34

Accessories

Thresholds	Page 38
Thresholds – Gaskets	Page 39
Thresholds – Gasket pad / fastening clip	Page 40
Flush pull	Page 41
Turn handles	Page 42
Drilling jigs	Page 44

Exclusion of liability/Copyright notice	Page 47
--	----------------

Hardware set

UNI-JET central locking system



kg
max. 200

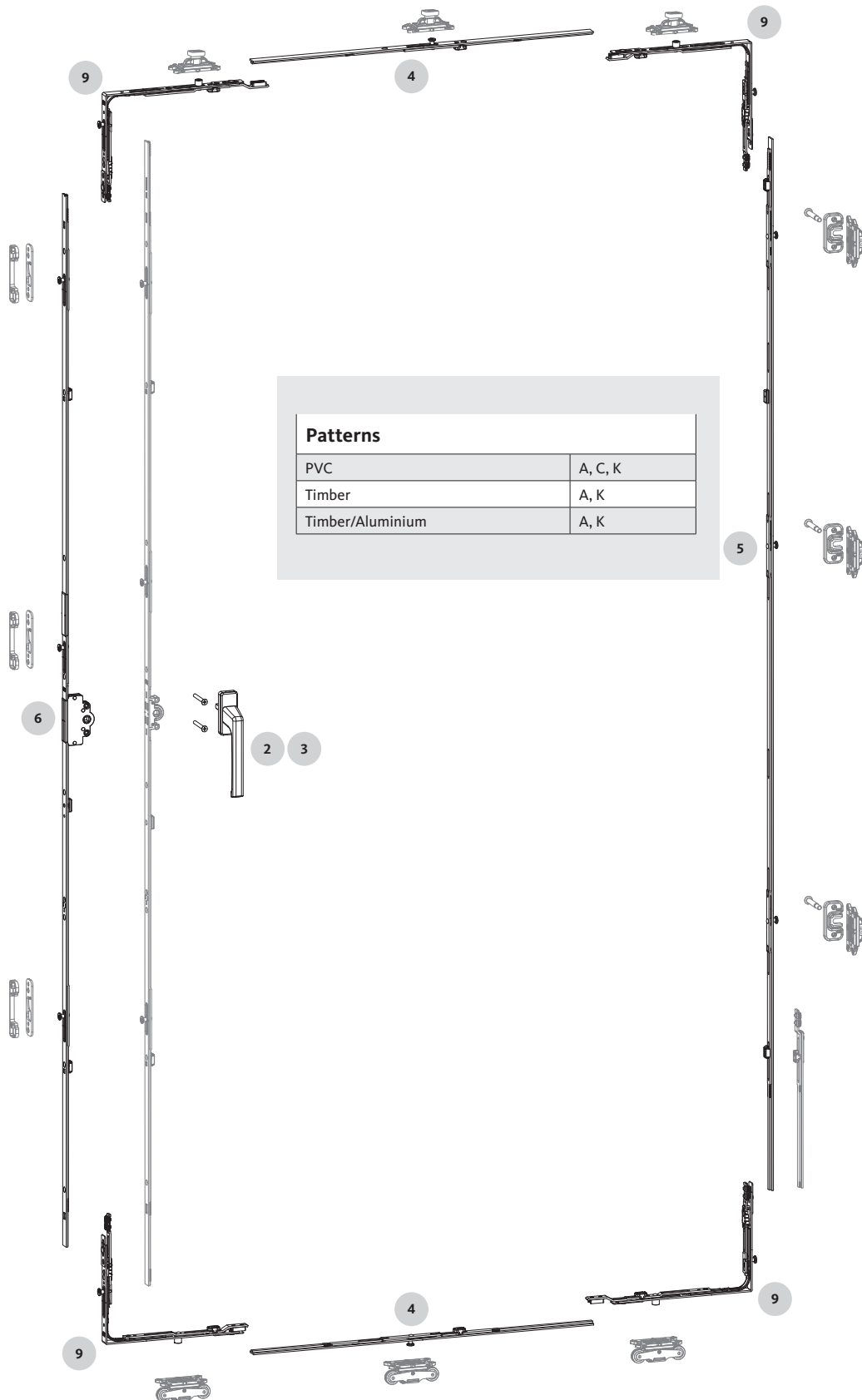



Corner-drive

Item	Pattern			Description	LC-MA	Order number
	A	C	K			
9	4	8	8	Corner-drive	1	included in the PSL basic set

Turn handle

Item	Pattern			Description	SW [kg]	Length [mm]	Finish	Order number
	A	C	K					
2	1	2	2	DIRIGENT turn handle 2/3 90°, 10mm lugs	> 180	160	Silver/EV 1 look	6-32629-43-0-11
							Dark brown	6-32629-43-0-5
							White, RAL 9016	6-32629-43-0-7
				DIRIGENT-F turn handle, turn handle 10mm lugs	< 180	127	Silver/EV 1 look	6-28072-43-0-11
							Dark brown	6-28072-43-0-5
							White, RAL 9016	6-28072-43-0-7

Additional finishes and spindle lengths available on request

M5 countersunk screw for fastening the turn handle

Item	Pattern			Description	Order number
	A	C	K		
3	2	4	4	Countersunk screw M5 x 45 mm	9-13255-45-R-1

Horizontal extension

Item	Pattern			Description	SRW [mm]	LC-MA	Order number
	A	C	K				
4	2	4	4	Extension 415	560 – 855	–	6-26741-00-0-1
				Extension	856 – 1190 [1]	1	6-32781-01-0-1
					1191 – 1570	1	6-32781-02-0-1
					1571 – 2070	1	6-32781-03-0-1

Vertical extension

Item	Pattern			Description	SRH [mm]	LC-MA	Order number
	A	C	K				
5	1	2	2	Waste of cropped faceplate/connecting rod	508 – 735	–	6-26741-00-0-1
				Extension	736 – 1070 [2]	1	6-32781-01-0-1
					1071 – 1450	1	6-32781-02-0-1
					1451 – 1850	1	6-32781-03-0-1
					1851 – 2100	3	6-32494-80-0-1
					2101 – 2350 [3]	4	6-32494-90-0-1

Large backset drive gear – backset 35 – variable handle height

Item	Pattern			Description	SRH [mm]	LC-MA	Order number
	A	C	K				
6	1	2	2	Variable handle height Tilt&Turn drive-gear	508 – 590	–	6-38489-35-0-1
					591 – 950	–	G-22343-35-0-1
					951 – 1450 [2]	1	G-22344-35-0-1
					1451 – 1950	2	G-22345-35-0-1
					1951 – 2450 [3]	3	G-22346-35-0-1

[1] The set PSL supplement SRW > 980 is required from SRW 980 mm. Up to SRW 980 the locking cam moves along empty.

[2] The set PSL supplement SRH > 1035 is required from SRH 1035 mm. This includes the additional striker. Up to SRH 1035 the locking cam moves along empty.

[3] Two PSL supplement SRH sets are required from SRH 2101 mm.

Hardware set

UNI-JET central locking system



kg
max. 200

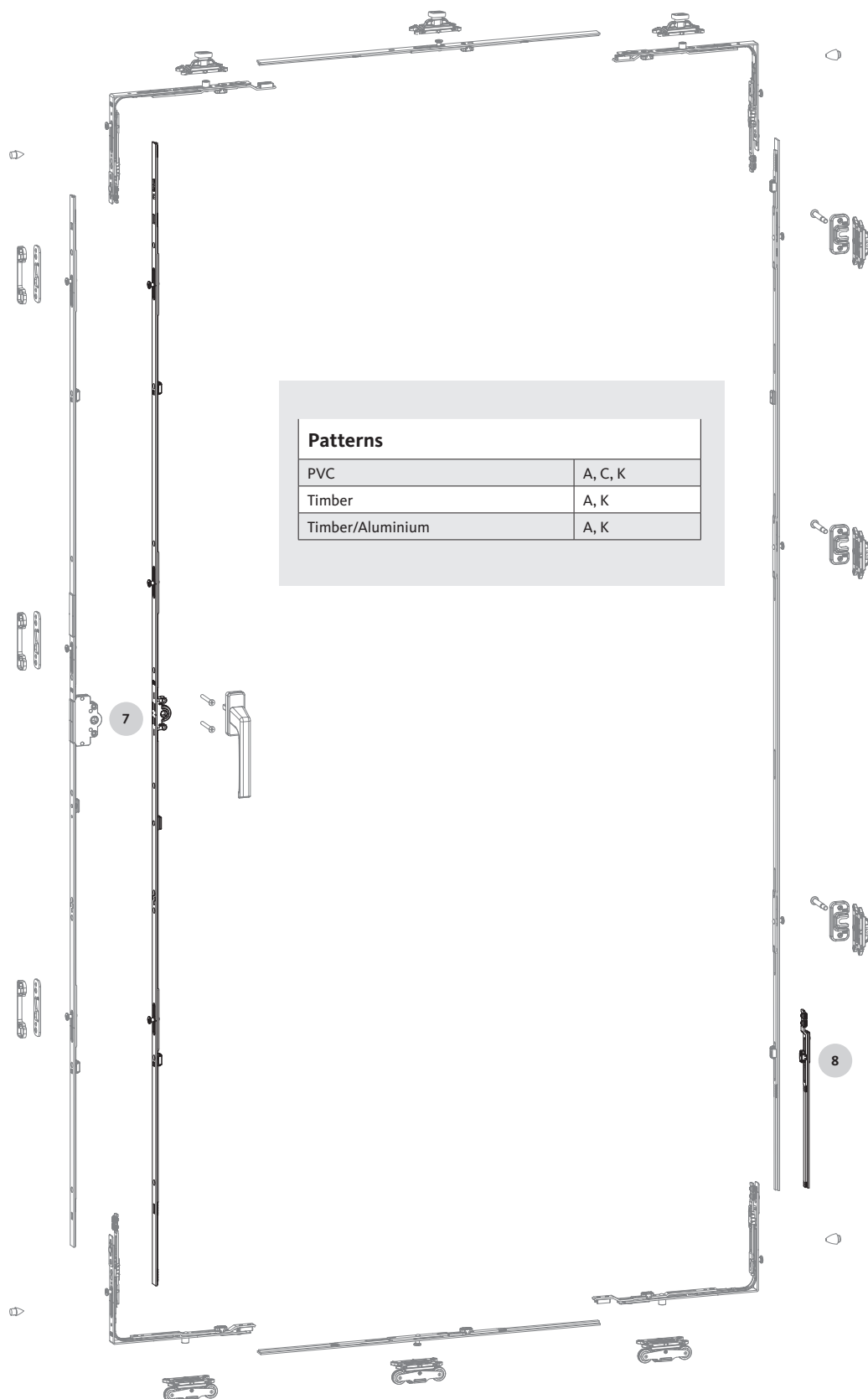

Patterns

PVC	A, C, K
Timber	A, K
Timber/Aluminium	A, K



Optional components

Tilt&Turn drive gear – backset 15 – variable handle height							
Item	Pattern			Description	SRH [mm]	LC-MA	Order number
	A	C	K				
7	1	2	2	T&T drive-gear 15, variable handle height	508 – 590	–	G-22080-00-0-1
					591 – 750	–	G-22081-00-0-1
					751 – 1200 [2]	1	G-22082-00-0-1
					1201 – 1450	1	G-22083-00-0-1
					1451 – 1700	2	G-22084-00-0-1
					1701 – 1950	2	G-22085-00-0-1
					1951 – 2450	3	G-22086-00-0-1
Extension 250							
Item	Pattern			Description	SRH [mm]	LC-MA	Order number
	A	C	K				
8	1	2	2	Extension 250	2351 – 2450	–	8-00625-00-0-1

[2] The set PSL supplement SRH > 1035 is required from SRH 1035 mm. This includes the additional striker. Up to SRH 1035 the locking cam moves along empty.

Hardware set

PVC



kg
max. 200

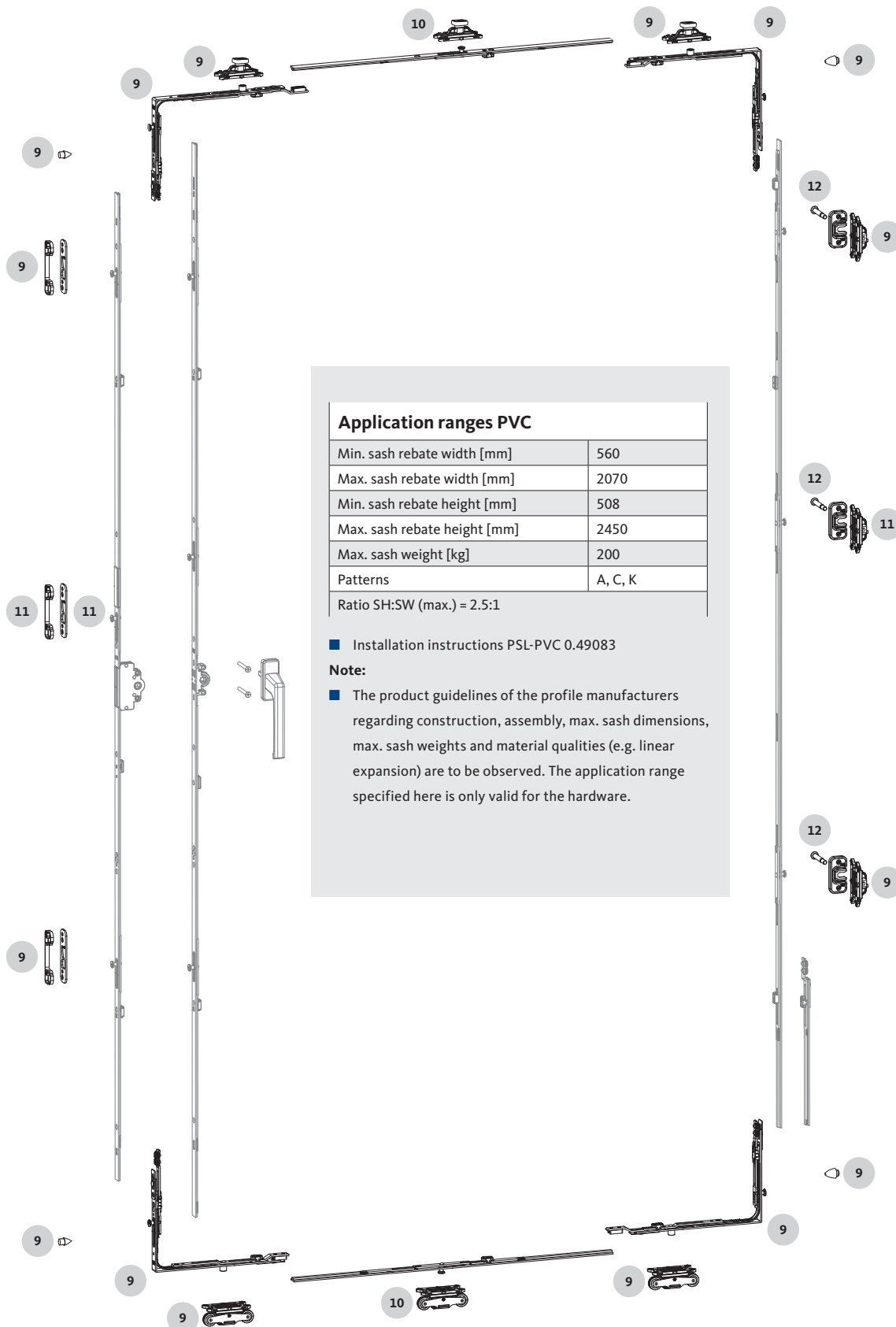

Application ranges PVC

Min. sash rebate width [mm]	560
Max. sash rebate width [mm]	2070
Min. sash rebate height [mm]	508
Max. sash rebate height [mm]	2450
Max. sash weight [kg]	200
Patterns	A, C, K
Ratio SH:SW (max.) = 2.5:1	

■ Installation instructions PSL-PVC 0.49083

Note:

■ The product guidelines of the profile manufacturers regarding construction, assembly, max. sash dimensions, max. sash weights and material qualities (e.g. linear expansion) are to be observed. The application range specified here is only valid for the hardware.



PSL basic set

Item	Pattern			Description	SRW [mm]	SRH [mm]	DIN	Order number
	A	C	K					
9	1	1	2	PSL basic set + corner-drive	560 – 2070	508 – 2450	left	K-20376-00-L-1
							right	K-20376-00-R-1

Contains: 2 x PSL bogie, 2 x PSL guide unit, 2 x PSL pressure unit MS, 2 x striker complete, 2 x PSL centre lock, 4 x rubber buffer, 4 x PSL corner-drive, 4 x screw-hole cover cap

PSL frame cam MS

Item	Pattern			Description	System	Length [mm]	Order number
	A	C	K				
12	1	1	2	Frame cam, timber	Aluplast, VEKAMOVE 76	64	K-20380-01-0-8
				PSL frame cam MS	Rehau, Gealan	69	K-20380-00-0-8
					-	79	K-20380-02-0-8
				Frame cam, aluminium	Ulsan	57.5	K-20380-03-0-8

To be ordered separately from sash rebate width 980 mm:

Set PSL supplement

Item	Pattern			Description	SRW [mm]	SRH [mm]	DIN	Order number
	A	C	K					
10	1	1	2	Set PSL supplement	981 – 2070	508 – 2450	left	K-20376-10-L-1
							right	K-20376-10-R-1

Contains: 1 x PSL bogie, 1 x PSL guide unit, 2 x cover cap

To be ordered separately from sash rebate height 1035 mm:

Set PSL supplement

Item	Pattern			Description	SRW [mm]	SRH [mm]	DIN	Order number
	A	C	K					
11	1	1	2	Set PSL supplement	560-2070	1035 – 2100	left	K-20376-20-L-1
							right	K-20376-20-R-1
	2	2	4			2101 – 2450	left	K-20376-20-L-1
							right	K-20376-20-R-1

Contains: 1 x PSL pressure unit, 1 x PSL centre lock, 1 x striker complete

PSL frame cam MS

Item	Pattern			Description	System	Length [mm]	Order number
	A	C	K				
12	1	1	2	Frame cam, timber	Aluplast, VEKAMOVE 76	64	K-20380-01-0-8
				PSL frame cam MS	Rehau, Gealan	69	K-20380-00-0-8
					-	79	K-20380-02-0-8
				Frame cam, aluminium	Ulsan	57.5	K-20380-03-0-8

Hardware set accessories

PVC RC2

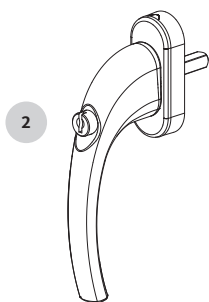
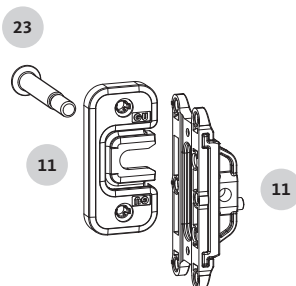
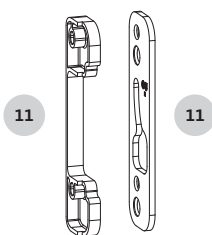



Set PSL supplement SRH PVC

Item	Pattern			Description	SRH [mm]	DIN	Order number
	A	C	K				
11	1	-	2	PSL supplement	951 - 2100	left	K-20376-20-L-1
						right	K-20376-20-R-1
	2	-	4		2101 - 2450	left	K-20376-20-L-1
						right	K-20376-20-R-1

Contains: 1 x PSL-pressure unit MS, 1 x striker GS, 1 x end piece, 1 x PSL centre lock, 1 x RC strip depending on profile, 1 x anti-drill plate

Turn handle

Item	Pattern			Description	Colour	Order number
	A	C	K			
2	1	-	2	MODENA-F/Z handle, 100 Nm, 10mm lugs	Silver/EV 1 look	6-34397-33-0-1
					Dark brown	6-34397-33-0-5
					White, RAL 9016	6-34397-33-0-7
					Silver/EV 1 look	6-34397-38-0-1
					Dark brown	6-34397-38-0-5
White, RAL 9016	6-34397-38-0-7					

PSL frame cam MS L = 69 mm

Item	Pattern			Description	SRH [mm]	Length [mm]	Order number
	A	C	K				
23	1	-	2	Frame cam	up to 1034	69	K-20380-00-0-8

PSL frame cam MS L = 64 mm

Item	Pattern			Description	SRH [mm]	Length [mm]	Order number
	A	C	K				
23	1	-	2	Frame cam, timber	up to 1034	64	K-20380-01-0-8

PSL frame cam MS L = 79 mm

Item	Pattern			Description	SRH [mm]	Order number
	A	C	K			
23	1	-	2	Frame cam	up to 1034	K-20380-02-0-8

RC Meeting stile strip

Item	Pattern			Description	Length [mm]	Order number
	A	C	K			
26A	1	-	2	Meeting stile strip	2310	9-52381-00-0-1

Fixing screw

Item	Pattern			Description	Order number
	A	C	K		
-	8	-	16	Countersunk-head screw 4.2 x 30 mm	E-12562-30-0-1

Hardware set

Additional locking cam arrangement for RC2 gear



A frame cam is always required in the application range SRH 951 – 2450 mm if specified by this symbol.
Every additional pressure unit requires a frame cam.

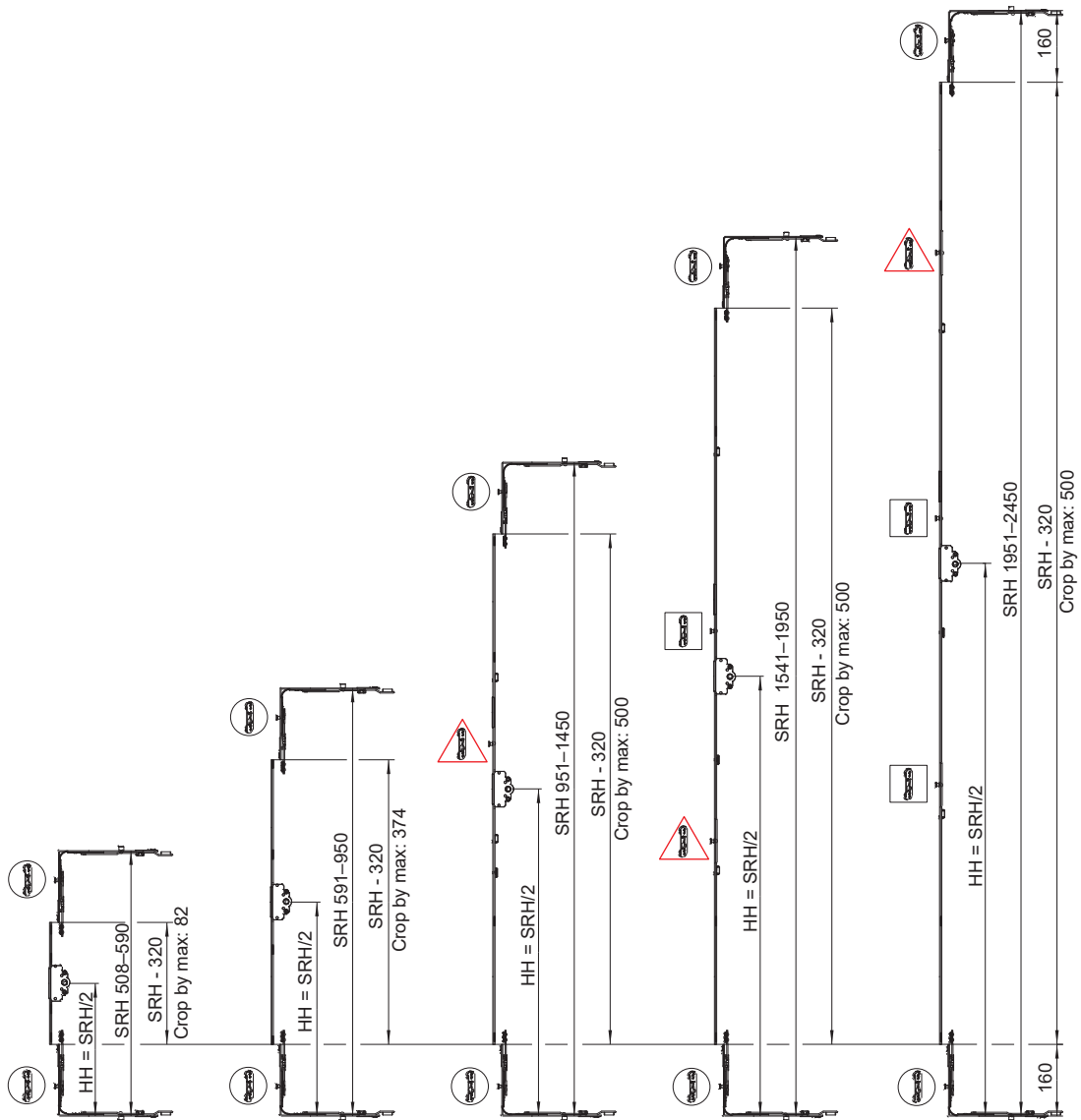

Hardware set

Additional locking cam arrangement for RC2 meeting stile



kg
max. 200

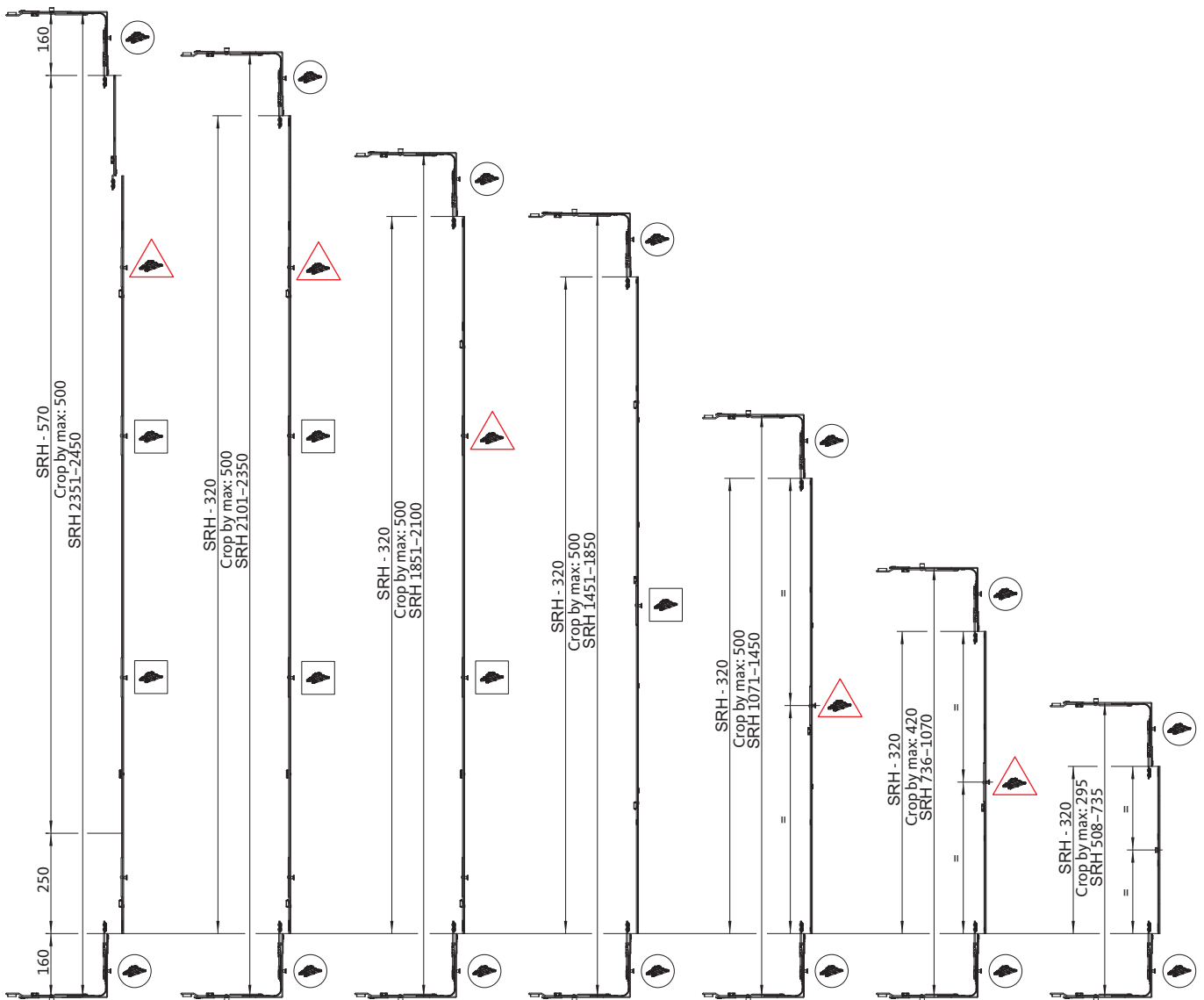

Corner-drive cam arrangement. To install the PSL locking cam, the sash must be unhinged again.

Hardware set

Installation of RC strip

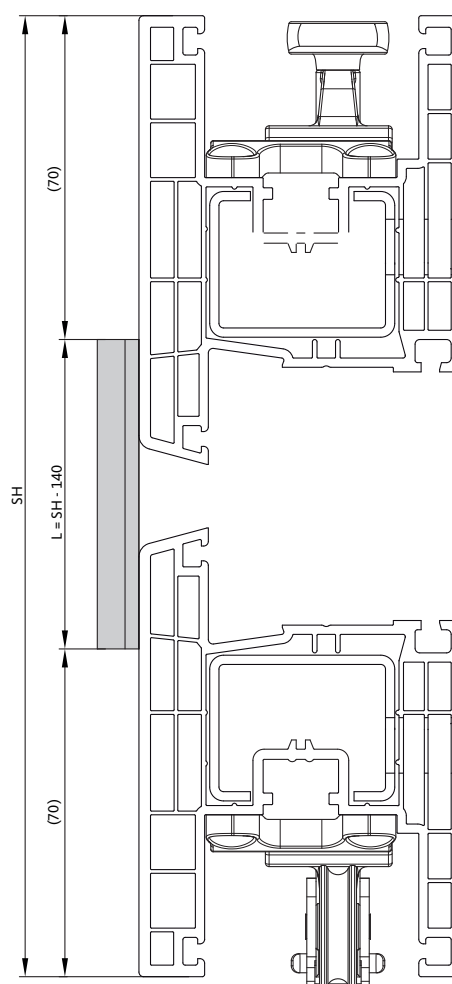
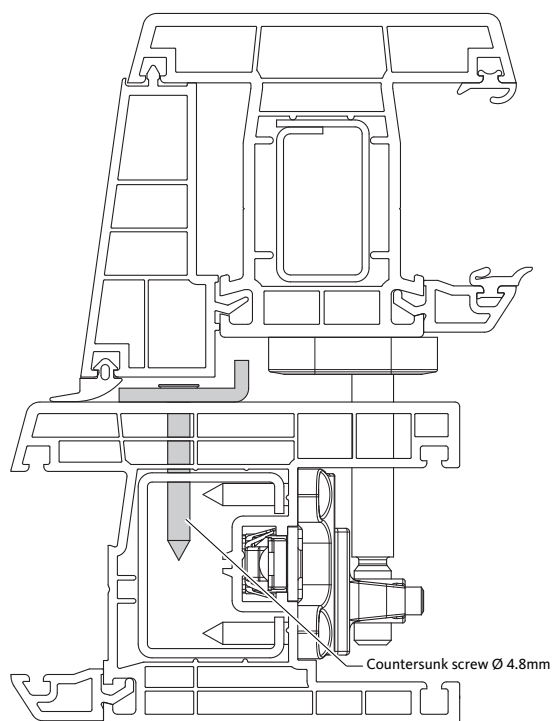

The RC strip depends on the profile, as do the positioning and screw length.



Hardware set

Timber and timber-aluminium systems



kg
max. 200

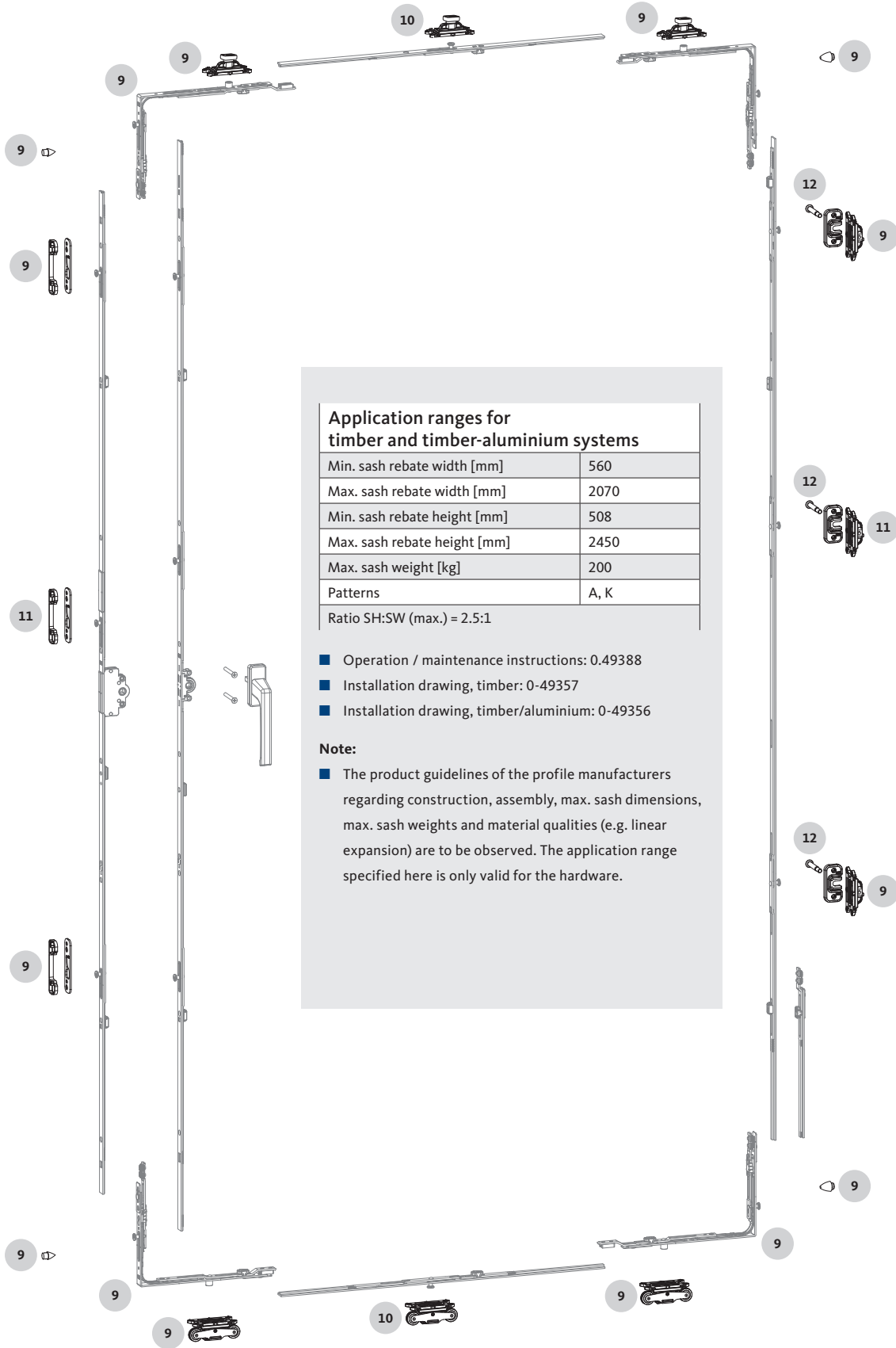

Application ranges for timber and timber-aluminium systems

Min. sash rebate width [mm]	560
Max. sash rebate width [mm]	2070
Min. sash rebate height [mm]	508
Max. sash rebate height [mm]	2450
Max. sash weight [kg]	200
Patterns	A, K

Ratio SH:SW (max.) = 2.5:1

- Operation / maintenance instructions: 0.49388
- Installation drawing, timber: 0-49357
- Installation drawing, timber/aluminium: 0-49356

Note:

- The product guidelines of the profile manufacturers regarding construction, assembly, max. sash dimensions, max. sash weights and material qualities (e.g. linear expansion) are to be observed. The application range specified here is only valid for the hardware.



PSL basic set

Item	Pattern			Description	SRW [mm]	SRH [mm]	DIN	Order number
	A	C	K					
9	1	-	2	PSL basic set + corner-drive	560 – 2070	508 – 2450	left	K-20377-00-L-1
							right	K-20377-00-R-1

Contains: 2 x PSL bogie, 2 x PSL guide unit, 2 x PSL pressure unit MS, 2 x striker complete, 2 x PSL centre lock, 4 x rubber buffer, 4 x PSL corner-drive, 4 x cover cap

PSL frame cam MS

Item	Pattern			Description	System	Length [mm]	Order number
	A	C	K				
12	1	1	2	Frame cam, timber	Aluplast, VEKAMOVE 76	64	K-20380-01-0-8
				PSL frame cam MS	Rehau, Gealan	69	K-20380-00-0-8
					-	79	K-20380-02-0-8
				Frame cam, aluminium	Ulsan	57.5	K-20380-03-0-8

To be ordered separately from sash rebate width 980 mm:

Set PSL supplement

Item	Pattern			Description	SRW [mm]	SRH [mm]	DIN	Order number
	A	C	K					
10	1	-	2	Set PSL supplement	981 – 2070	508 – 2450	left	K-20377-10-L-1
							right	K-20377-10-R-1

Contains: 1 x PSL bogie, 1 x PSL guide unit, 2 x cover cap

To be ordered separately from sash rebate height 1035 mm:

Set PSL supplement

Item	Pattern			Description	SRW [mm]	SRH [mm]	DIN	Order number
	A	C	K					
11	1	-	2	Set PSL supplement	560 – 2070	1036 – 2450	left	K-20377-20-L-1
							right	K-20377-20-R-1
	2	-	4			2101 – 2450	left	K-20377-20-L-1
							right	K-20377-20-R-1

Contains: 1 x PSL pressure unit, 1 x PSL centre lock, 2 x striker complete

PSL frame cam MS

Item	Pattern			Description	System	Length [mm]	Order number
	A	C	K				
12	1	1	2	Frame cam, timber	Aluplast, VEKAMOVE 76	64	K-20380-01-0-8
				PSL frame cam MS	Rehau, Gealan	69	K-20380-00-0-8
					-	79	K-20380-02-0-8
				Frame cam, aluminium	Ulsan	57.5	K-20380-03-0-8

Hardware set

ALU-JET 10 central locking system



kg
max. 200

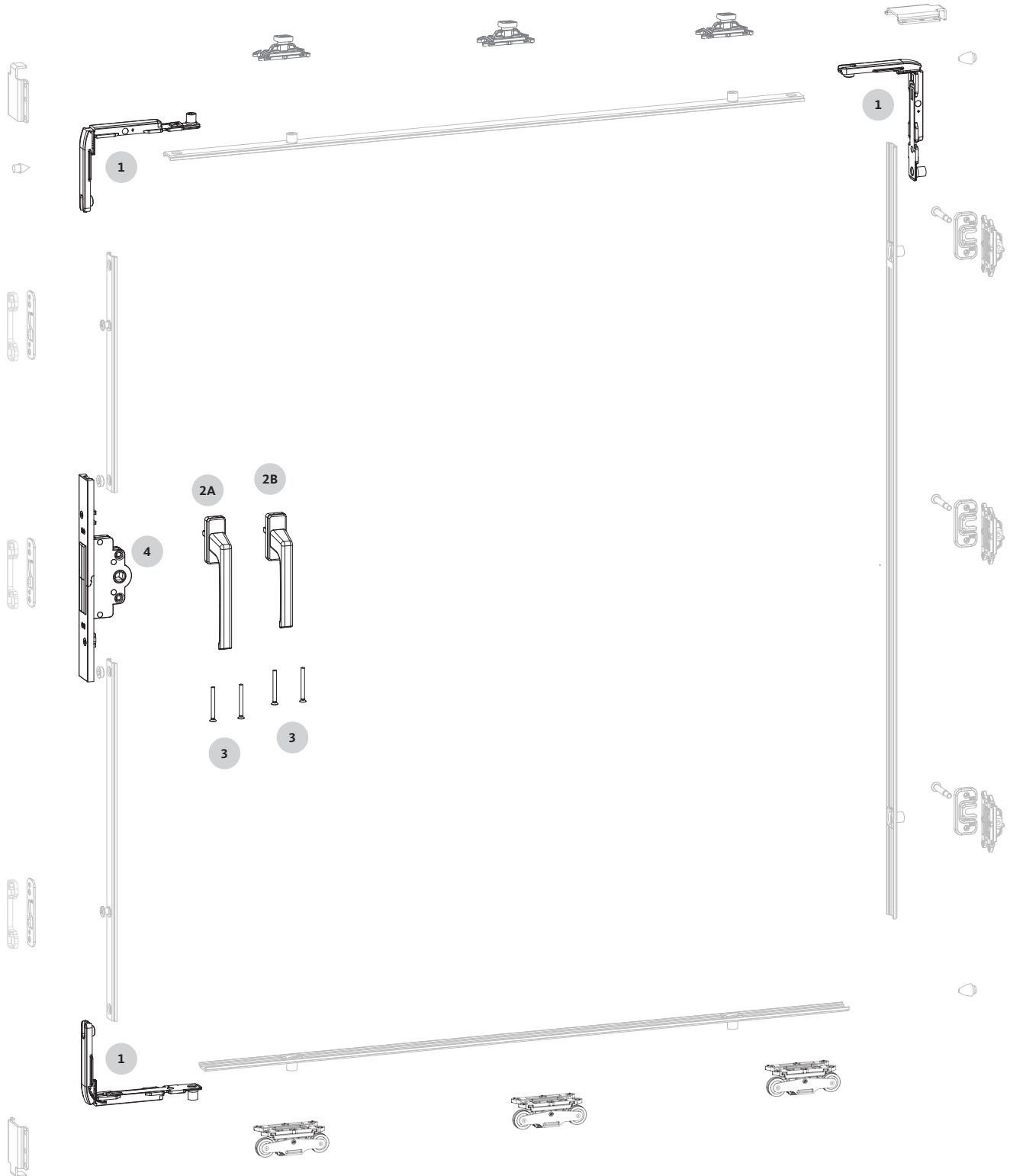

Hardware set

ALU-JET 10 central locking system



ALU-JET 10 corner-drive w/o M.D.

Item	Pattern				Description	Surface	Order number
	A	C	K	G			
1	3	6	6	3	Corner-drive without M.D.	ferGUard	K-19774-08-0-1

Included in the PSL basic set K-20378-00-0-1

Turn handle

Item	Pattern				Description	SWe	Surface	Order number
	A	C	K	G				
2A	1	2	2	1	DIRIGENT turn handle f. T&S 2/3 90°, 10mm lugs (L=160)	> 180 kg	Silver/EV 1 look	6-32629-33-0-11
							Dark brown	6-32629-33-0-5
							White, RAL 9016	6-32629-33-0-7
							Silver/EV 1 look	6-32629-38-0-11
							Dark brown	6-32629-38-0-5
2B	1	2	2	1	Turn handle DIRIGENT-F, 10 mm lugs (L=127)	< 180 kg	White, RAL 9016	6-32629-38-0-7
							Silver/EV 1 look	6-28072-33-0-11
							Dark brown	6-28072-33-0-5
							White, RAL 9016	6-28072-33-0-7
							Silver/EV 1 look	6-28072-38-0-11
							Dark brown	6-28072-38-0-5
							White, RAL 9016	6-28072-38-0-7
							Silver/EV 1 look	6-28072-38-0-11

Handle screw

Item	Pattern				Description	Order number
	A	C	K	G		
3	2	4	4	2	Countersunk screw DIN 965-M5x40-4.8-H	9-13255-40-0-1
					Countersunk screw DIN 965-M5x45-4.8-H	9-13255-45-R-1
					Countersunk screw DIN 965-M5x50-4.8-H	9-13255-50-R-1

Insertable gear^[1]

Item	Pattern				Description	Order number
	A	C	K	G		
4	1	2	2	1	Insertable gear w/o M.D.	6-25916-25-0-1
						6-25916-35-0-1

[1] Backset depending on profile

Hardware set

ALU-JET 10 central locking system



kg
max. 200

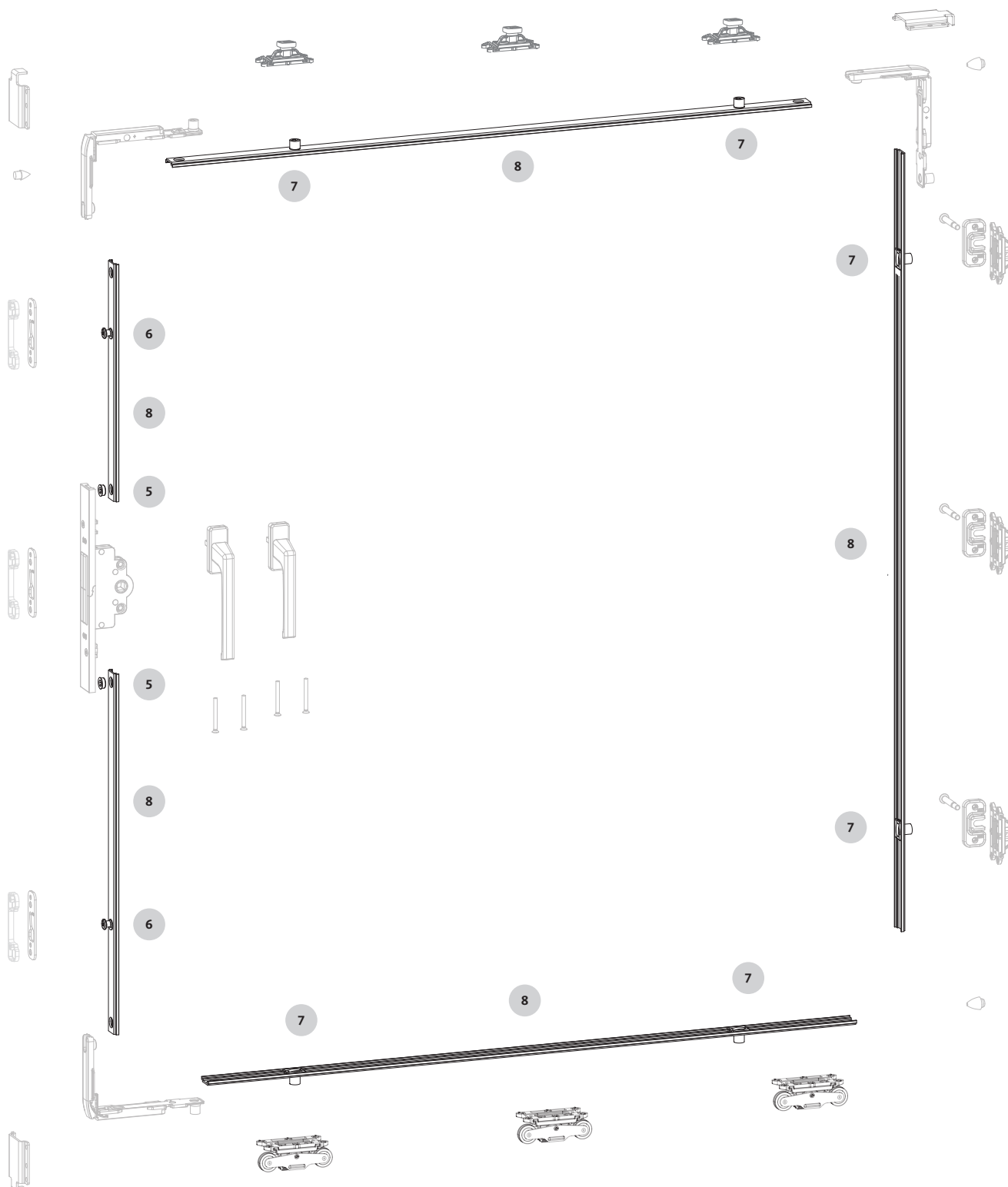
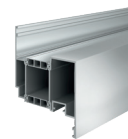

Hardware set

ALU-JET 10 central locking system



Adapter ring

Item	Pattern				Description	Order number
	A	C	K	G		
5	2	4	4	2	Adapter ring Ø6 to Ø10	9-48454-00-0-6

Mushroom cam on gear side

Item	Pattern				Description	SH [mm]	Order number
	A	C	K	G			
6	2	2	4	2	ALU-JET 10 mushroom cam	665 – 1035	6-37114-00-0-8
	3	3	6	3		1036 – 2100	
	4	8	8	4		2101 – 2800	

Excenter pin

Item	Pattern				Description	SH [mm]	Order number
	A	C	K	G			
7	2	4	4	2	ALU-JET 10 locking cam	665 – 1035	6-37111-08-0-8
	3	6	6	3		1036 – 2100	
	4	4	8	4		2101 – 2800	
	A	C	K	G		SW [mm]	Order number
	4	8	8	4		500 – 980	6-37111-08-0-8
	6	12	12	6		980 – 1700	

Connecting rod

Item	Pattern				Description	Length [mm]	Order number
	A	C	K	G			
8	[1]	[1]	[1]	[1]	Connecting rod	6000	P-01975-60-0-1

[1] The length of the connecting rod depends on the size of the element

Hardware set

Aluminium



kg
max. 200

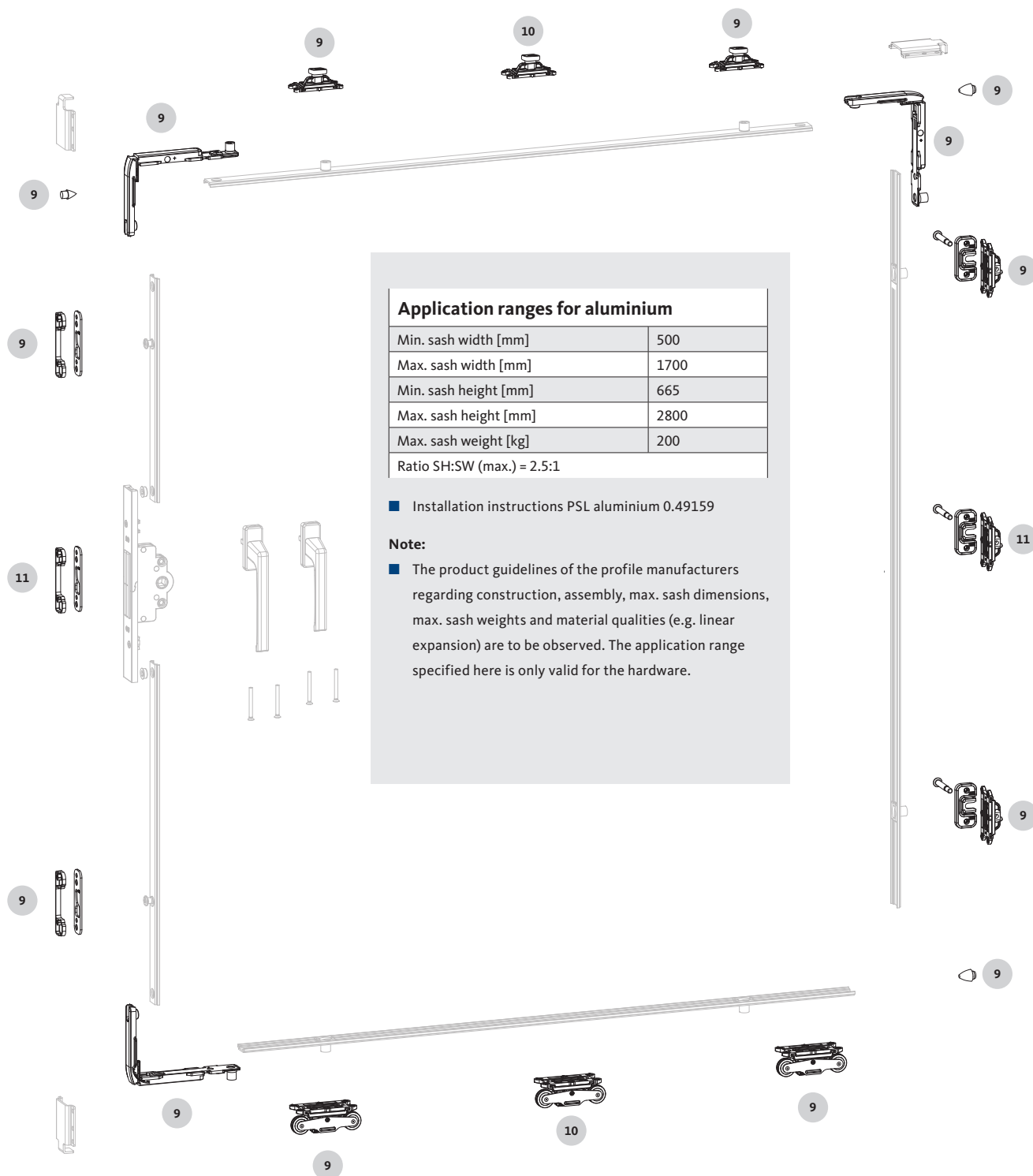

Application ranges for aluminium

Min. sash width [mm]	500
Max. sash width [mm]	1700
Min. sash height [mm]	665
Max. sash height [mm]	2800
Max. sash weight [kg]	200
Ratio SH:SW (max.)	= 2.5:1

■ Installation instructions PSL aluminium 0.49159

Note:

■ The product guidelines of the profile manufacturers regarding construction, assembly, max. sash dimensions, max. sash weights and material qualities (e.g. linear expansion) are to be observed. The application range specified here is only valid for the hardware.



PSL basic set + corner-drive

Item	Pattern				Description	SW [mm]	SH [mm]	DIN	Order number
	A	C	K	G					
9	1	2	2	1	PSL basic set + corner-drive	500 - 1700	665 - 2800	left	K-20378-00-L-1
								right	K-20378-00-R-1

Contains: PSL bogie, PSL guide unit, PSL pressure unit MS, striker GS, PSL centre lock, rubber buffer RS, rubber buffer GS, cover cap, ALU-JET 10 corner-drive, spacing bush

Set PSL supplement SW

Item	Pattern				Description	SW [mm]	SH [mm]	DIN	Order number
	A	C	K	G					
10	1	2	2	1	Set PSL supplement SW	from > 980	665 - 2800	left	K-20378-10-L-1
								right	K-20378-10-R-1

Contains: PSL bogie, PSL guide unit, cover cap, spacing bush

Set PSL supplement SH

Item	Pattern				Description	SW [mm]	SH [mm]	DIN	Order number
	A	C	K	G					
11	1	2	2	1	Set PSL supplement SH	500 - 1700	1035 - 2100	left	K-20378-20-L-1
								right	K-20378-20-R-1
	2	4	4	2			2101 - 2800	left	K-20378-20-L-1
								right	K-20378-20-R-1

Contains: PSL pressure unit MS, striker GS, PSL centre lock, spacing bush

Hardware set

Aluminium



kg
max. 200

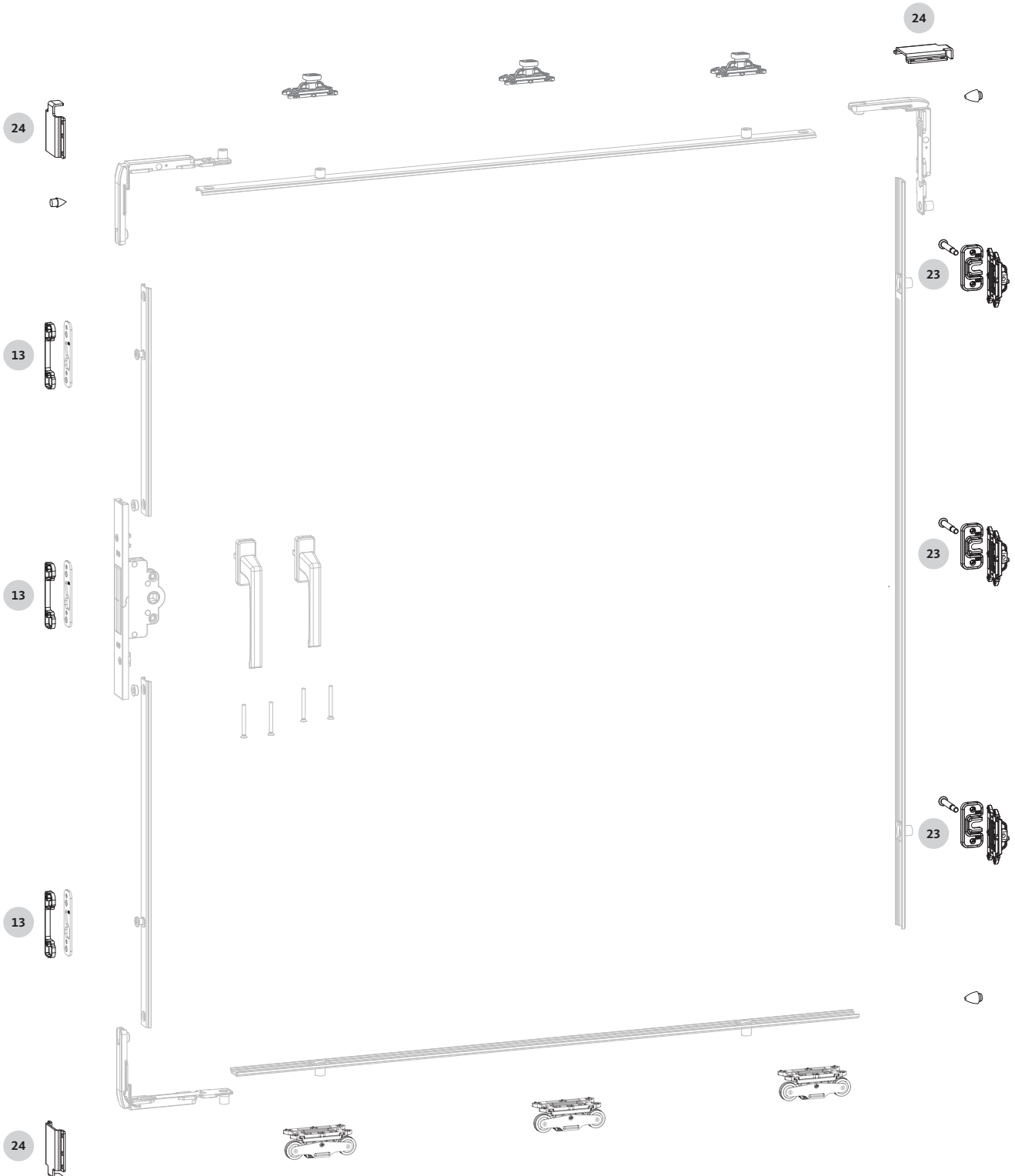



PSL frame cam MS L = 69 mm

Item	Pattern				Description	SH [mm]	Order number
	A	C	K	G			
23	2	4	4	2	Frame cam	up to 1034 mm	K-20380-00-0-8
	3	6	6	3		1035 mm – 2100 mm	
	4	8	8	4		>2100 mm	

PSL frame cam MS L = 64 mm

Item	Pattern				Description	SH [mm]	Order number
	A	C	K	G			
23	2	4	4	2	Frame cam	up to 1034 mm	K-20381-00-0-8
	3	6	6	3		1035 mm – 2100 mm	
	4	8	8	4		>2100 mm	

PSL frame cam MS L = 79 mm

Item	Pattern				Description	SH [mm]	Order number
	A	C	K	G			
23	2	4	4	2	Frame cam	up to 1034 mm	K-20382-00-0-8
	3	6	6	3		1035 mm – 2100 mm	
	4	8	8	4		>2100 mm	

Set of PSL mouldings, depending on profile

Item	Pattern				Description	SH [mm]	Order number
	A	C	K	G			
13	2	2	4	2	Moulding	665 – 1035	K-20651-00-0-1
	3	3	6	3		1036 – 2100	
	4	4	8	4		> 2101	

Set of PSL retaining brackets, depending on profile

Item	Pattern				Description	Width [mm]	Height [mm]	Order number
	A	C	K	G				
24	1	2	2	1	Retaining bracket	43	6	K-20802-00-0-1
						50	13.5	K-20802-01-0-1



Set PSL threshold, timber

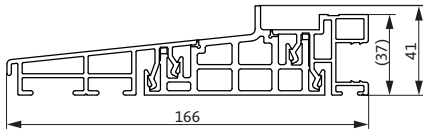

Versions/order numbers

Designation	Length [mm]	Finish	PU	Order number
PSL threshold base profile	560 – 3000	EV 1 / light grey	1	K-21014-30-0-1
	1411 – 4300	EV 1 / light grey	1	K-21014-43-0-1

Contains: 1 x threshold, 1 x roller track, 1 x guide track, 1 x step protection profile

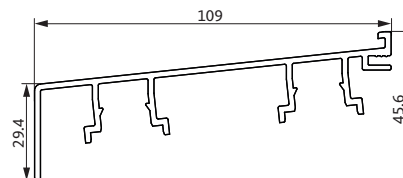
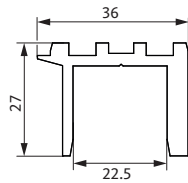
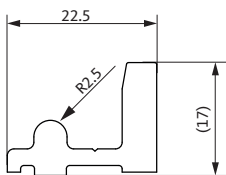

Set PSL threshold, timber-aluminium

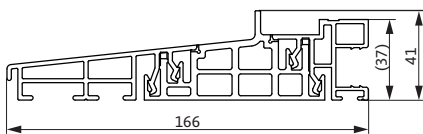

Versions/order numbers

Designation	Length [mm]	Finish	PU	Order number
PSL threshold base profile	560 – 3000	EV 1 / light grey	1	K-21015-30-0-1
	1411 – 4300	EV 1 / light grey	1	K-21015-43-0-1

Contains: 1 x threshold, 1 x roller track, 1 x guide track, 1 x step protection profile

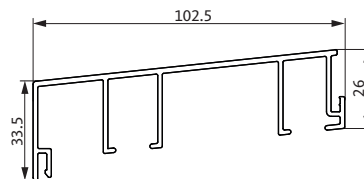
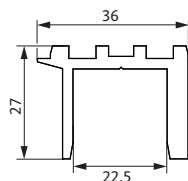
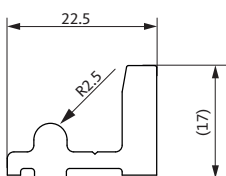



Set of PSL gaskets, timber

Versions/order numbers

Designation	Surface	PU	Order number
Set of PSL gaskets, timber	EV 1 / light grey	1	K-21018-30-0-6

Contains: 2 x sash gasket, 1 x meeting stile gasket, 1 x frame and meeting stile gasket

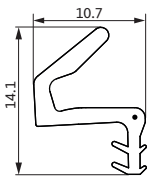

1st sealing level, circumferential on the frame 2nd sealing level on the meeting stile perpendicular to the sash

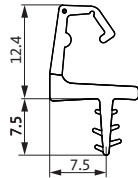

2nd sealing level, on the sash on the gear side + horizontally at the bottom

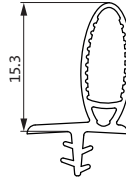

on the sash perpendicular to the meeting stile

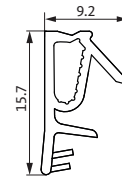

3rd sealing level, on the sash on the gear side + horizontally at the bottom/top

Set of PSL gaskets, timber-aluminium

Versions/order numbers

Designation	Surface	PU	Order number
Set of PSL gaskets, timber-aluminium	EV 1 / light grey	1	K-21019-30-0-6

Contains: 2 x sash gasket, 2 x meeting stile gasket, 1 x frame gasket

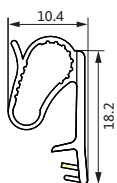

1st sealing level, circumferential on the frame

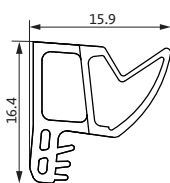

2nd sealing level on the meeting stile perpendicular to the sash

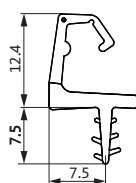

2nd sealing level, on the sash on the gear side + horizontally at the bottom/top

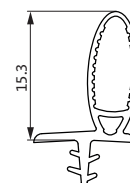

on the sash perpendicular to the meeting stile,

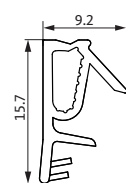

3rd sealing level, on the sash on the gear side + horizontally at the bottom/top

Gasket pad / fastening clip



Set of PSL gasket pads & fastening clips

Versions/order numbers

Designation	Surface	PU	Order number
Set of PSL gasket pads & fastening clips	-	1	K-21016-43-0-6

Contains: 20 x PSL fastening clip, 1 x gasket pad for bottom of the sash, 1 x gasket pad for top of the sash, 1 x gasket pad for bottom of the meeting stile, 1 x gasket plate for centre mullion, 1 x gasket plate for gear side, 1 x gasket plate for fixed-glazed sash, 20 x gasket plate for fastening clip

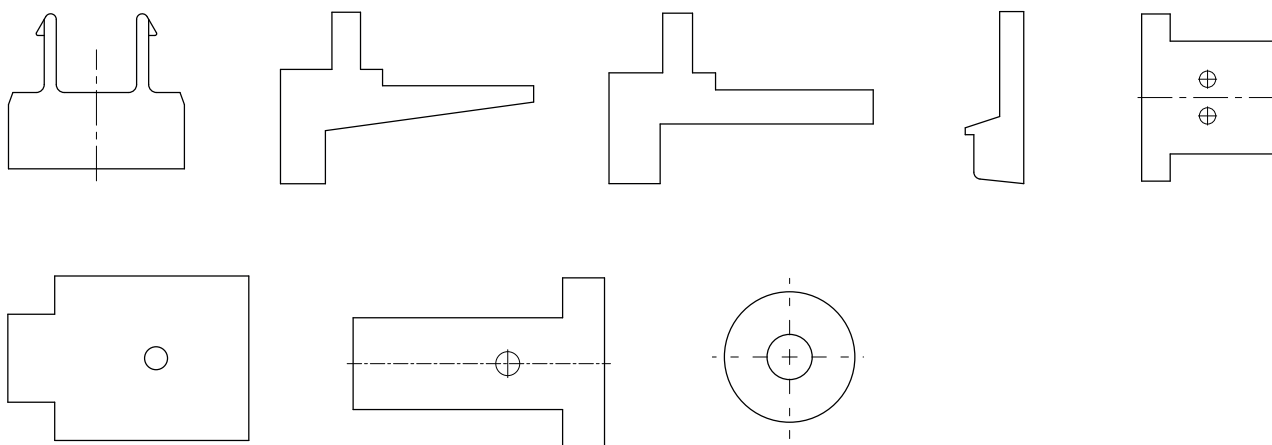

Set of PSL gasket pads

Versions/order numbers

Designation	Surface	PU	Order number
Set of PSL gasket pads	-	1	K-21017-01-0-6

Contains: 1 x gasket pad for bottom of the meeting stile, 1 x gasket pad for top of the meeting stile 1 x gasket pad for bottom of the sash, 1 x gasket pad for the aluminium casing, 1 x gasket pad for top of the sash, 1 x gasket plate for gear side, 1 x gasket plate for fixed-glazed sash, 1 x gasket plate for centre mullion, 20 x gasket plate for fastening clip

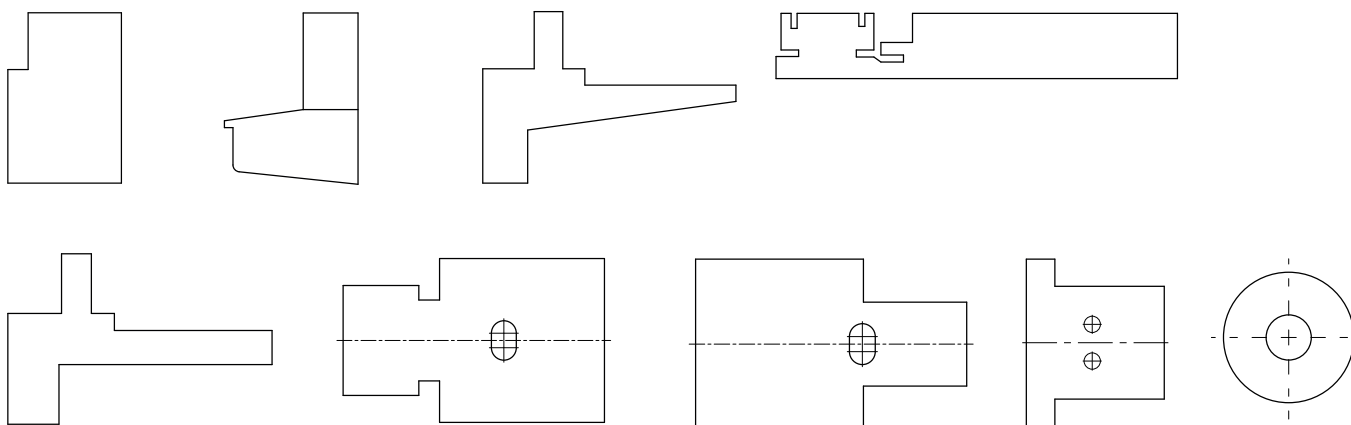

Turn handles

Installation of flush pull

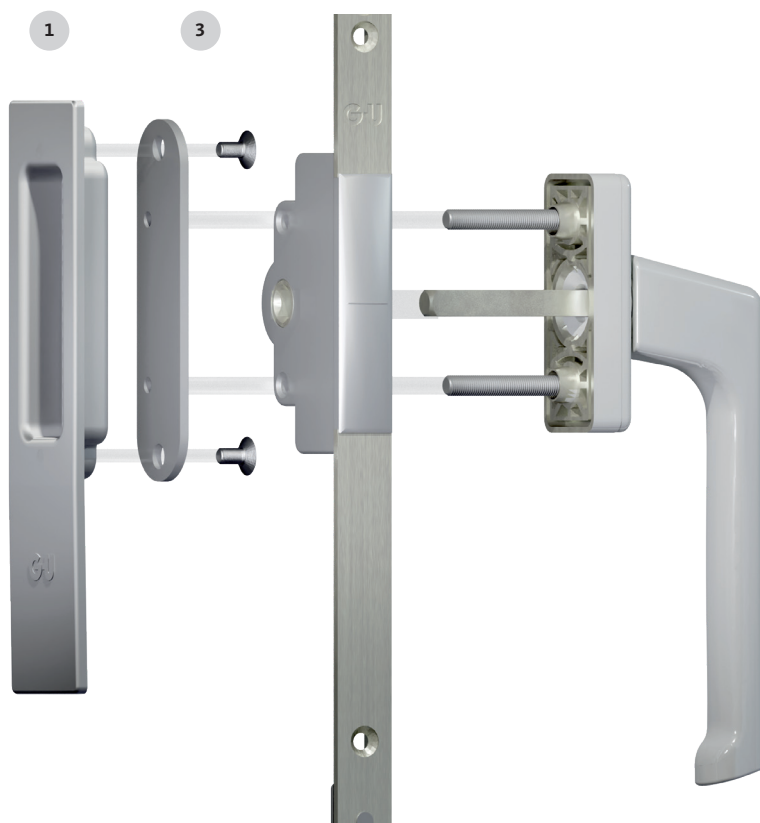

L&S flush pull, aluminium

Item	Pattern			Designation	GU logo	Installation depth	Specifications	Surface	Piece(s)	Order number
	A	C	K							
1	1	-	2	L&S flush pull MS, square	Yes	10 mm	without lugs	Silver/EV 1 look	1	9-29992-02-0-1
								Dark brown [1]	1	9-29992-02-0-5
								White, RAL 9016	1	9-29992-02-0-7
				L&S flush pull MS, square	Yes	10 mm	without lugs	Silver/EV 1 look	1	9-29992-01-0-1
								Dark brown [1]	1	9-29992-01-0-5
								White, RAL 9016	1	9-29992-01-0-7
				L&S flush pull, square	Yes	14 mm	without lugs	Silver/EV 1 look	1	9-29526-00-0-1
								Dark brown [1]	1	9-29526-00-0-5
								White, RAL 9016	1	9-29526-00-0-7

[1] Similar to RAL 8022

Flush pull adapter set

Item	Pattern			Description	Surface	Piece(s)	Order number
	A	C	K				
3	1	-	2	Flush pull adapter set	ferGUard	1	K-20866-00-0-1

Contains: 1 x flush pull adapter, 2 x countersunk screws

Use in combination with flush pulls in product group F, Lift&Slide hardware. Example: 9-29992-01-0-7

A Tilt&Slide handle with 43 hole spacing can be attached to the inside, and a flush pull with 80 mm hole spacing can be attached to the outside of the adapter.

Turn handles

TENUTO

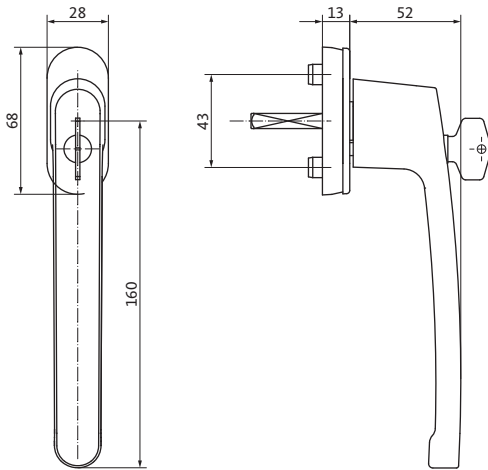

Turn handle TENUTO HL F/Z

Versions/Order numbers

Square spindle [mm]	Colour	PU	Order number
Lockable version 100 Nm			
35	EV1 silver	20	H-01946-35-0-1
	Brown	20	H-01946-35-0-5
	Black	20	H-01946-35-0-6
	Traffic white	20	H-01946-35-0-7
	Anthracite grey	20	H-01946-35-0-DP
40	EV1 silver	20	H-01946-40-0-1
	Brown	20	H-01946-40-0-5
	Black	20	H-01946-40-0-6
	Traffic white	20	H-01946-40-0-7
	Anthracite grey	20	H-01946-40-0-DP
45	EV1 silver	20	H-01946-45-0-1
	Brown	20	H-01946-45-0-5
	Black	20	H-01946-45-0-6
	Traffic white	20	H-01946-45-0-7
	Anthracite grey	20	H-01946-45-0-DP

without fixing screws

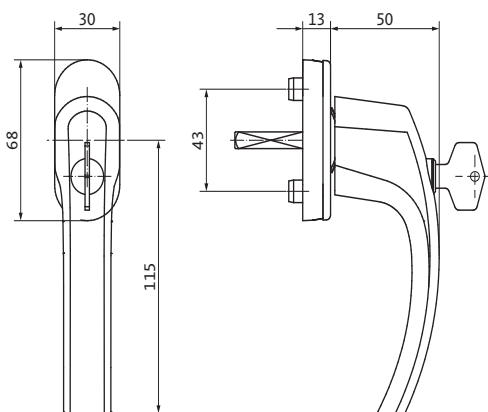

Turn handle TENUTO F/Z 200 Nm

Versions/Order numbers

Square spindle [mm]	Colour	PU	Order number
Lockable version 200 Nm			
35	EV1 silver	20	H-01945-35-0-1
	Brown	20	H-01945-35-0-5
	Black	20	H-01945-35-0-6
	Traffic white	20	H-01945-35-0-7
	Anthracite grey	20	H-01945-35-0-DP
40	EV1 silver	20	H-01945-40-0-1
	Brown	20	H-01945-40-0-5
	Black	20	H-01945-40-0-6
	Traffic white	20	H-01945-40-0-7
	Anthracite grey	20	H-01945-40-0-DP
45	EV1 silver	20	H-01945-45-0-1
	Brown	20	H-01945-45-0-5
	Black	20	H-01945-45-0-6
	Traffic white	20	H-01945-45-0-7
	Anthracite grey	20	H-01945-45-0-DP

without fixing screws



■ Tested according to DIN 18267 for resistance to twist-off and forced removal attempts at 200 Nm

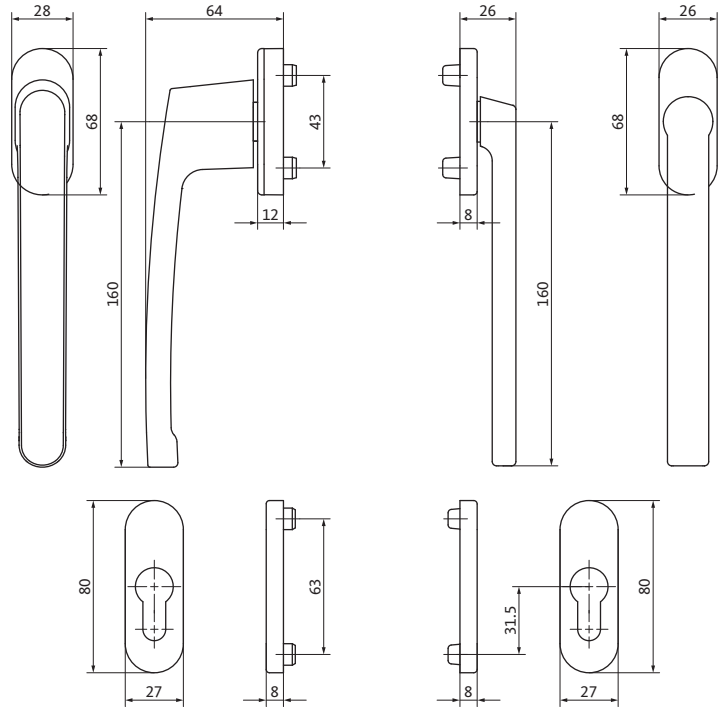

Turn handle TENUTO HL PZ

Versions/Order numbers

Designation	Material	lockable	Finish*	PU	Order number
Interior/exterior turn handle set TENUTO HL PZ	Aluminium	with PC hole	EV1 silver	20	H-01947-00-0-1
			Brown	20	H-01947-00-0-5
			Black	20	H-01947-00-0-6
			Traffic white	20	H-01947-00-0-7
			Anthracite grey	20	H-01947-00-0-DP

without fixing screws



Drilling jigs

PSL

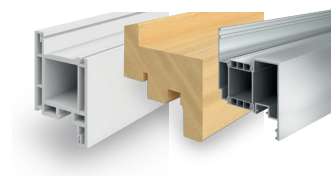

PSL drilling jigs

PVC drilling jigs

Description	Order number
Set of PSL drilling jigs, PVC	K-20419-00-0-0
Contains: 1 x PSL drilling jig, 1 x PSL drilling jig for gear side, 1 x PSL drilling jig for centre lock	

Timber/aluminium drilling jigs

Description	Order number
Set of PSL drilling jigs, timber/aluminium	K-20421-00-0-0
Contains: 1 x PSL drilling jig, 1 x PSL drilling jig for gear side, 1 x PSL drilling jig for centre lock	

Aluminium drilling jigs

Description	Order number
Set of PSL drilling jigs, aluminium	K-20420-00-0-0
Contains: 1 x PSL drilling jig, 1 x PSL drilling jig for gear side, 1 x PSL drilling jig for centre lock	



PSL drilling jigs for threshold

Drilling jigs, timber

Description	Order number
Set of PSL drilling jigs, timber	K-21141-01-0-0
Contains: 1 x PSL drilling jig, 1 x PSL drilling jig for centre mullion, 1 x PSL drilling jig for clip	

Drilling jigs, timber/aluminium

Description	Order number
Set of PSL drilling jigs, timber/aluminium	K-21142-01-0-0
Contains: 1 x PSL drilling jig, 1 x PSL drilling jig for centre mullion, 1 x PSL drilling jig for clip	





Indicative character of technical information, exclusion of liability

The technical documents are general information based on our experience and tests and therefore do not take any specific application into account. They are intended as general information and for initial orientation only, and must not be used as the decision-making basis. They reflect the version of the catalogue at the time of going to press. Although we have made every attempt to ensure the information provided here is accurate, it is non-binding. It should be adapted to the respective construction projects, usage and specific on-site demands. Due to further developments, and also to take current developments into account and exclude printing errors or other oversights or omissions, you can find the respective latest version of the binding technical documents at www.g-u.com. Be sure to use the latest edition of our technical documents.

The product images shown in the publication may differ from the actual product, particularly as a result of technical improvements. We would also like to draw your attention to the current information at the website mentioned above.

Copyright notice

© All illustrations and texts in this publication are protected by copyright. Unless otherwise stated in the image credits, the rights belong to the Gretsch-Unitas group. Any use of copyright protected materials without the consent of the holder of the rights is prohibited.

Publisher
Gretsch-Unitas GmbH
Baubeschläge
Johann-Maus-Sr. 3
71254 Ditzingen, Germany
Phone +49 7156 301-0
Fax +49 7156 301-293
www.g-u.com



WINDOW TECHNOLOGY
DOOR TECHNOLOGY
AUTOMATIC ENTRANCE SYSTEMS
BUILDING MANAGEMENT SYSTEMS

Gretsch-Unitas GmbH
Baubeschläge
Johann-Maus-Str. 3
71254 Ditzingen
Germany
Tel. +49 7156 301-0
Fax +49 7156 301-77980

BKS GmbH
Heidestr. 71
42549 Velbert
Germany
Tel. +49 2051 201-0
Fax +49 2051 201-9733

Gretsch-Unitas AG
Industriestr. 12
3422 Rüdtilgen
Switzerland
Tel. +41 34 44845-45
Fax +41 34 44562-49

GU Baubeschläge Austria GmbH
Mayrwiesstr. 8
5300 Hallwang
Austria
Tel. +43 662 664830
Fax +43 662 664830-301

www.g-u.com

