



© AI Generated

## WINDOW TECHNOLOGY – LIFT&SLIDE HARDWARE

### L&S structural connection profile

The structural connection for GU-thermostep 204

#### L&S structural connection profile and GU-thermostep 204 – perfectly combined

The L&S structural connection profile was specially developed for the GU-thermostep 204 and ensures **optimised structural connection to the building**. The systems are perfectly harmonised and allow the installation to be carried out flexibly and efficiently with ease of workability. They satisfy the most stringent requirements in terms of safety and standards. To ensure reliable sealing and lasting protection, the tightness has been tested according to the exacting requirements of the ift-directive MO-01/1.



#### L&S structural connection profile – optimised for your construction site

Designed for a permanently secure sealing and easy installation without additional screw connections – **saving you time and effort.**

## Structure in accordance with water tightness testing

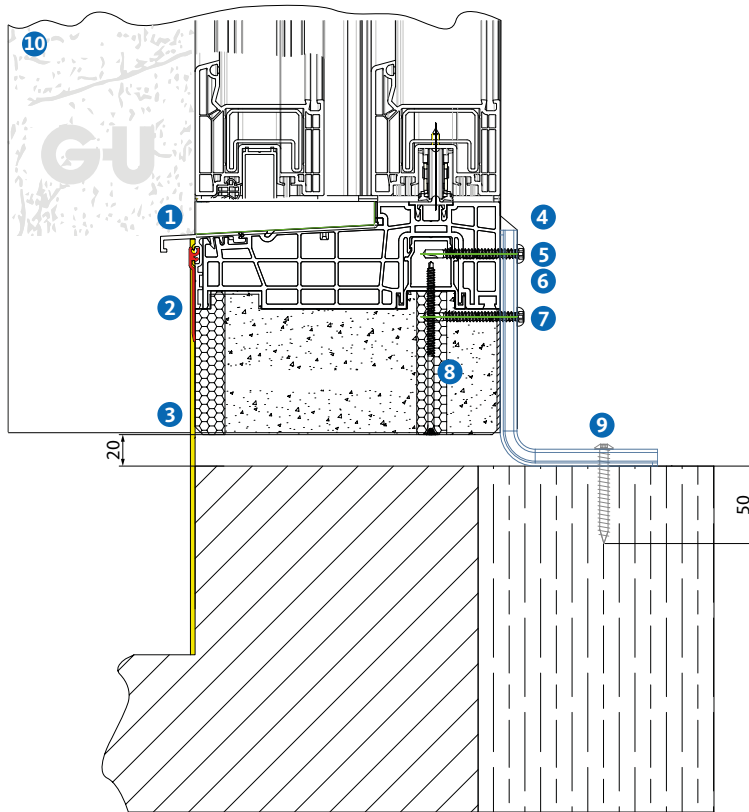

- 1 Maximum planned water accumulation height
- 2 L&S structural connection profile 2, 6-41316-99
- 3 FPD + nonwoven-backed joint tape
- 4 GU window sealing tape Vario, H-01968
- 5 GU mounting screw BE5, H-01844-60-0-1
- 6 GU fixing bracket ST, H-01879-15-0-1
- 7 GU mounting screw BE5, H-01844-60-0-1
- 8 GU coupling drilling screw BE3, H-01841-11-0-1
- 9 GU mounting screw BE4, H-01880 or BE14, H-02061
- 10 GU connecting flange

## The L&S structural connection profile



### Order information

Designation	Order number
L&S structural connection profile 0	6-41315-40-0-1
L&S structural connection profile 0	6-41315-67-0-1
L&S structural connection profile 2	6-41316-40-0-1
L&S structural connection profile 2	6-41316-67-0-1
L&S structural connection profile 8	6-41317-40-0-1
L&S structural connection profile 8	6-41317-67-0-1
Mounting tools L&S structural connection profile 0/2	6-41381-00-0-6
Assembly wedge L&S structural connection profile 0	6-41387-01-0-6
Assembly wedge L&S structural connection profile 2	6-41387-02-0-6
Expanded sponge rubber cord Ø4mm, black	H-02073-00-0-6