



WINDOW TECHNOLOGY
DOOR TECHNOLOGY
AUTOMATIC ENTRANCE SYSTEMS
BUILDING MANAGEMENT SYSTEMS



LATEST PRODUCT INFORMATION FOR FABRICATORS

4

Tension spring for Lift&Slide gear and handle damper

Securing technology for you



Very simple but childproof operation

More convenience due to reduced operating forces,
more security in case of heavy sashes



Tension spring

The use of tension springs in the Lift&Slide gear lock reduces the operating force needed by the user at the turn handle, greatly increasing operating convenience. The result is extremely easy operation of the Lift&Slide door, especially for high sash weights of up to 400 kg. If, for example, the door weight increases due to new glazing during a renovation, the operational forces also increase at the turn handle. The tension spring compensates for this increased force. Retrofitted installation of the tension spring is also possible at any time in every Lift&Slide gear version and is normally recommended starting at door weights above 200 kg.

The tension spring for Lift&Slide gears is a result of many years of experience at Gretsche-Unitas in the area of Lift&Slide hardware.

Handle damper

The use of the handle damper in the Lift&Slide gear improves the operating safety, particularly with large and heavy elements. Furthermore it provides controlled sash-lowering without rebound of the handle as well as a controlled rotary movement of the handle.

We recommend the handle damper for Lift&Slide gears with sash weights as from 100 kg. It can also be retrofitted quickly and easily in every standard gear and it can also be installed in connection with the tension spring – to form a strong combination that is only offered in this form by Gretsche-Unitas.

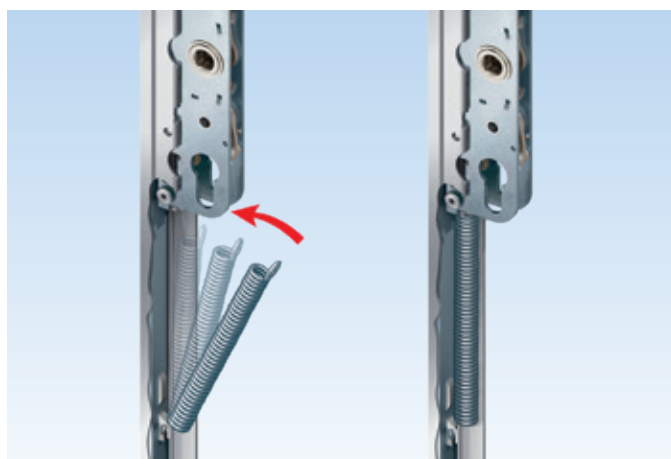

Versions/order numbers

| Description | From sash weight [kg] | PU | Order no. |
|----------------|-----------------------|----|----------------|
| Tension spring | 200 | 1 | 9-40235-05-0-0 |

Versions/order numbers

| Description | From sash weight [kg] | PU | Order no. |
|---------------|-----------------------|----|----------------|
| Handle damper | 100 | 1 | K-19053-00-0-6 |

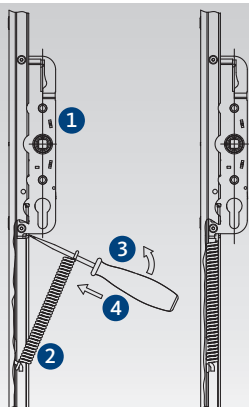

Installation of the tension spring for facilitated handle operation
for sash weight > 200 kg

- 1 Put Lift&Slide gear in unlocked position.
- 2 Hook spring art. no. 9-40235-05-0-0 into the connecting rod.
- 3 Tension by means of slot screwdriver size 1.
- 4 Slide onto the hook on the lock case.