

GU-SECURITY multi-point lock range			
Item	Description	Order no.	Remark
2 additional locking points			
1A	Multi-point lock with 2 latchbolts GU-SECURITY Automatic prepared for A-Opener and prepared for safe-T-catch		
	Standard version L = 1750	Top locking point 730	Bottom locking point 760
2A	Multi-point lock with 2 massive bolts GU-SECURITY MR2 prepared for safe-T-catch		
	Standard version L = 1750	Top locking point 730	Bottom locking point 760
2B	Multi-point lock with 2 hook bolts GU-SECURITY SH2		
	Standard version L = 1750	Top locking point 730	Bottom locking point 760
3 additional locking points			
1F	Multi-point lock with 3 latchbolts GU-SECURITY Automatic3 prepared for A-Opener and prepared for safe-T-catch		
	Standard version L = 1750	Top locking point 730	Bottom locking point 250 / 760
4 additional locking points			
2F	Multi-point lock with 4 massive bolts GU-SECURITY MR4		
	Standard version L = 1750	Top locking point 300 / 730	Bottom locking point 250 / 760
2G	Multi-point lock with 4 hook bolts GU-SECURITY SH4		
	Standard version L = 1750	Top locking point 300 / 730	Bottom locking point 250 / 760
2 additional locking points			
1B	Multi-point lock with 2 double latchbolts GU-SECURITY Automatic4 and prepared for safe-T-catch		
	Standard version L = 1750	Top locking point 730	Bottom locking point 730
1L	Multi-point lock with 2 Automatic DR bolts Automatic DR bolt prepared for A-opener and prepared for safe-T-catch		
	Standard version L = 1750	Top locking point 730	Bottom locking point 760
2C	Multi-point lock with 2 double bolts GU-SECURITY DR and prepared for safe-T-catch		
	Standard version L = 1750	Top locking point 730	Bottom locking point 760
3 additional locking points			
1G	Multi-point lock with 3 double latchbolts GU-SECURITY Automatic6 prepared for A-opener and prepared for safe-T-catch		
	Standard version L = 1750	Top locking point 730	Bottom locking point 250 / 760
See the order catalogue for further locking positions.			

Flat faceplate = 16, 20, 24
U-faceplate = 24 x 6, 24 x 8
Backset BS = 35, 40, 45, 55
Hole distance HD = 92 (PC)
Hole distance HD = 94 (RC)
Follower □ 8

See to order catalogue.

Lever-operated shoot-bolt lock

Item	Description	Order no.	Remark
20B	Passive-leaf control lock B1895	B 1895 00XX	
23	Lever-operated shoot-bolt lock	B 1899 0331	
27	Guide plate for vertical rod B9019	B 9019 0001	
29A	Floor striker B-0028	B-00280-20	
29B	Floor striker B 9009	B 9009 0001	
30A	Solid vertical rod	Rod length	
		437	B 9006 0001
		687	B 9006 0002
		937	B 9006 0003
		1187	B 9006 0004
		1487	B 9006 0005
		1987	B 9006 0006
		2487	B 9006 0007
		2987	B 9006 0008
		30B	B 9006 vertical rod
450	B 9006 0009		
700	B 9006 0010		
760	B 9006 0018		
1200	B 9006 0012		
1500	B 9006 0013		
2000	B 9006 0014		
2500	B 9006 0015		
3000	B 9006 0016		
34A	Striker for system threshold	6-39094-01	
47	Floor striker	K-19192-01	

Mortise locks			
Item	Description	Order no.	Remark
4A	GU-SECURITY Economy	6-34224-XX	Flat faceplate = 16, 20, 24 U-faceplate = 24 x 6, 24 x 8 Backset BS = 35, 40, 45, 55 Hole distance HD = 92 (PC) Hole distance HD = 94 (RC) Follower □ 8
			See to order catalogue. System solutions for narrow stile doors
13A	Multi-point lock BKS Series 13		Flat faceplate = 16 Backset BS = 35 Hole distance HD = 92 (PC) Hole distance HD = 94 (RC) Follower □ 8 □ 9
14G	Panic door lock BKS Series 18		

SECURITY accessories

Item	Description	Order no.	Remark
8.1A	L&D striker with interchangeable latch piece U24 x 6	6-37367-01	
8.1B	L&D striker with interchangeable latch piece w/o moulding U24 x 6	6-37367-02	
8.1C	L&D striker with interchangeable latch piece 24 x 3	6-37368-01	
8.1D#	L&D striker with interchangeable latch piece U24 x 6	6-37929-01	
9.1A	Automatic and MR striker with concealed adjustment U24 x 6	6-40032-AC	
9.1B	SH striker with concealed adjustment U24 x 6	6-40075-AC	
9.1C	Automatic4, DR and Automatic-DR striker with concealed adjustment U24 x 6	6-40007-AC	
9.1D	Automatic and MR striker with concealed adjustment 24 x 3	6-40032-AA	
9.1E	SH striker with concealed adjustment 24 x 3	6-40075-AA	
9.1F	Automatic4, DR and Automatic-DR striker with concealed adjustment 24 x 3	6-40007-AA	
10A	One-piece striker Automatic-DR 24 x 3	6-40520-AA	
10B	One-piece striker Automatic-DR 24 x 6	6-40520-AC	
10M	One-piece striker Automatic, MR oben 24 x 3	6-40218-AA	
10N	One-piece striker Automatic, MR unten 24 x 3	6-40198-AA	
10O	One-piece striker Automatic, MR oben U24 x 6	6-40218-AC	
10P	One-piece striker Automatic, MR unten U24 x 6	6-40198-AC	
10Q	One-piece striker SH oben U24 x 6	6-40254-AC	
10R	One-piece striker SH unten U24 x 6	6-40256-AC	
10S	One-piece striker Automatic-DR oben 24 x 3	6-40446-AA	
10T	One-piece striker Automatic-DR unten 24 x 3	6-40448-AA	
10U	One-piece striker Automatic-DR oben 24 x 6	6-40446-AC	
10V	One-piece striker Automatic-DR unten 24 x 6	6-40448-AC	
11A	Safe-T-catch striker (6 mm high according to profile)	6-29511-00	
11B	Safe-T-catch striker (8 mm high according to profile)	6-31632-00	
11C	Safe-T-catch striker (3 mm high according to profile)	6-29505-00	
12H	One-piece striker with safe-T-catch MR, Automatic oben U24 x 6	6-40223-AC	
12I	One-piece striker Automatic-DR oben für Sperrbügel 24 x 3	6-40447-AA	
51A	Striker with monitoring contact 24 x 3	6-40041-AA	
51B	Striker with monitoring contact U24 x 6	6-40041-AC	
51C	Striker with monitoring contact 24 x 3	6-40013-AA	
51D	Striker with monitoring contact U24 x 6	6-40013-AS	
58A	Deadbolt monitoring contact for deadbolt cutout	K-19068-00	
60	Safe-T-catch turn knob	B-70790-00-0-1	
	Safe-T-catch turn knob (stainless steel)	B-70790-00-0-3	
61	Drilling-jigs	6-29217-01	
62	Cover plate for latchbolt	9-40010-00	
63A	Deadbolt cover (Depth: 20)	9-48553-03	
64B	Deadbolt cover (Depth: 17)	9-50849-01	
65A	Electric strike ET 8	See to order catalogue.	
67	Hinge-side locking device, frame part	6-28961-XX	
68	Hinge-side locking device, leaf part	6-28985-XX	
75C	Cover	E-18819-00	
76A	A-opener kit (universal)	K-18153-01	
76B	A-opener kit servo (universal)	K-19020-01	
77	Cable link, detachable, concealed	See to order catalogue.	
78	Cable link for accessories		
79A	SECUREconnect 200 set	B-55600-20	
79B	SECUREconnect 50 set	B-55600-34	
83	House entrance door hinge GU A 312 3D	See to order catalogue.	
86	Hinge-side locking device, leaf part	6-34280-01	
87	Hinge-side locking device, frame part	6-36102-01	
88	SECUREconnect U-faceplate with moulding	See to order catalogue.	
89			
90	House entrance door hinge GU A 316 3D	See to order catalogue.	
100A	Extension with Automatic MR and SH Installation instructions	6-37394-XX 0-47332-L0	
101A	Extension with MR bolt Installation instructions	6-37395-XX 0-47332-L0	
102A	Extension with SH bolt Installation instructions	6-37396-XX 0-47332-L0	
103A	Extension with Automatic4, DR and Automatic-DR latchbolt Installation instructions	6-37397-XX 0-47332-L0	
104A	Top faceplate extension	9-48687-XX	
105A	Bottom faceplate extension	9-48686-XX	
110A	Extension with DR bolt Installation instructions	6-37398-XX 0-47332-L0	
134A	Safe-T-catch set 8 Installation instructions	K-20085-XX 0-48664-L0	
134B	Safe-T-catch set 11 Installation instructions	K-20086-XX 0-48664-L0	
135A	Extension with Automatic-DR Installation instructions	6-40488-XX 0-47332-L0	

Optional part

GU-SECURITY lever-operated gear								
Item	Description	Order no.	Remark					
31A	Alternatively Automatic lever-operated gear Also suitable for MR and SH bolts Axis 12 (U24 x 8)	1850-2110	580	1880	Top locking point 1020			
		2111-2250						
31B	Automatic3 lever-operated gear Axis 12 (U24 x 8)	2000-2260	730	2000	Shoot-bolt unit			
		2261-2400			130	270	520	770
		2185-2445			2	--	--	--
		2446-2585			1	1	--	--
31C	Automatic4 lever-operated gear Also suitable for DR and Automatic-DR bolts Axis 12 (U24 x 8)	2586-2835	915	2185	Shoot-bolt unit			
		2836-3085			130	270	520	770
		1850-2110			2	--	--	--
		2111-2250			1	1	--	--
		2000-2260			2	--	--	--
31D	Automatic6 lever-operated gear Axis 12 (U24 x 8)	2261-2400	730	2000	Shoot-bolt unit			
		2185-2445			130	270	520	770
		2446-2585			2	--	--	--
		2586-2835			1	1	--	--
		2836-3085			1	--	1	--
32A	Shoot-bolt unit	Length = 130						
32B	Shoot-bolt unit	Length = 270						
32C	Shoot-bolt unit	Length = 520						
32D	Shoot-bolt unit	Length = 770						
32E	Shoot-bolt unit	Length = 160	Add 30 mm to sash rebate height!					
33A	Striker for lever-operated gear					6-38748-XX		
34A	Striker for system threshold					6-39094-01		
82	System threshold					See to order catalogue.		
111A	Extension with Automatic MR and SH	Length = 500				6-37596-XX		
112A	Extension with Automatic4, DR and Automatic-DR latchbolt	Length = 500				6-37597-XX		
111B	Extension with Automatic MR and SH	Length = 800				6-37598-XX		
112B	Extension with Automatic4, DR and Automatic-DR latchbolt	Length = 800				6-37599-XX		

The product guidelines of the profile manufacturer regarding construction, assembly, max. sash dimensions, max. sash weights and material qualities (e.g. linear profile expansion) are to be observed.

Attention!
The three-dimensional depictions of the hardware components are not true to scale.

For RC-tested elements, the additional locking elements and the lock case may have to be backfilled at the side and rear to absorb high forces. Depending on the profile system and material properties, the pressure-resistant backfill must be individually adapted.

For mounting and operating a SECURITY multi-point lock, the following advice must be observed:

- Installation according to GU drawing only.
- L&D striker and strikers must be exactly aligned with each other.
- The use of latch&deadbolt strikers with adjustable interchangeable latch piece is only permitted if adjustable strikers are used for the Automatic locking elements.
- If the interchangeable latch piece requires adjustment, the strikers must be justified accordingly.
- Ensure that the locking elements enter into the strikers freely.
- With the door open, it is possible to check the lock for proper functioning as follows:
-Release the locking elements by pushing the trigger lever in the locking direction:
→ The locking Elements will throw 20 mm.
-Now the locking elements must be secured against being pushed back (test by trying to do so).
-Do not forget to withdraw the locking Elements again using the lever handle (latch lever) after testing.
- Use appropriate securing devices to transport the door.

Attention!

For profile cylinders with 90° locking cam position: after the installation the cam must point to the hinge-side.
With the key removed, the locking cam position must comply with DIN 18252.

Reversing the latch:
GU-SECURITY manual-locking systems:
See adhesive label on lock case.
GU-SECURITY Automatic:
See adhesive label on central and additional lock case

AX = axis
V = lock position (depending on profile)

-Use fixing screws max. Ø 4.2 to install the GU-SECURITY multi-point lock.
-Use fixing screws max. Ø 4.5 to install GU-SECURITY accessories.
The responsibility for safe and durable hardware fastening lies with the door fabricator.

Sheet 2	Mortise locks
Sheet 3	SECURITY system technology, cylinder-operated, L = 1750
Sheet 4	SECURITY system technology, cylinder-operated, L = 1750
Sheet 5	Lever-operated gear
Sheet 6	Lever-operated shoot-bolt lock
Sheet 7	Sectional depiction of multi-point locks
Sheet 8	Sectional depiction of multi-point locks
Sheet 9	Accessories

XX Size depending on profile system, refer to GU order catalogue.

Installation of the monitoring contact K-19068 is possible.
Installation instructions: 0-49871-L0

Order list

Description:	GU-BKS door lock Neutral aluminium and narrow stile systems
Date	18.09.2019
Change No.	G36560
Sig	Ne
Ver.	--
Replacement for	
Revision	13
Iteration	20
Level	Released
Scale	1:1
Drawing No.	0-43777-L0-0-EN
Size	A1
Sheet	1/9

GU-SECURITY Economy

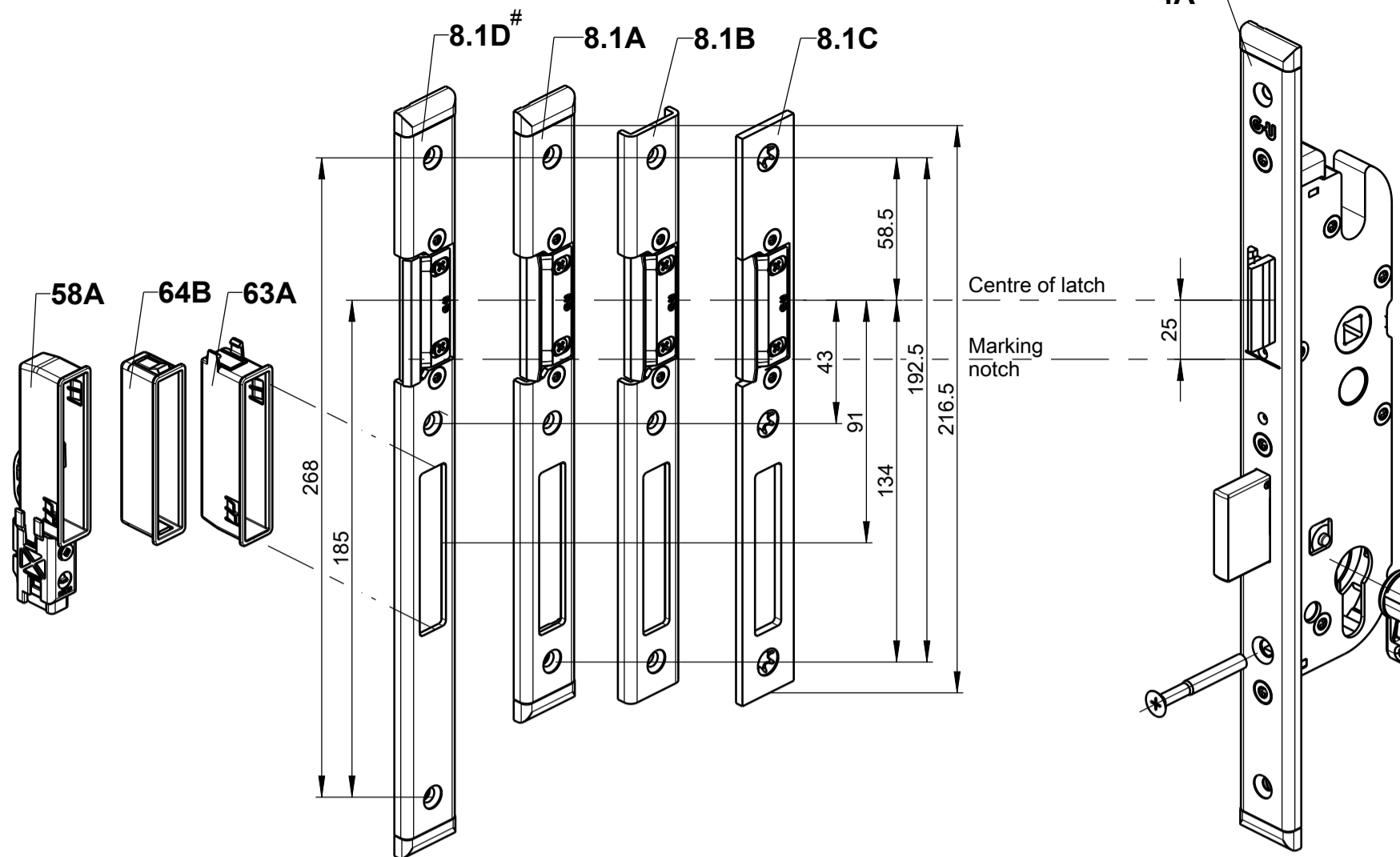

Frame milling for L&D striker

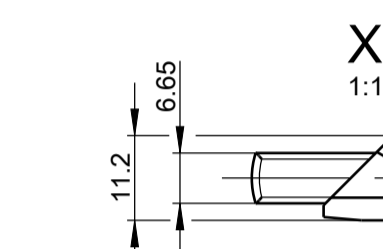
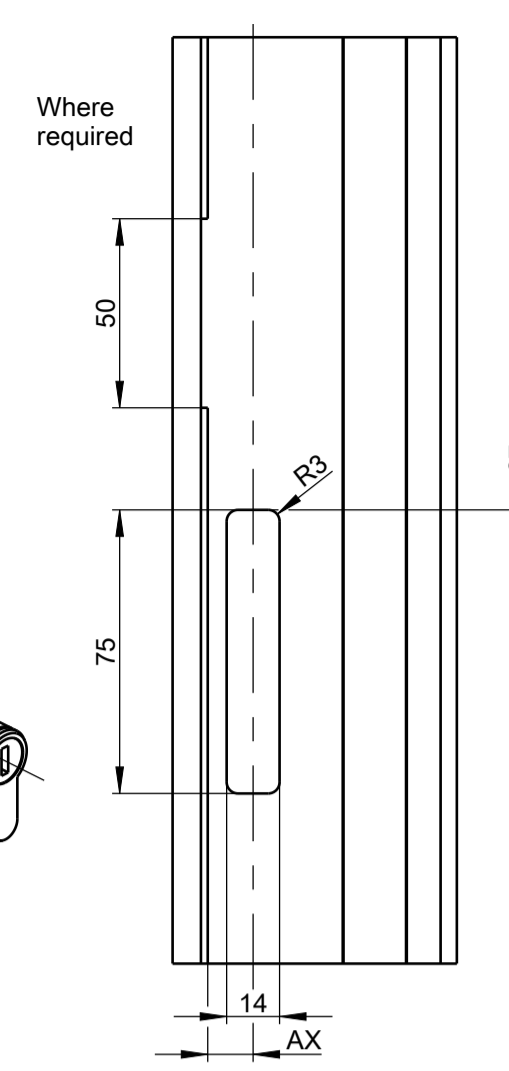

Frame milling for L&D striker

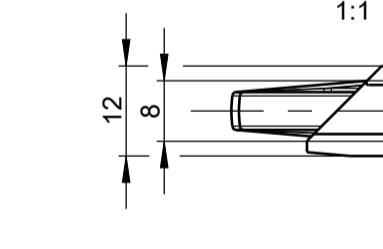
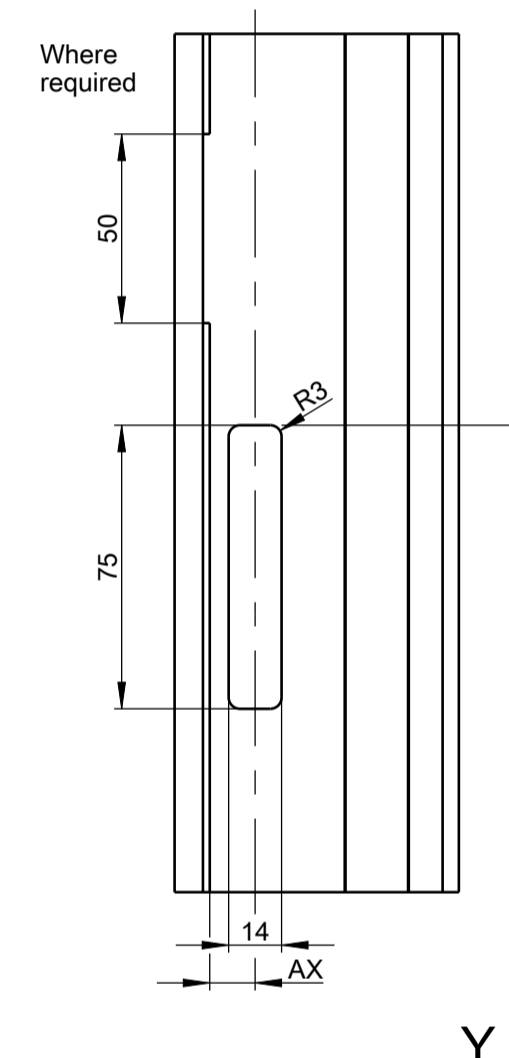

Frame milling for L&D striker

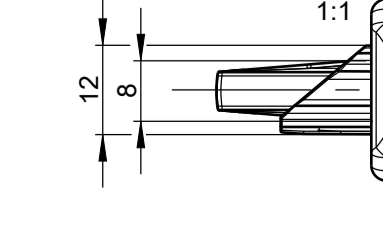
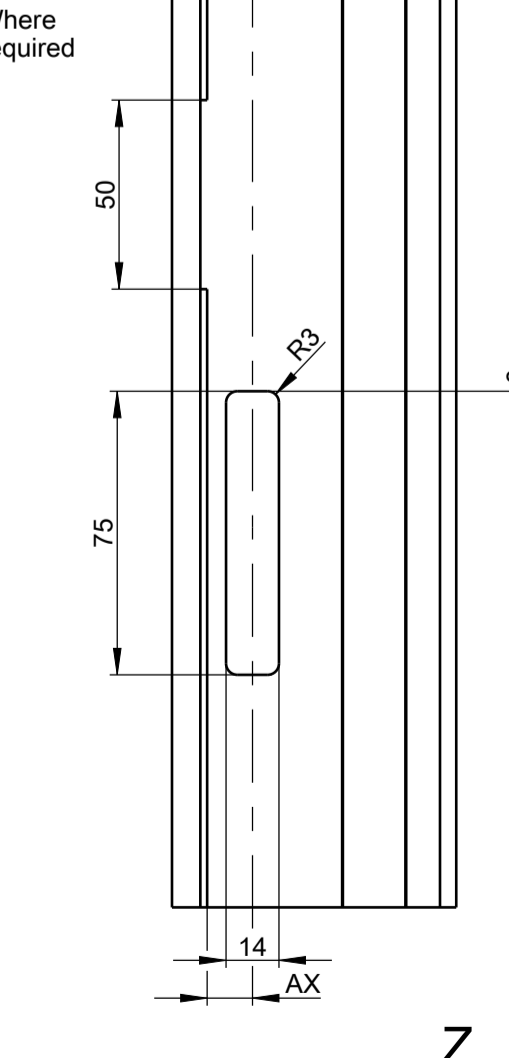

Frame milling for L&D striker

SECURITY Economy lock case with PC-hole

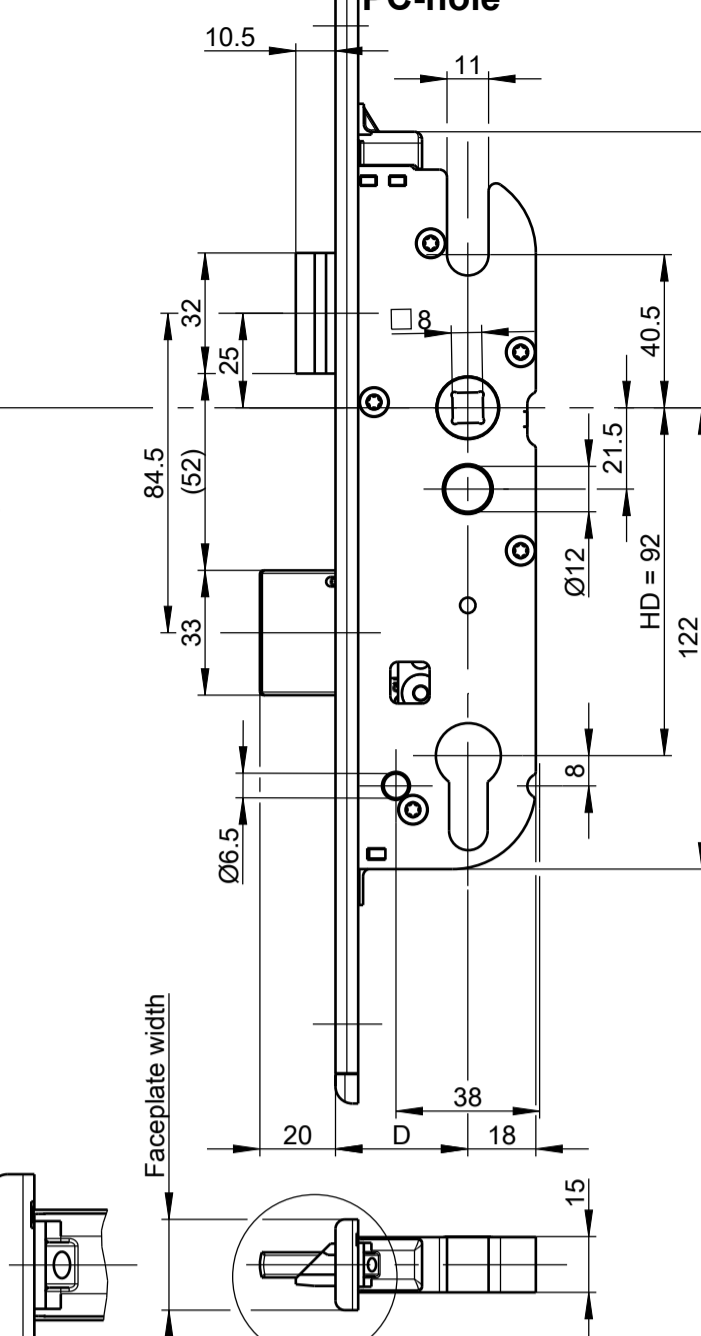

SECURITY Economy lock case with RC hole

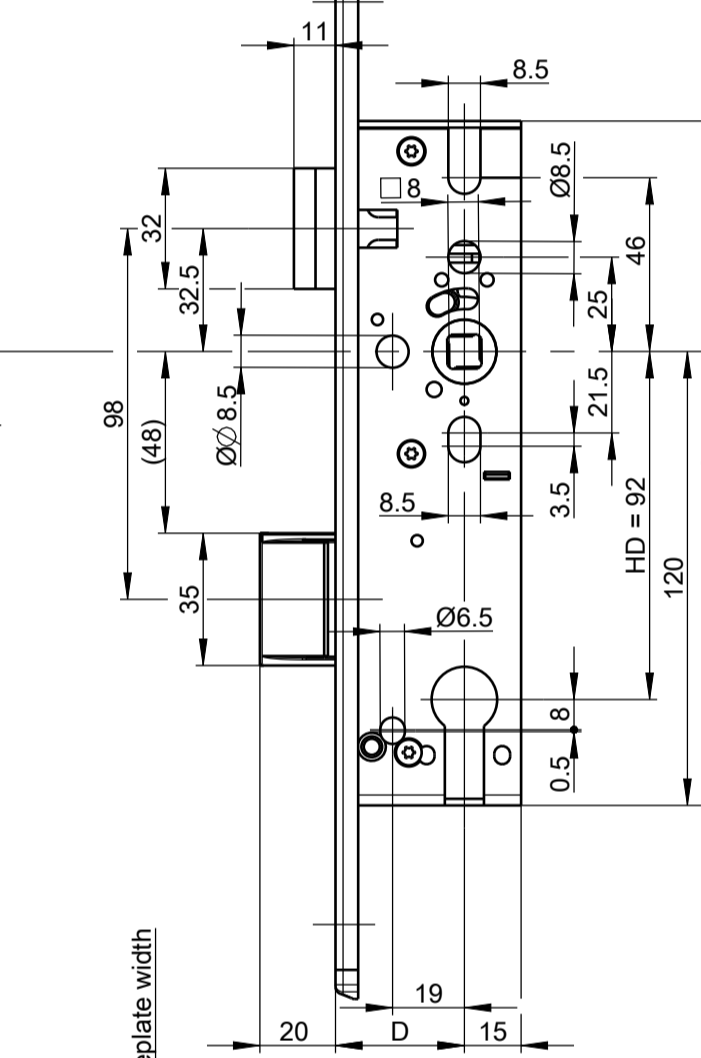

SECURITY Economy lock case with RC hole

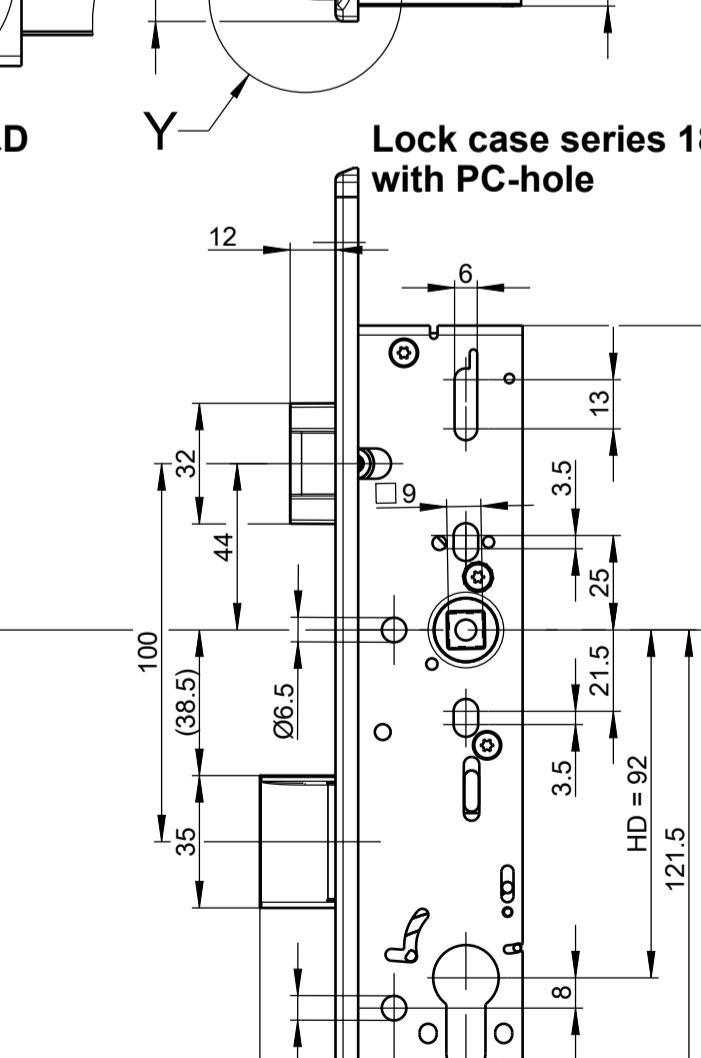

SECURITY Economy lock case with RC hole

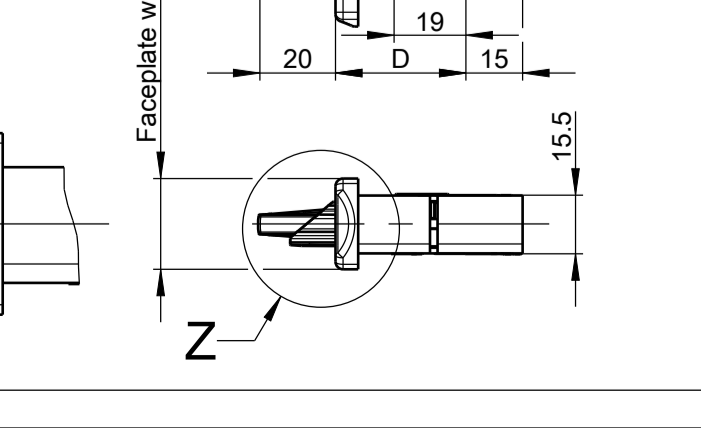

SECURITY Economy lock case with RC hole

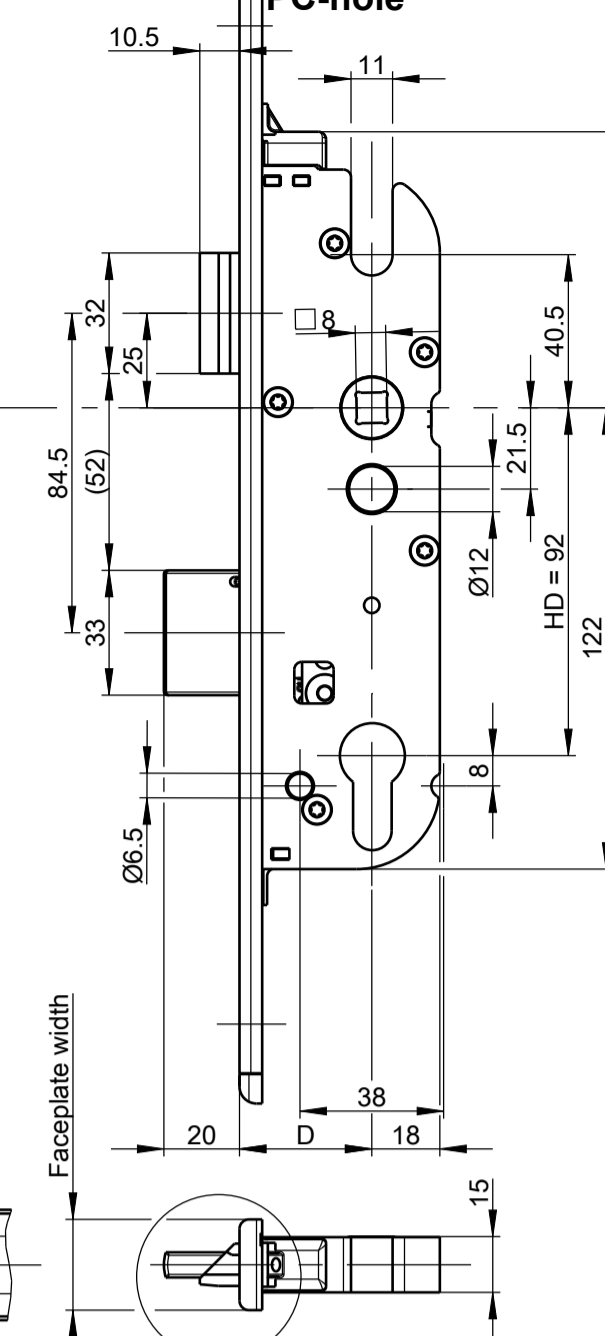

SECURITY Economy lock case with RC hole

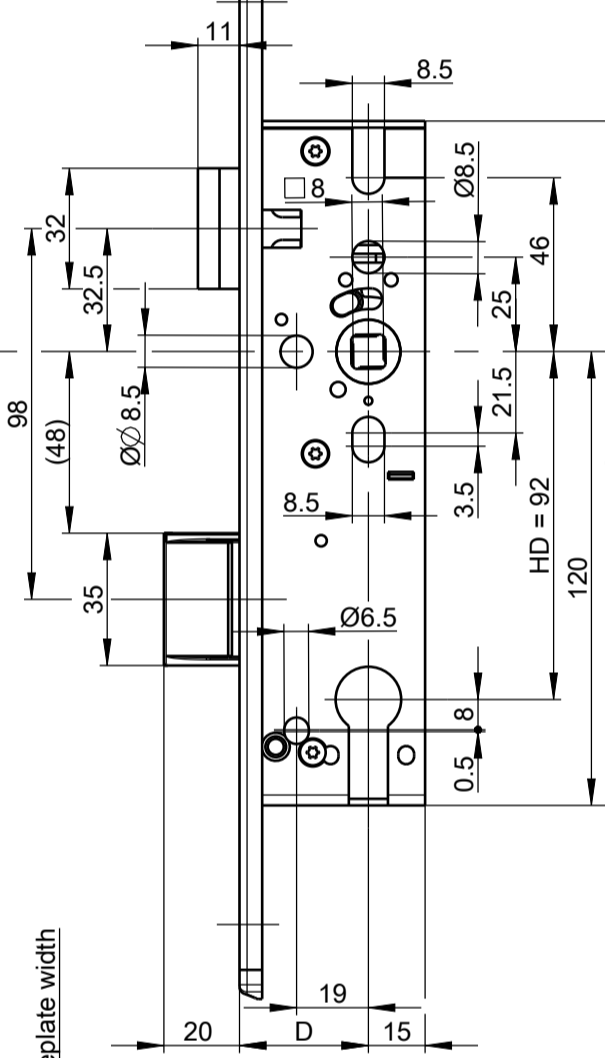

SECURITY Economy lock case with RC hole

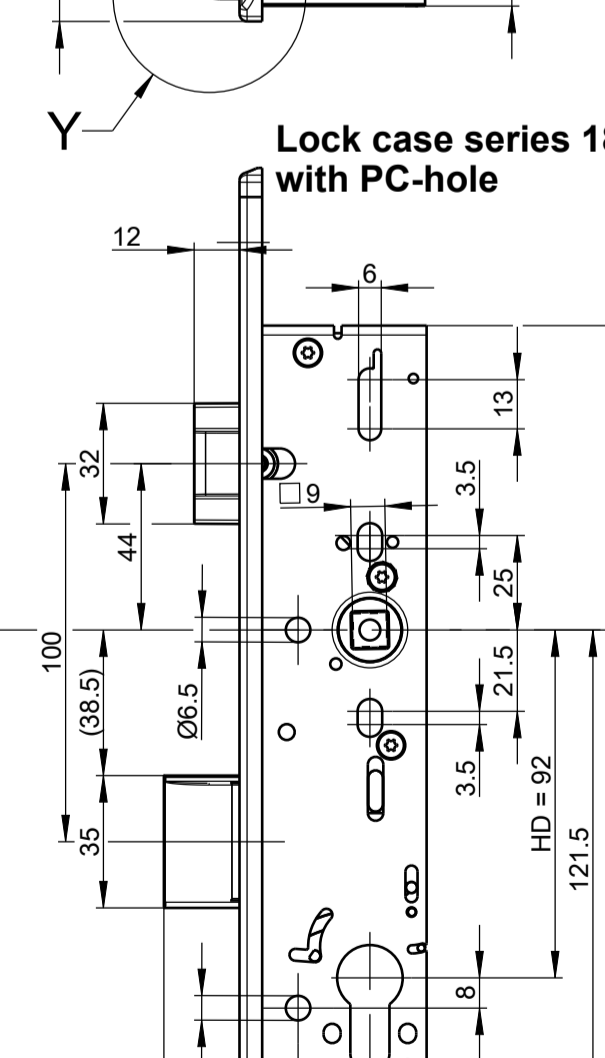

SECURITY Economy lock case with RC hole

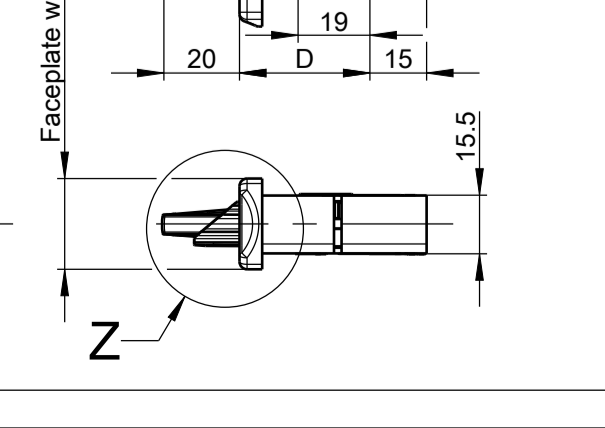

Series 13

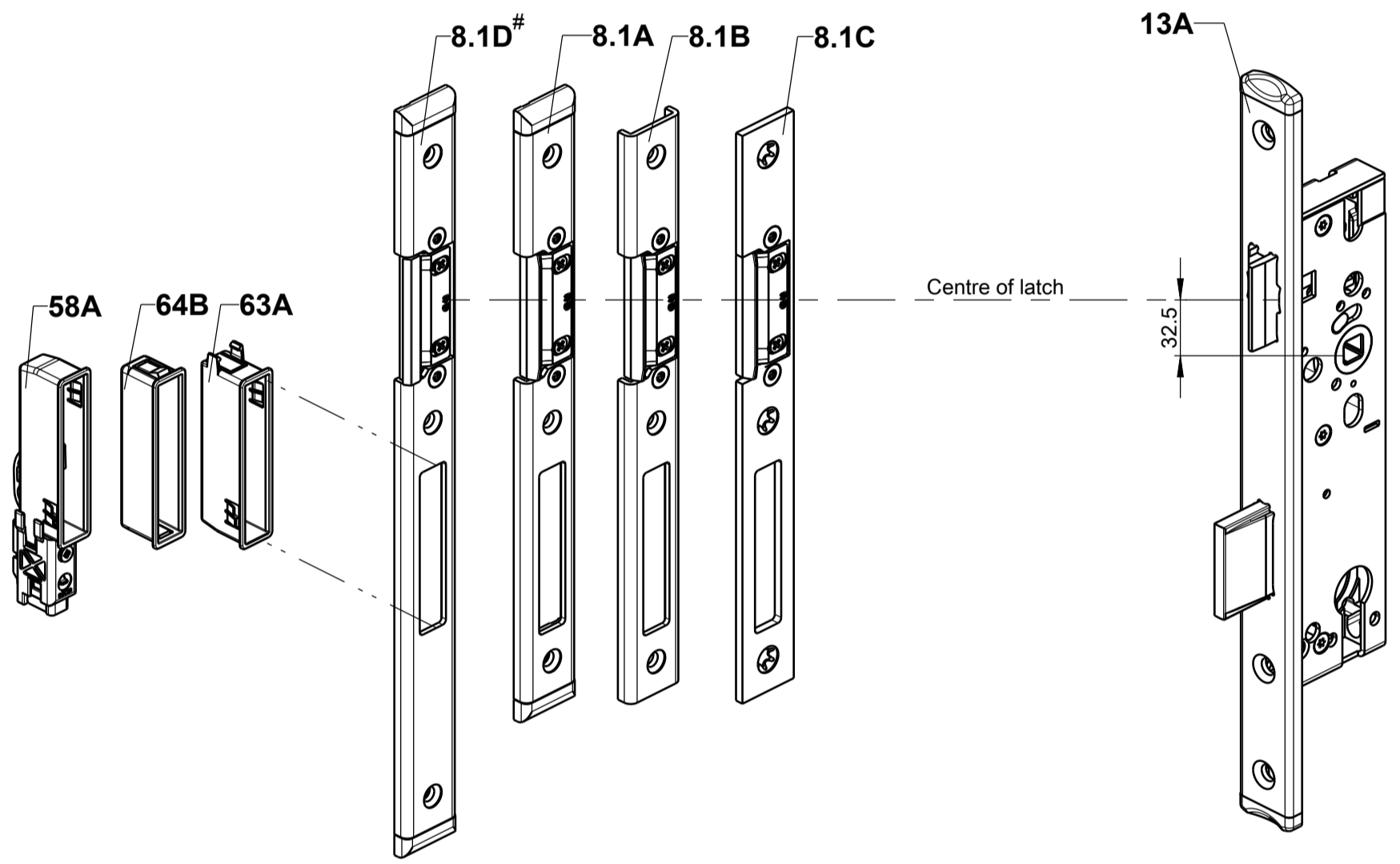

eg
B 1300 0XXX (Standard function)
B 1311 0XXX (Fire-rated door lock)
B 1316 0XXX (Panic function E)

Frame milling for L&D striker

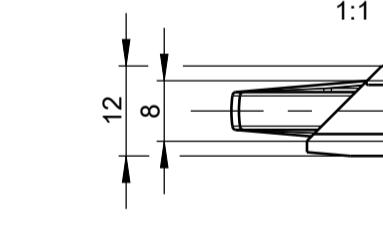
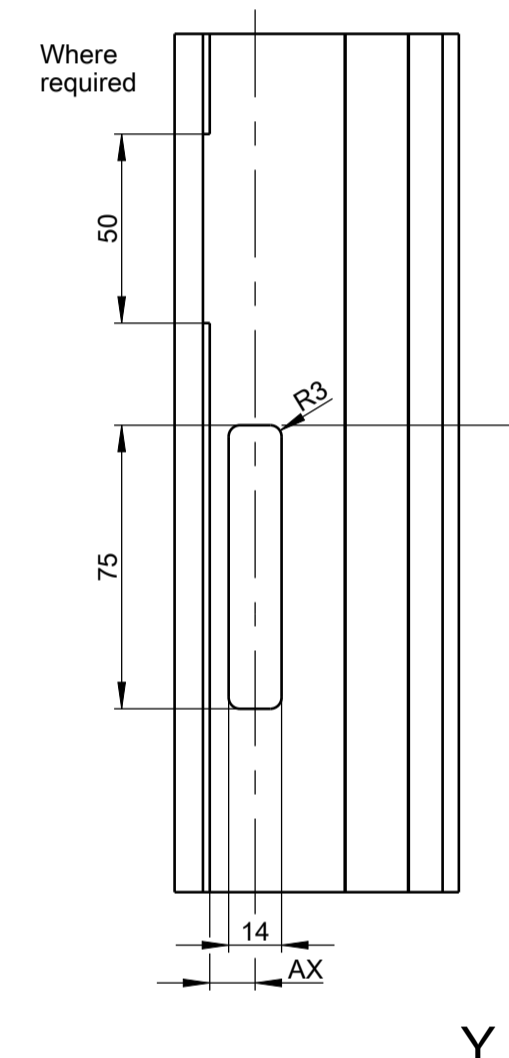

Frame milling for L&D striker

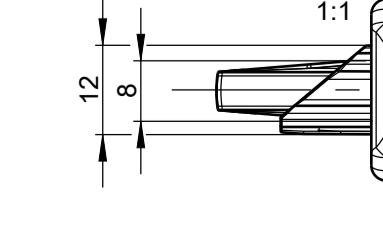
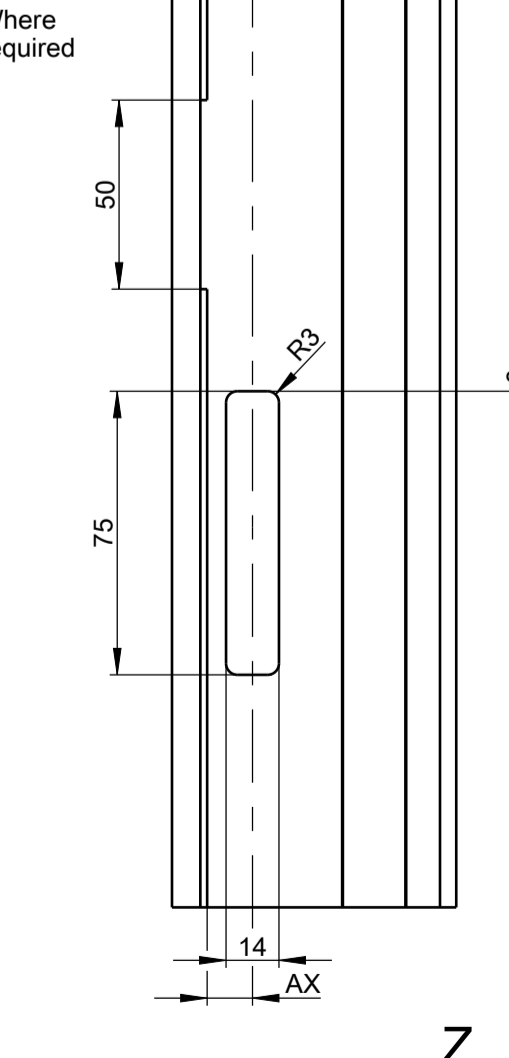

Frame milling for L&D striker

Lock case series 13 with PC-hole

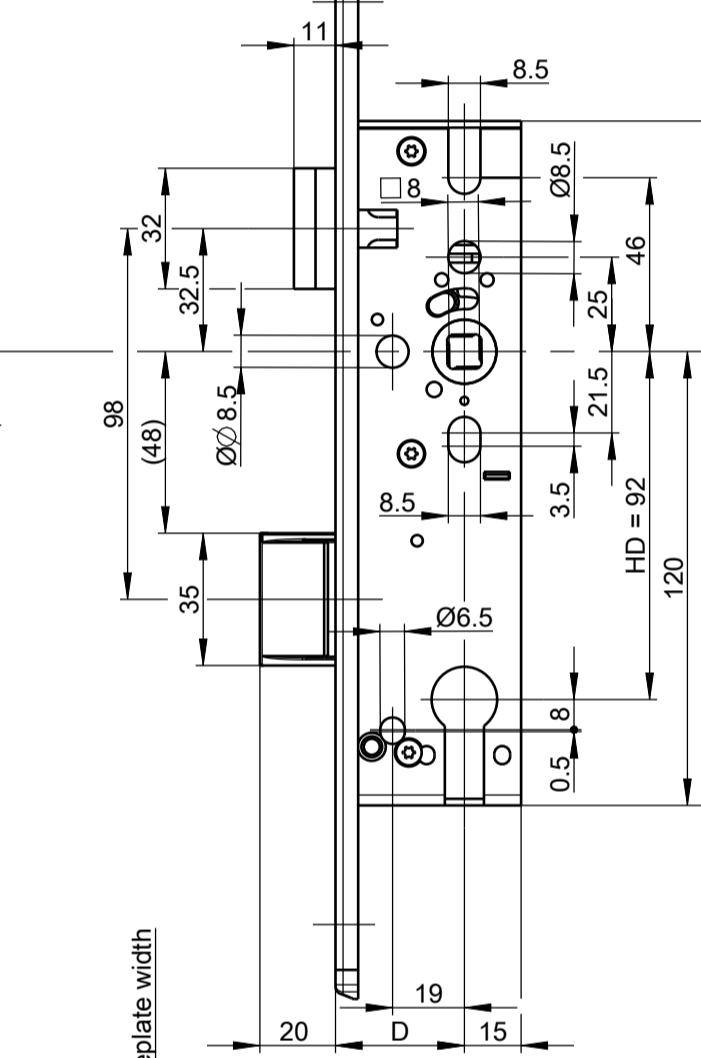

Lock case series 13 with RC hole

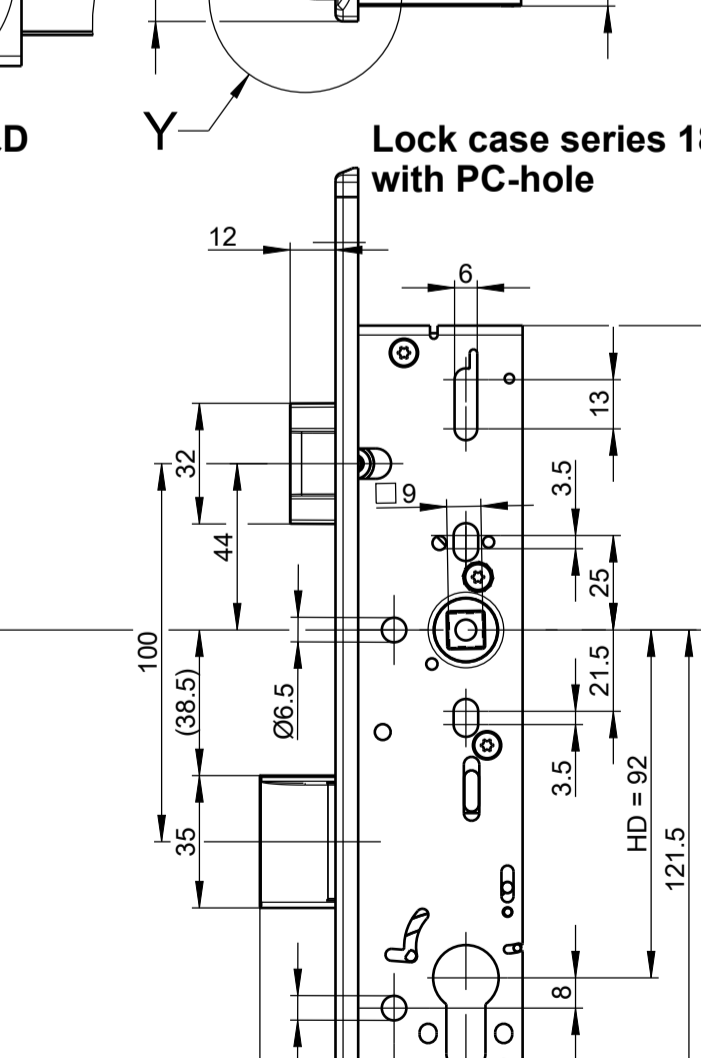

Lock case series 13 with RC hole

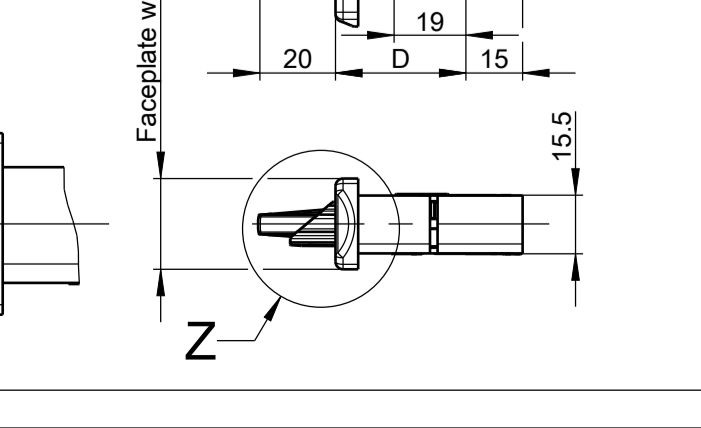

Serie 18

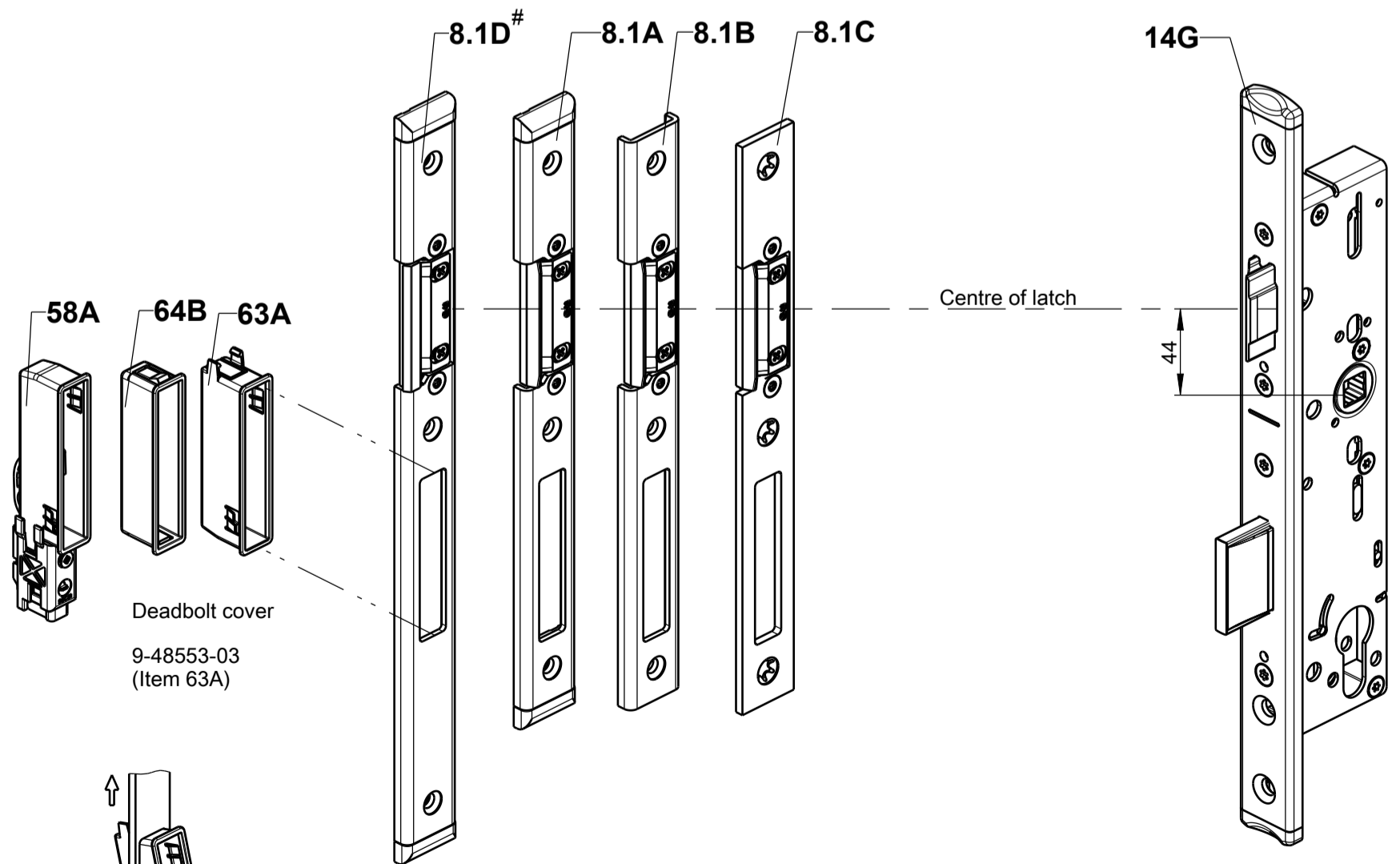

Installation of the monitoring contact
K-19063 is possible
Installation instructions: 0-49871-L0

eg
B 1820 0XXX (Panic function B)
B 1822 0XXX (Panic function C)
B 1824 0XXX (Panic function D)
B 1826 0XXX (Panic function E)

Frame milling for L&D striker

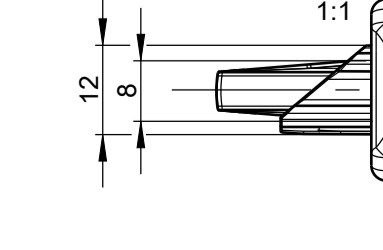
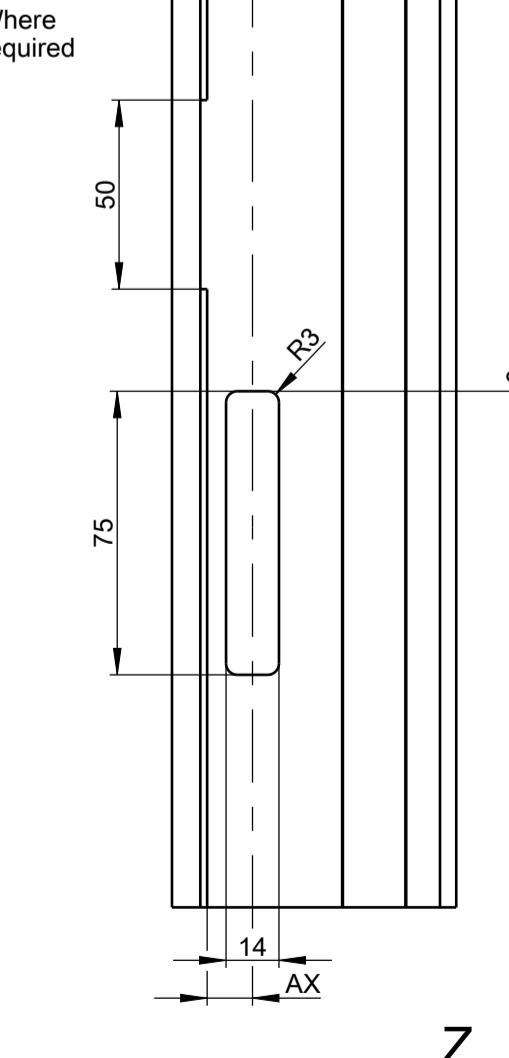

Frame milling for L&D striker

Lock case series 18 with PC-hole

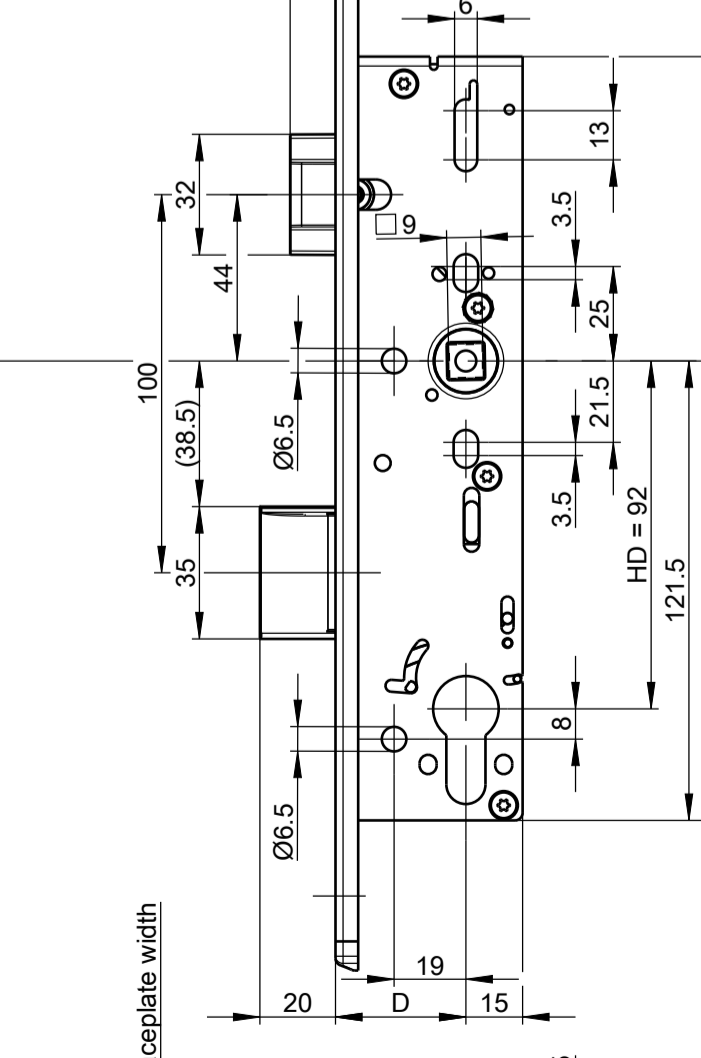

Lock case series 18 with RC hole

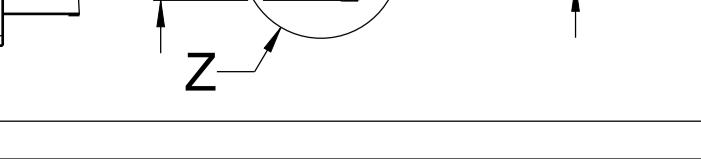

Lock case series 18 with RC hole

Leaf milling for SECURITY Economy lock case

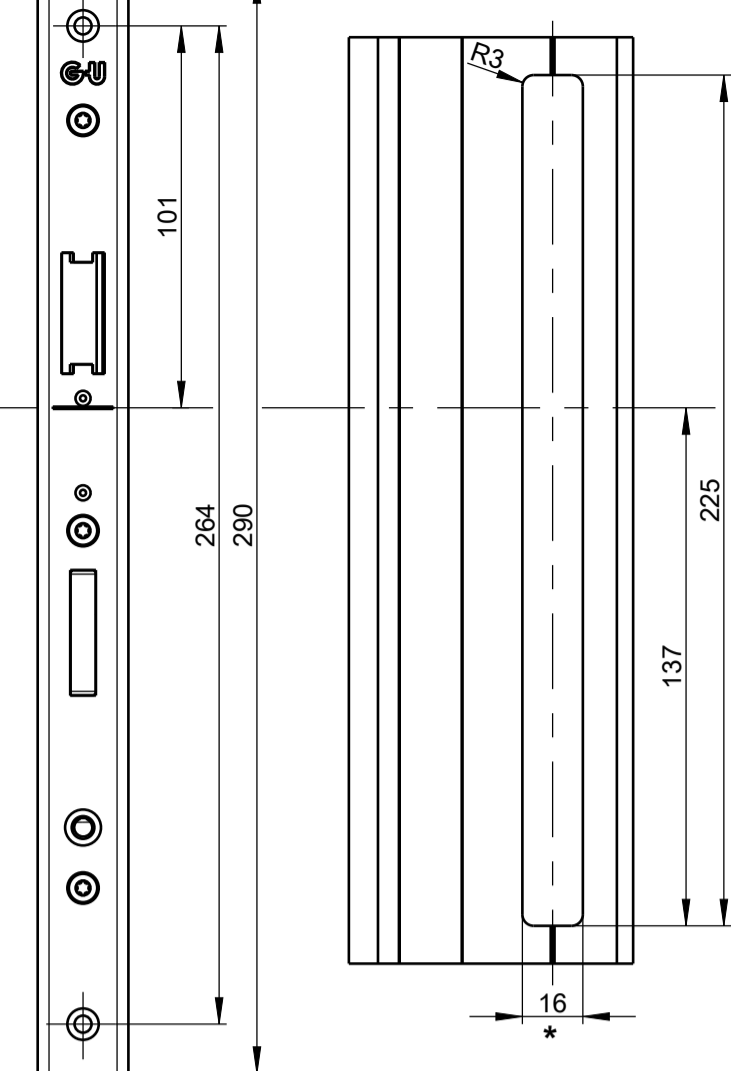

Leaf milling for SECURITY Economy lock case

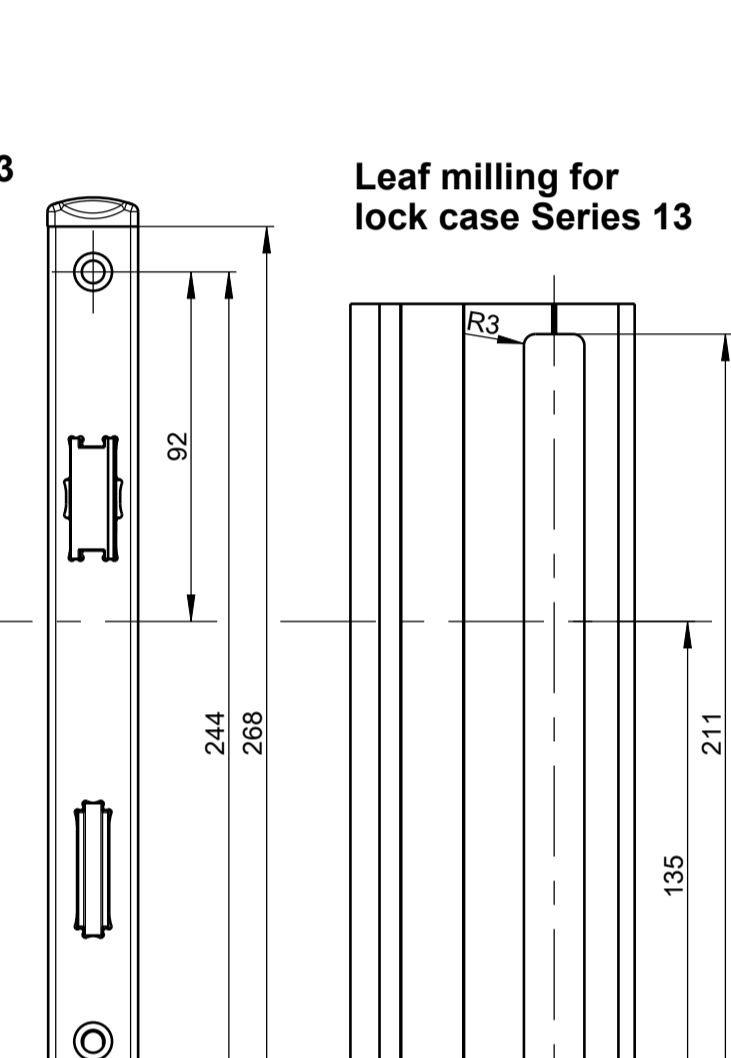

Leaf milling for SECURITY Economy lock case

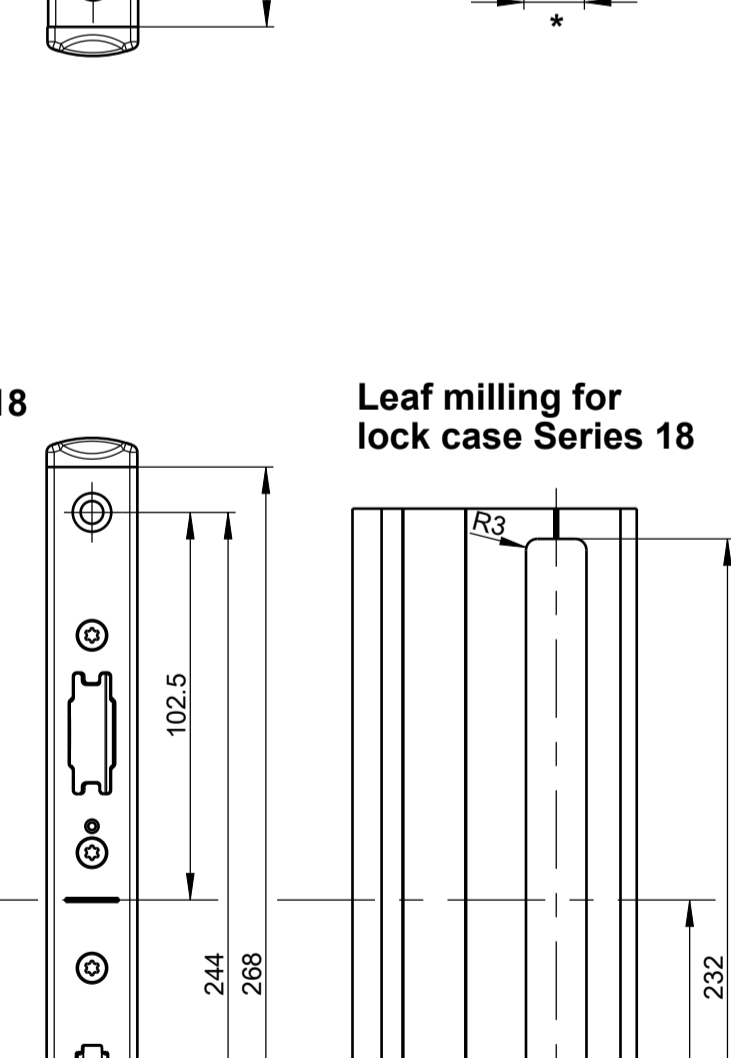

Leaf milling for SECURITY Economy lock case

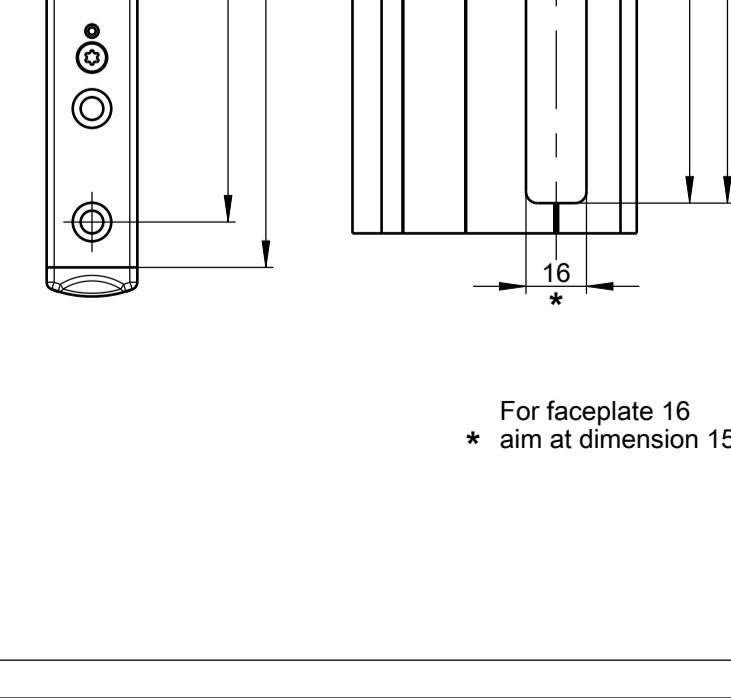

Leaf milling for PC-hole

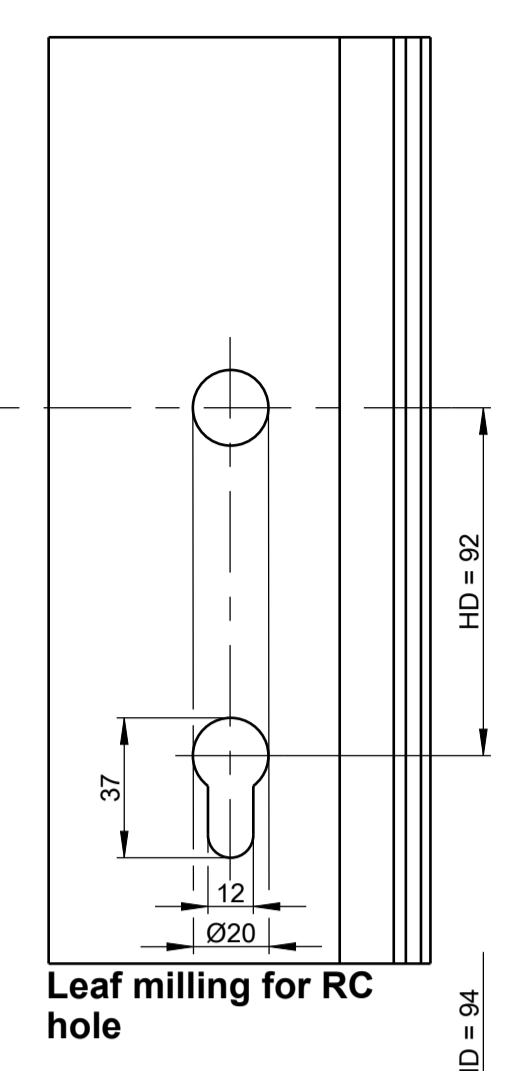

Leaf milling for RC hole

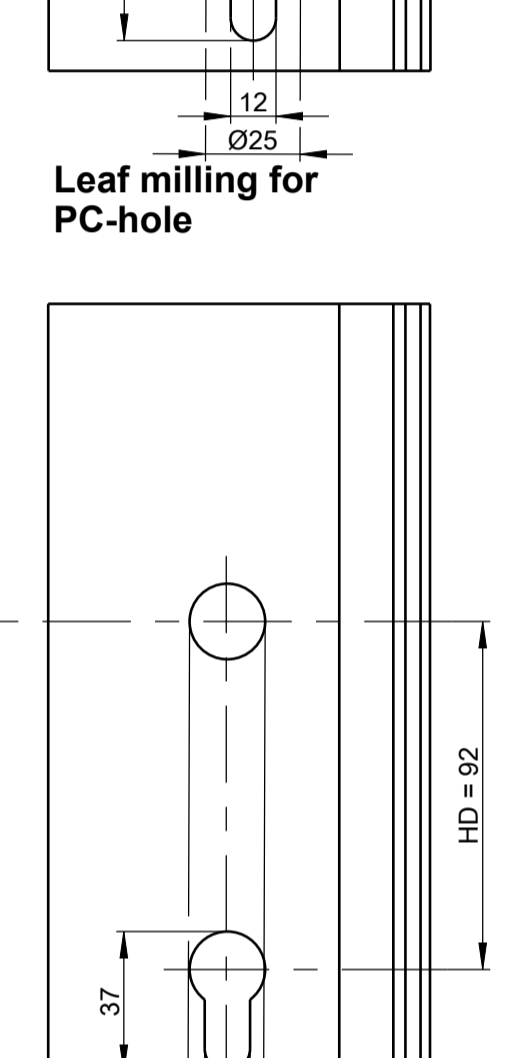

Leaf milling for RC hole

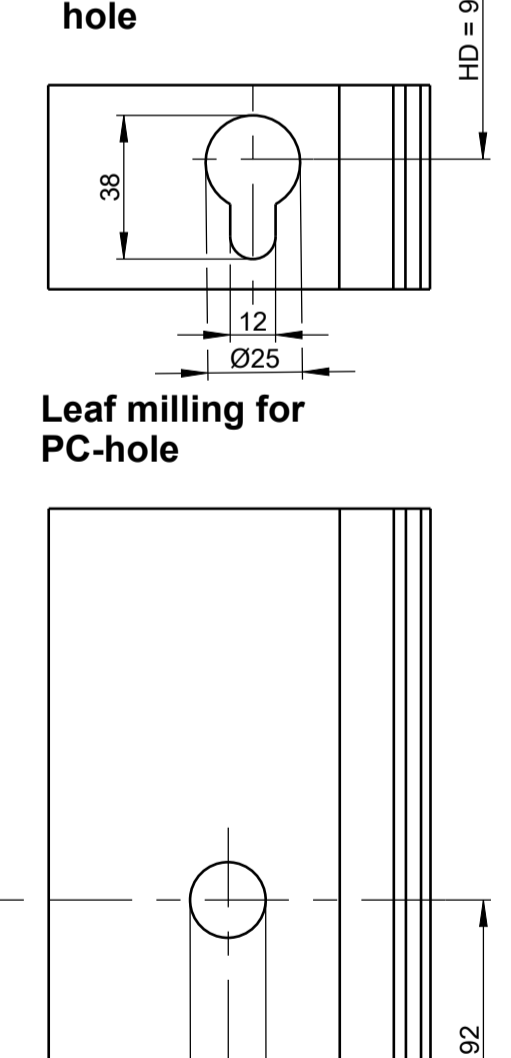

Leaf milling for RC hole

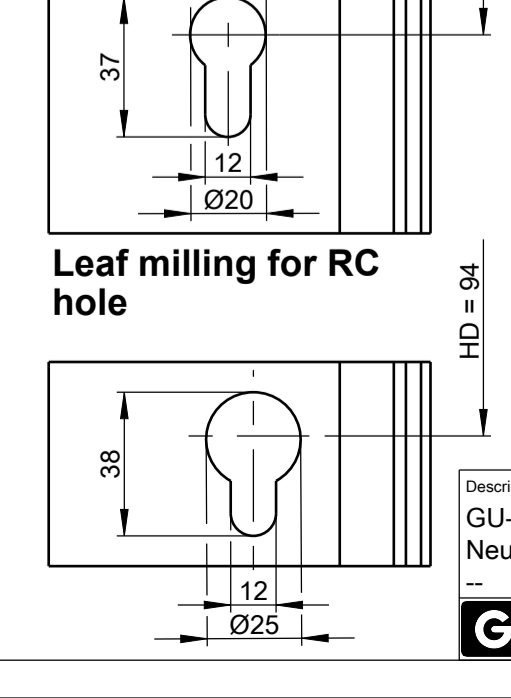

SECURITY Economy lock case (Overlapping profile system)

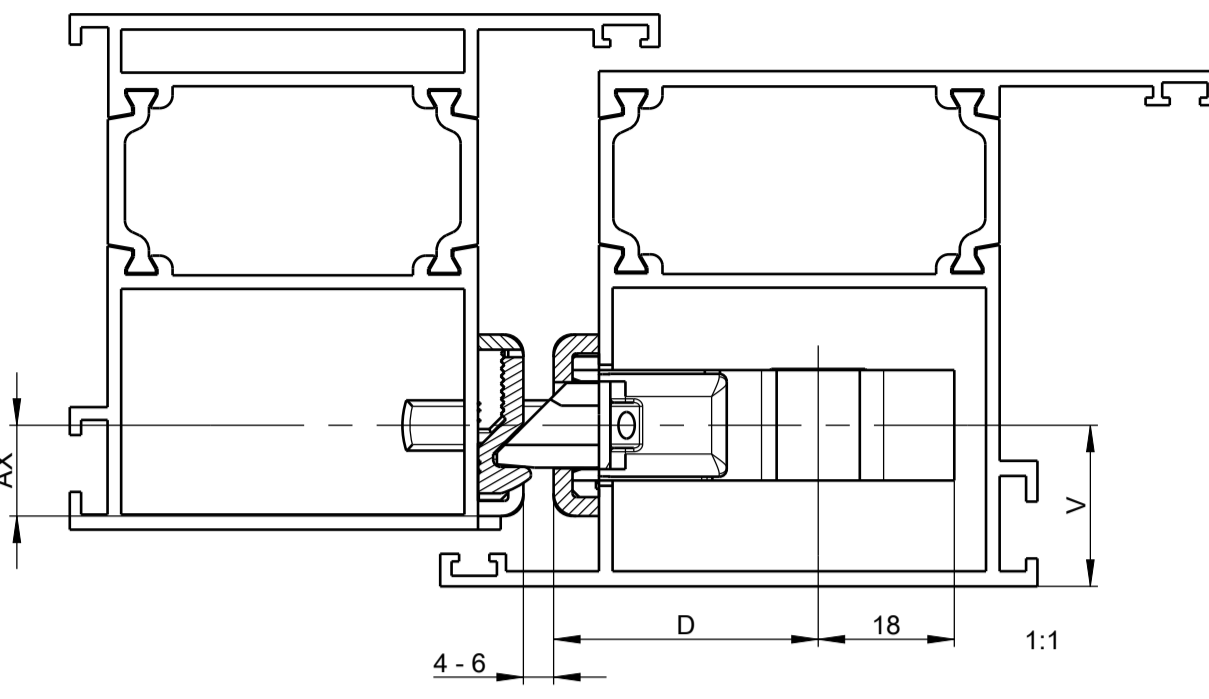

SECURITY Economy lock case (Flush profile system)

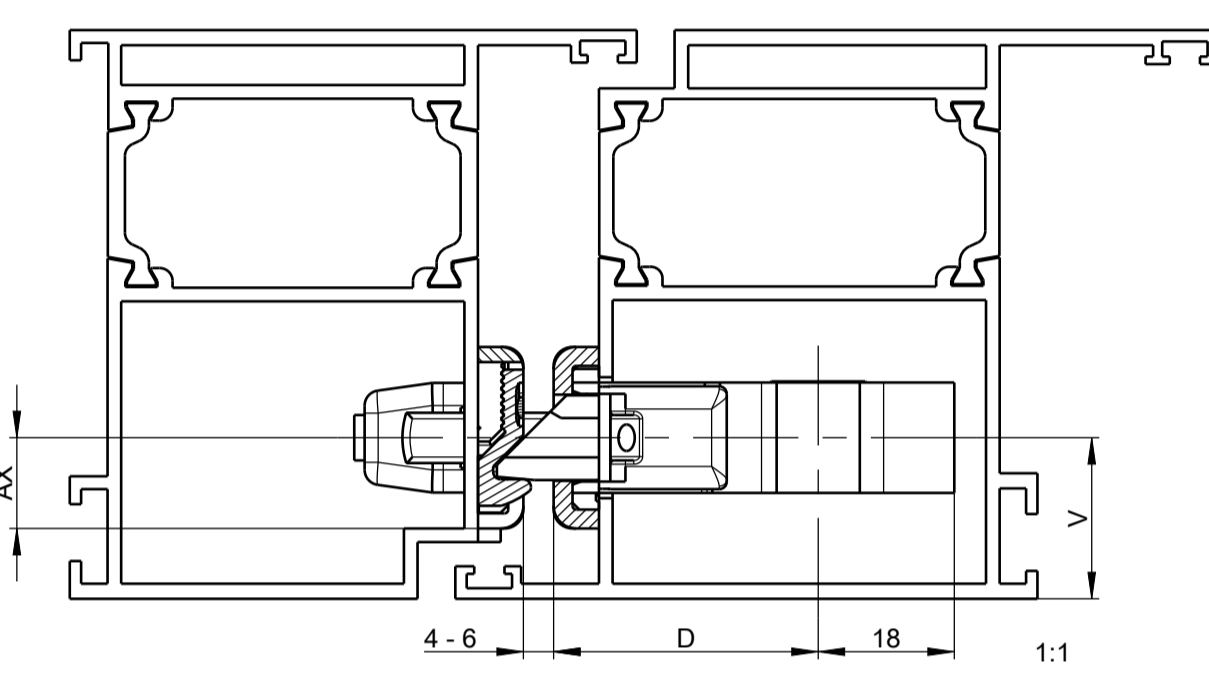

Lock case series 13

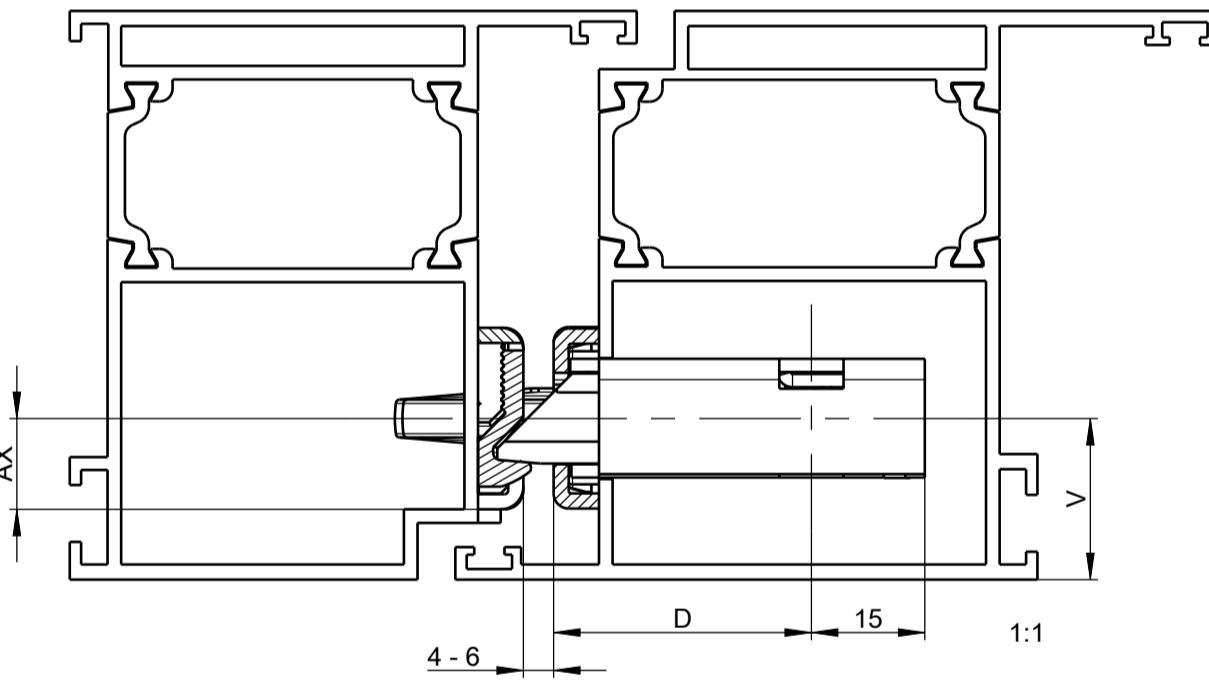

Lock case series 18

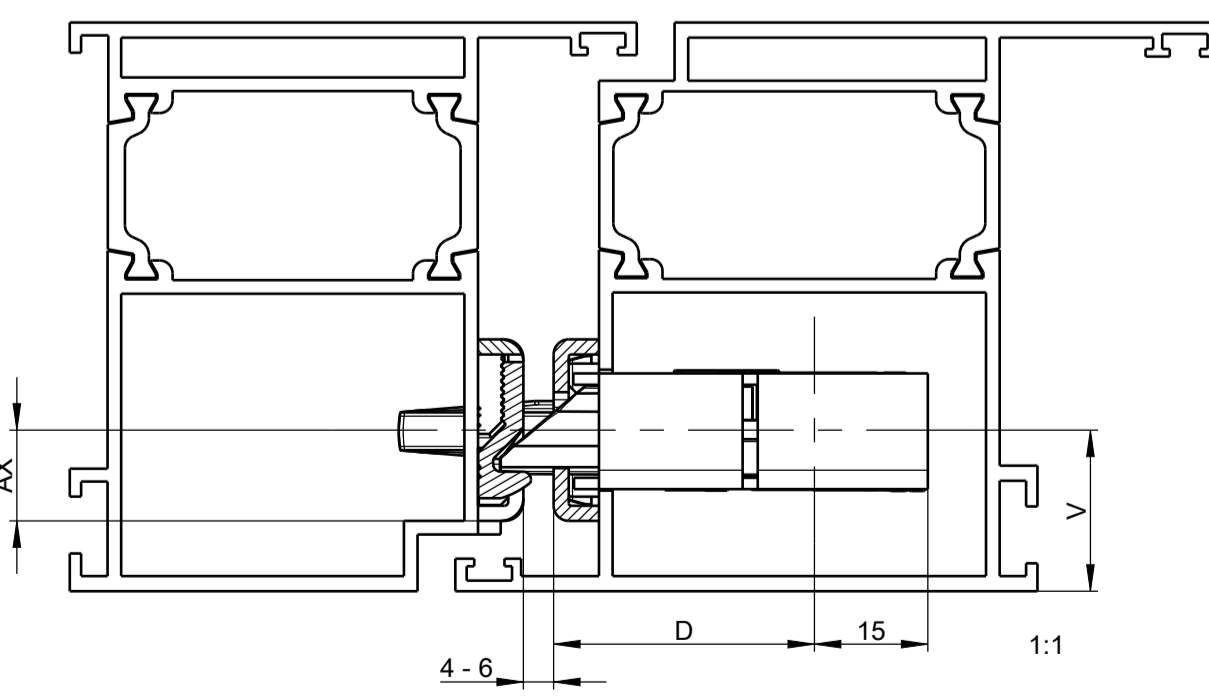

V = lock position (depending on profile)
AX = axis (accessories)

Mortise locks

The documents accompanying this product were issued when the product was manufactured. You should verify on www.gu.com if the technical documents you have at hand are up to date. For more information, please contact our technical department.
 GU
 EN, ES, FR
 1/8

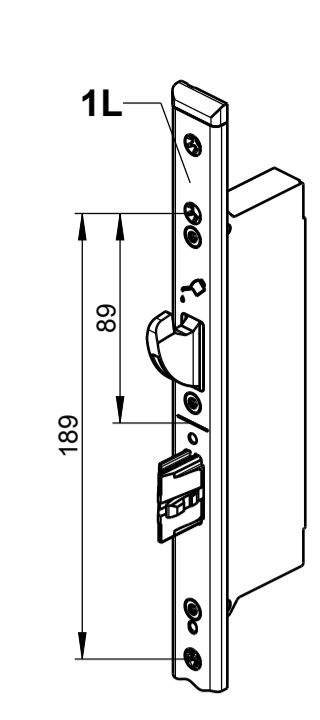
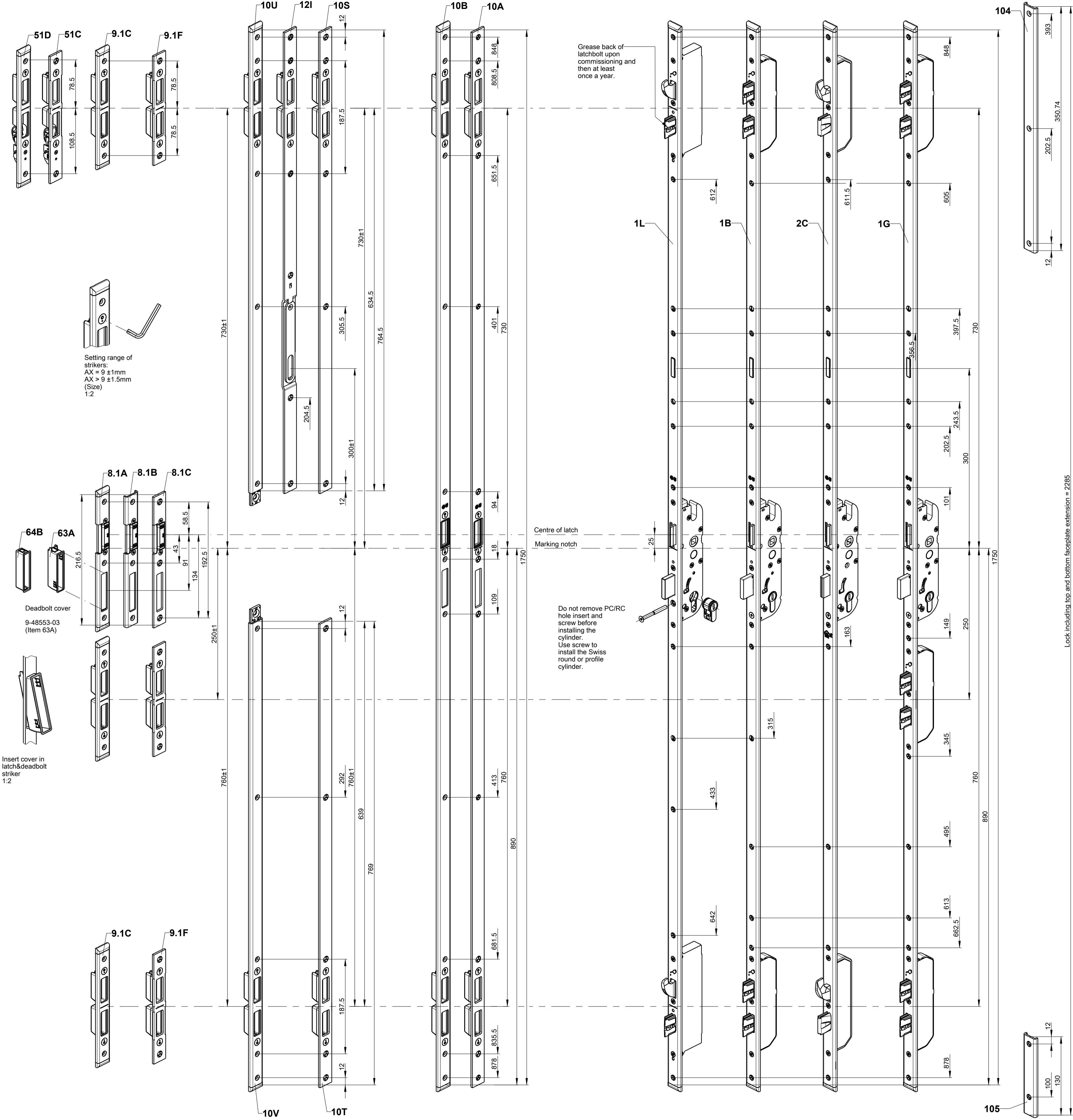

Mounting holes are required for RC4-compatible locks and must be provided by the customer. The associated frame-side accessories must be positioned such that the hook bolt overlaps as much as possible with the accessories on the frame side.

Setting range of strikers:
 AX = 9 ± 1mm
 AX > 9 ± 1.5mm
 (Size)
 1:2

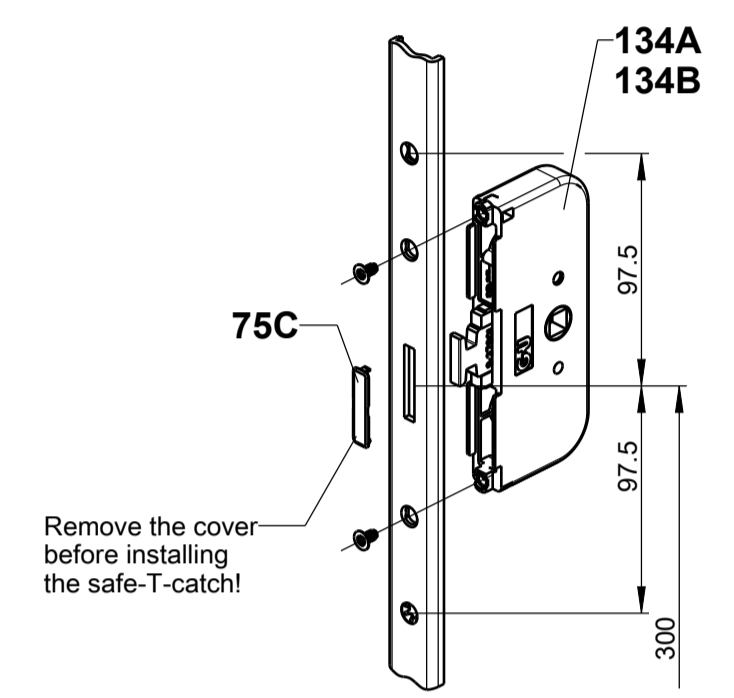
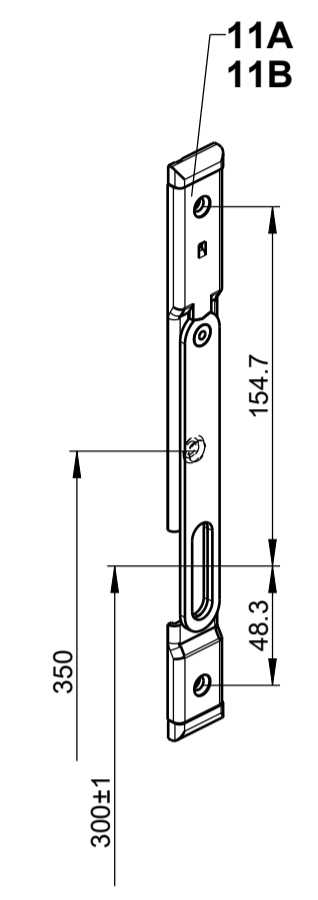

Optional: GU-SECURITY with safe-T-catch (prepared for safe-T-catch)

Optionally with item 1A, 1B, 1F, 1G

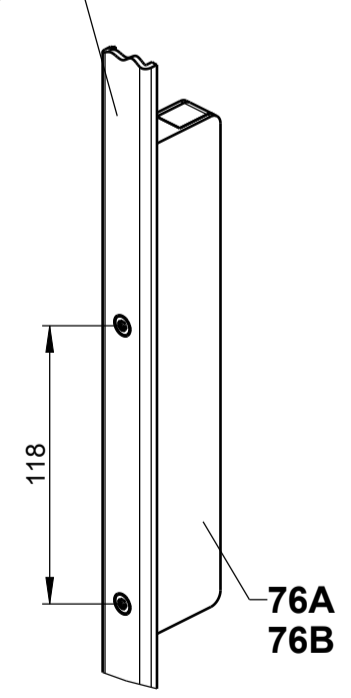

For optional installation of A-opener/A-opener servo with connecting cable and plug refer to installation instructions 0-45777-L0.

Lock including top and bottom faceplate extension = 2285

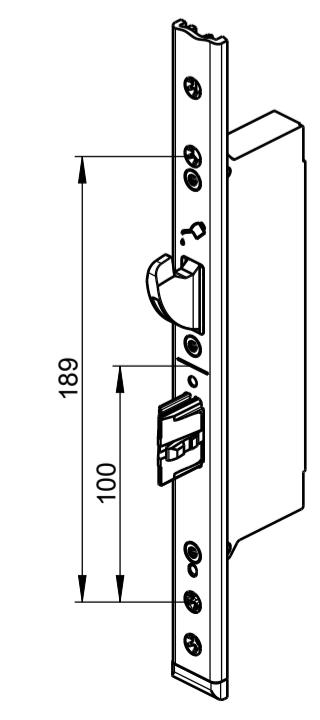

AX	Height of U-profile			Height of U-profile		
	5	6	8	5	6	8
Dimension Z		Dimension W				
≥ 12	18	min. 17	3	3.5		
11	17		3			
10	17		2			
9	15		2			

Frame milling for striker
Item 9.1A, 9.1B
9.1D, 9.1E

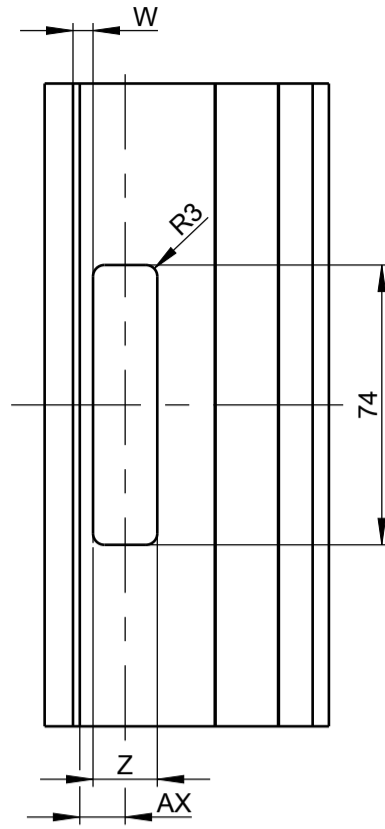

Frame milling for striker with monitoring contact
Item 51A, 51B

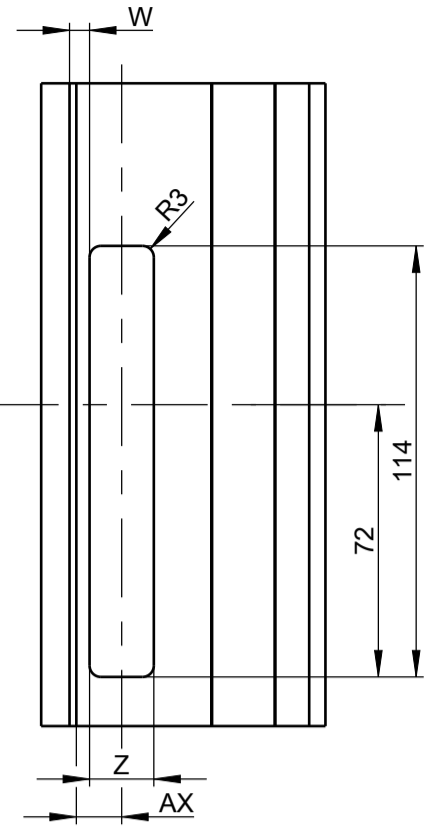

Latchbolt

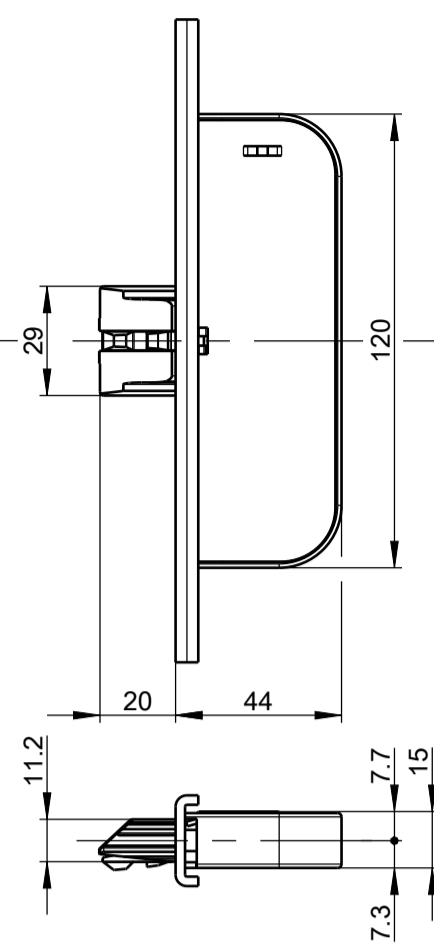

Massive bolt (MR)

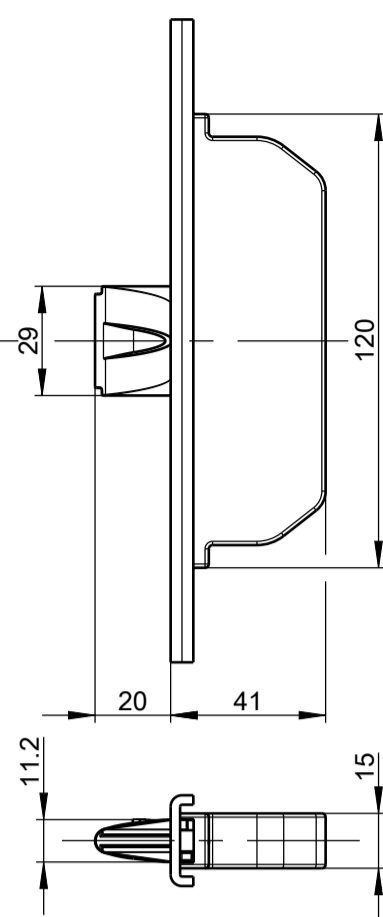

Hook bolt (SH)

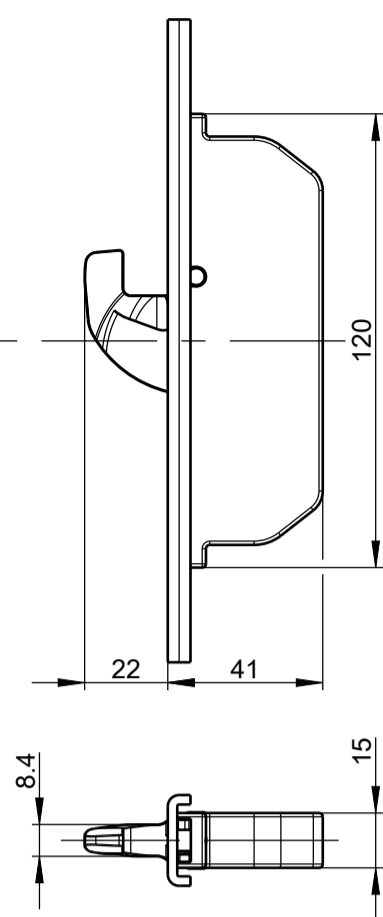

Leaf milling for Automatic, MR and SH bolt

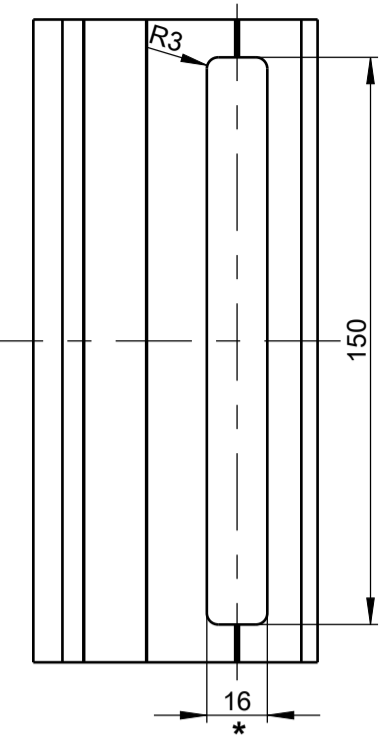

Latchbolt Striker (AX ≥ 12)

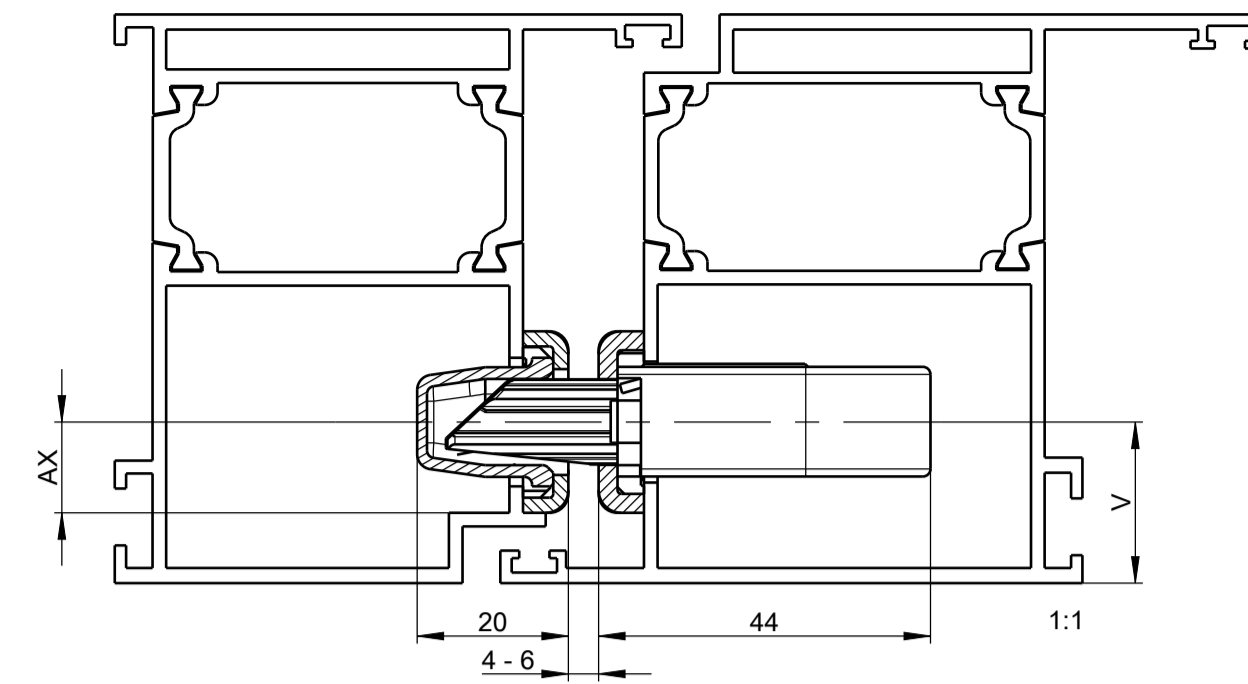

Hook bolt (SH) Striker (AX ≥ 12)

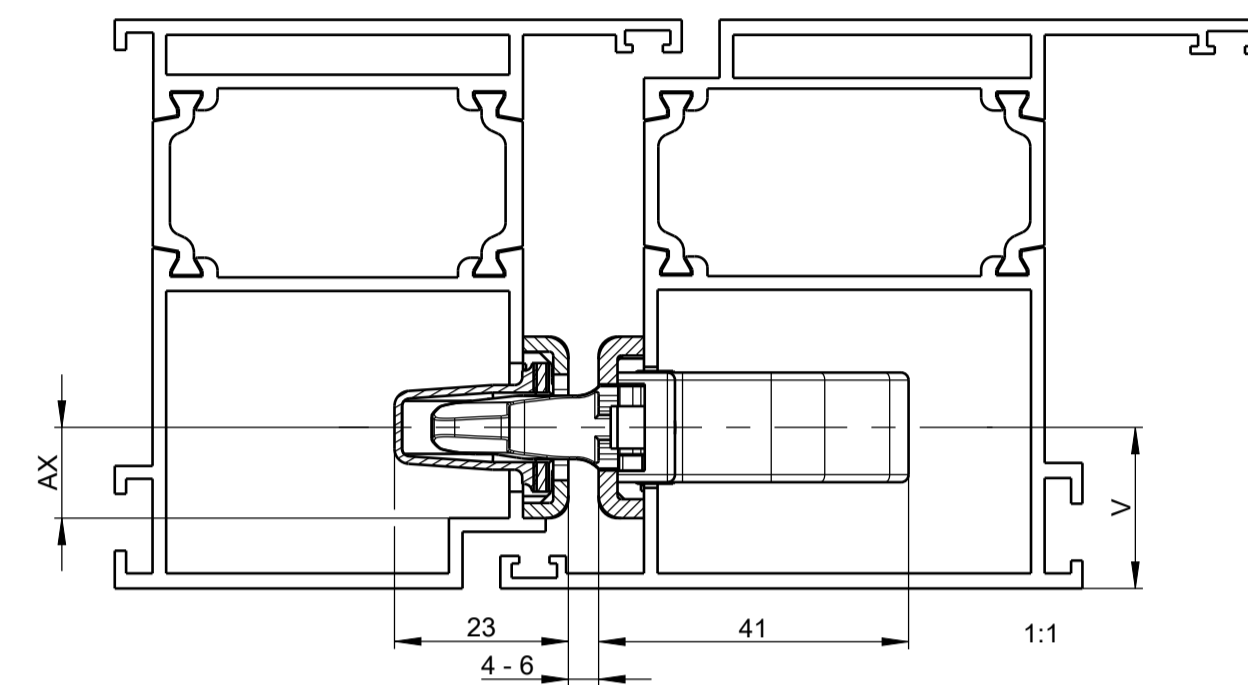

Frame milling for safe-T-catch striker
Item 11A, 11B

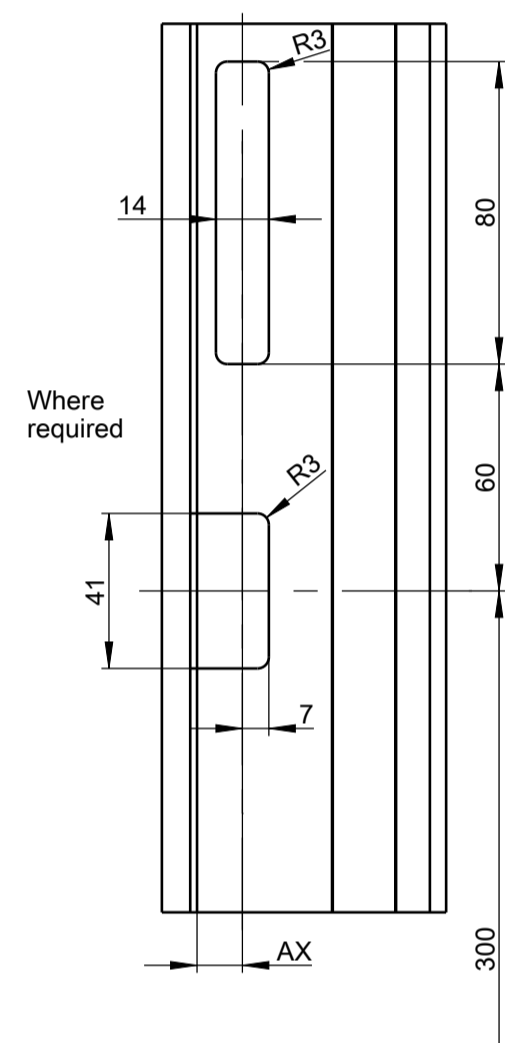

Safe-T-catch lock

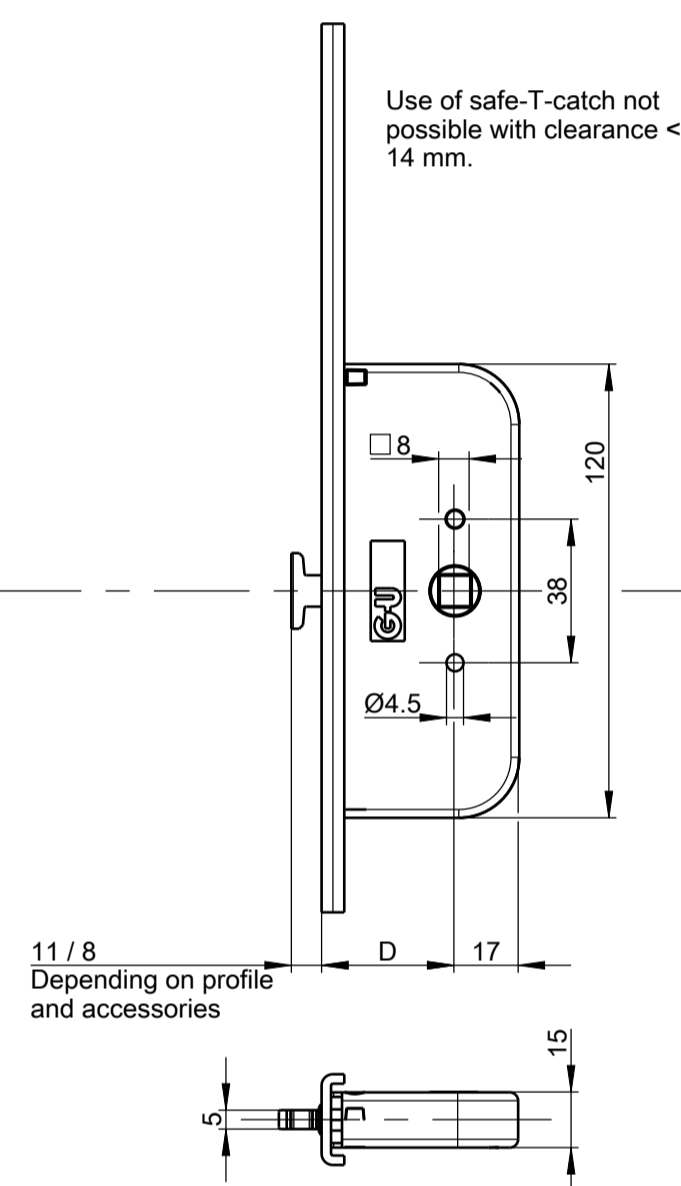

Leaf milling for safe-T-catch lock

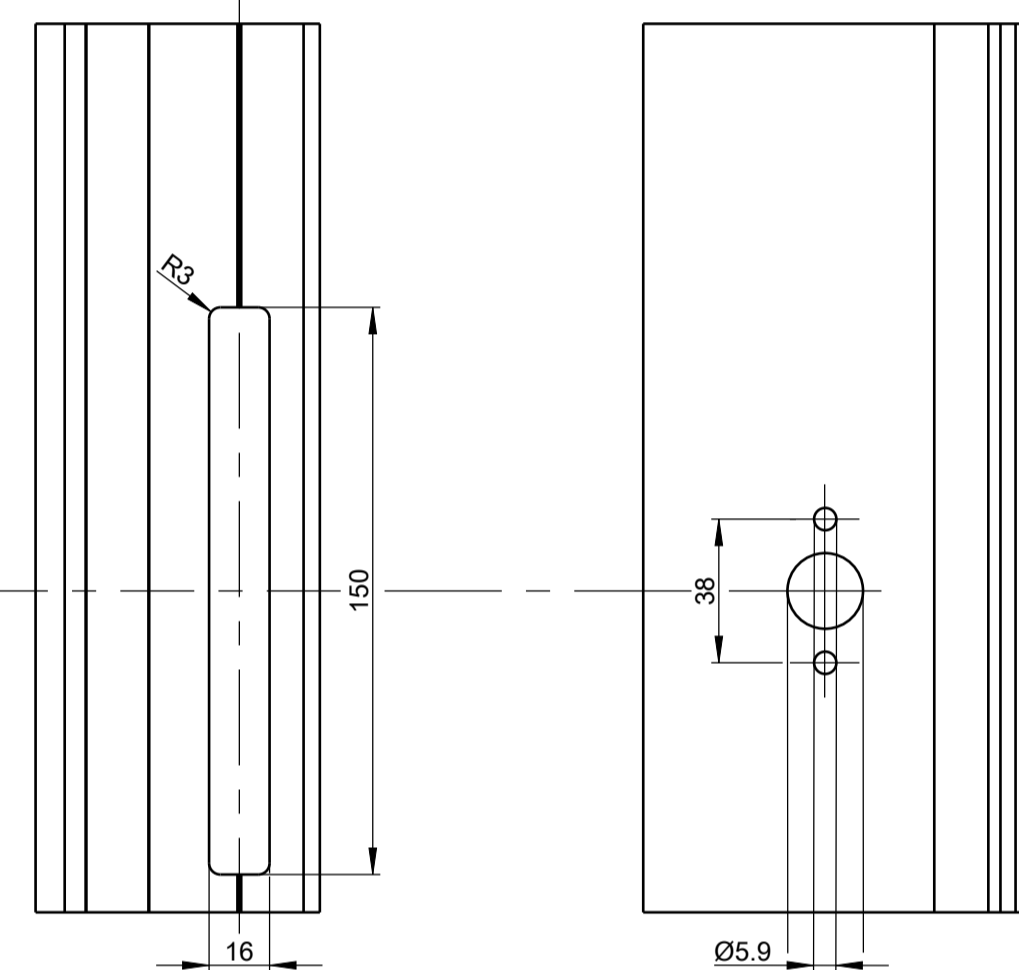

Safe-T-catch lock

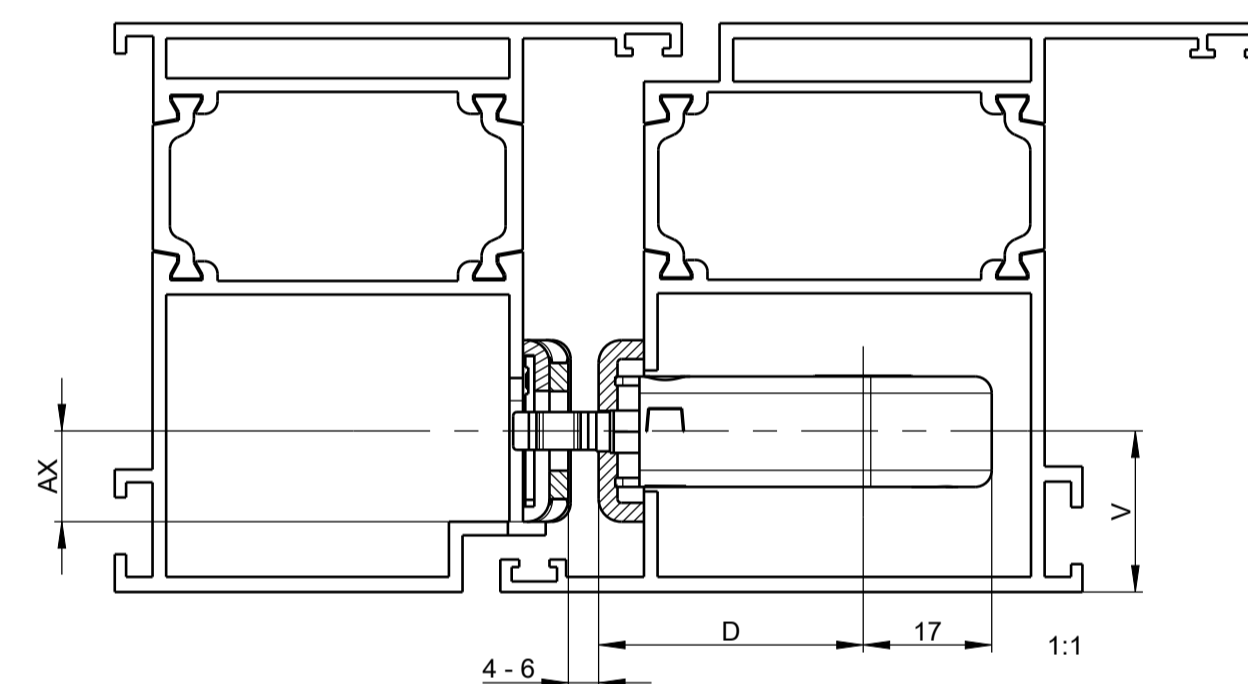

Frame milling for L&D striker
Item 8.1A, 8.1B, 8.1C

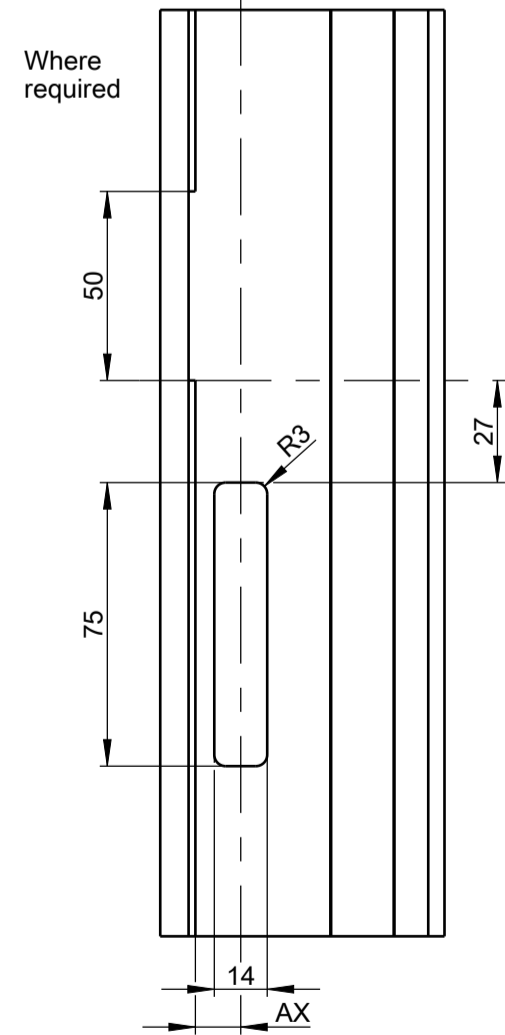

Lock case with PC hole

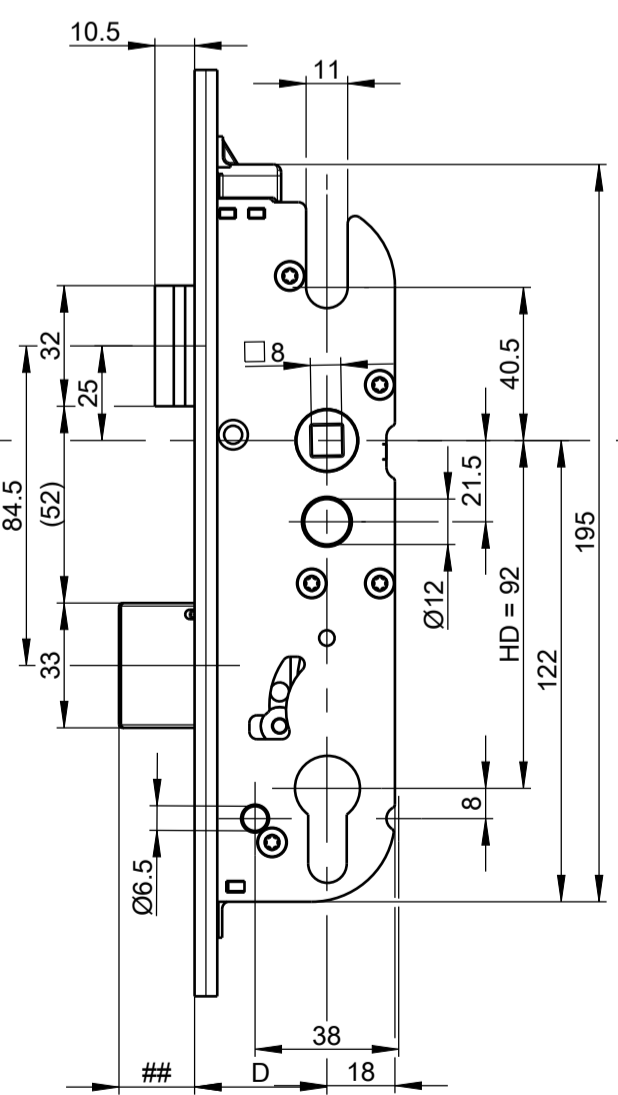

Lock case with RC hole

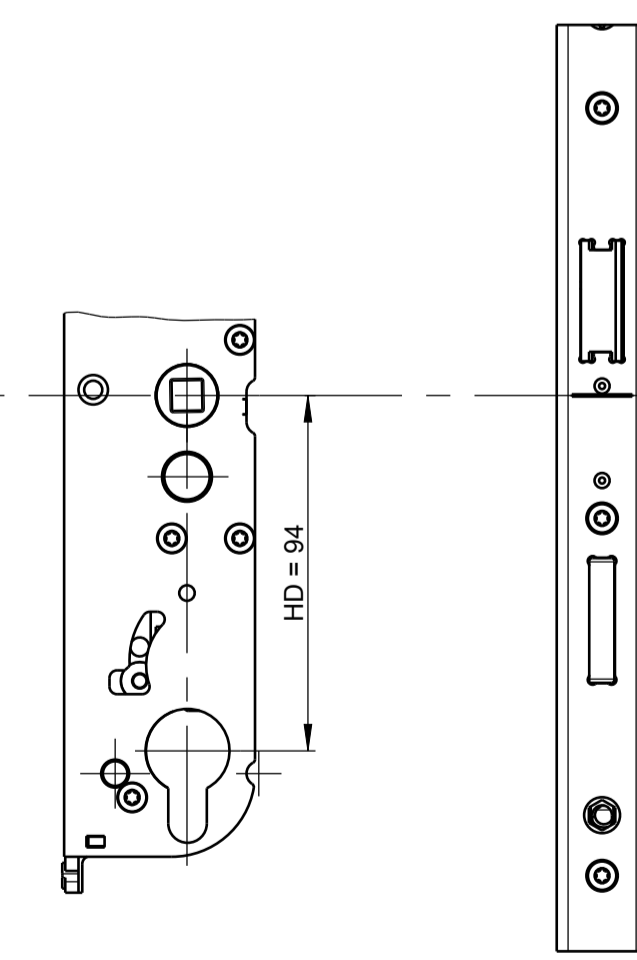

Leaf milling for lock case

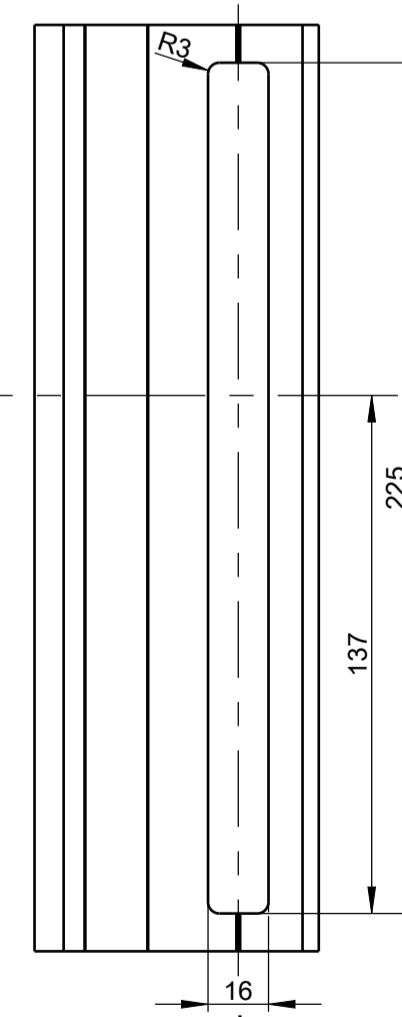

Leaf milling for PC-hole

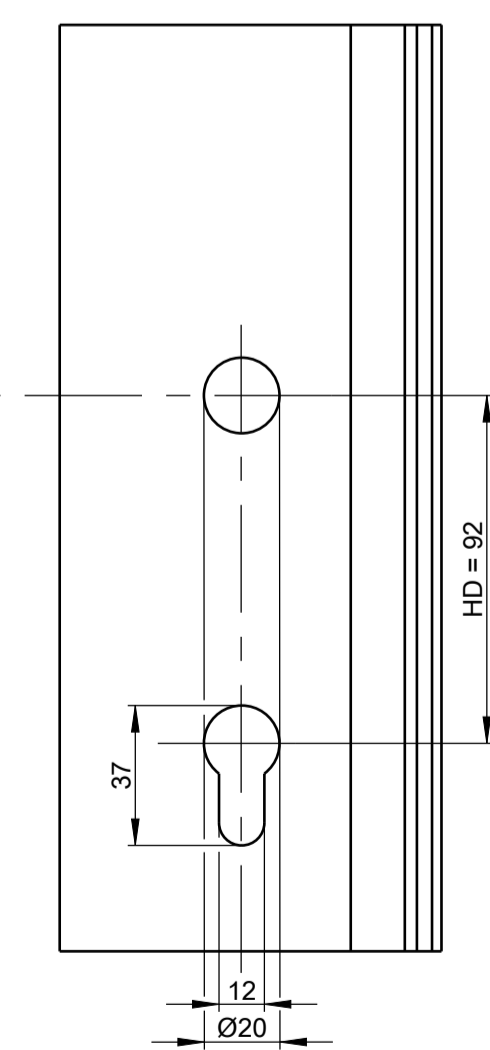

Lock case (Flush profile system)

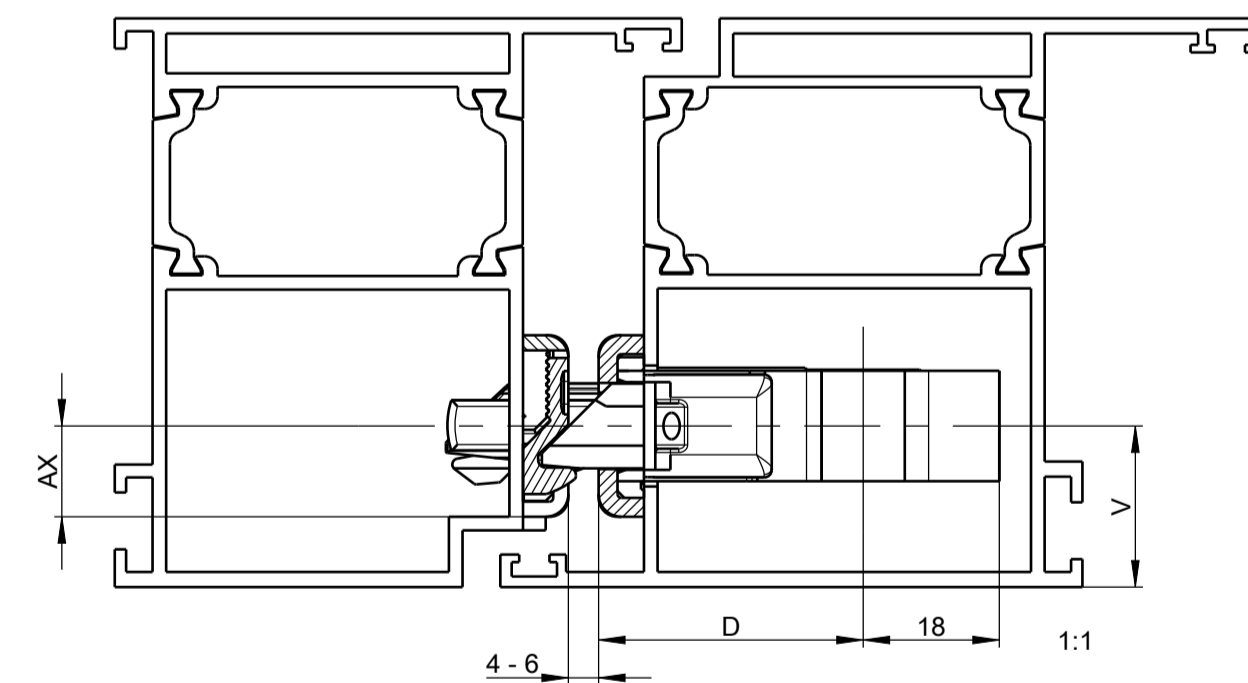

Lock case (Overlapping profile system)

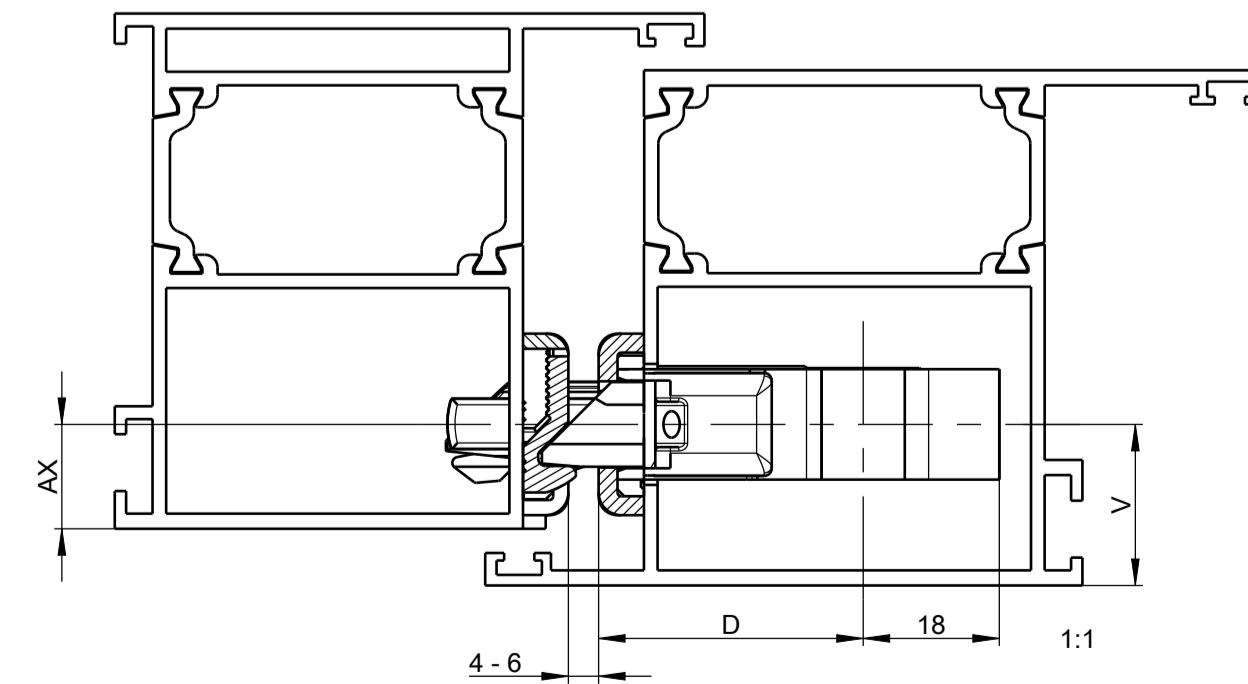

Leaf milling for RC hole

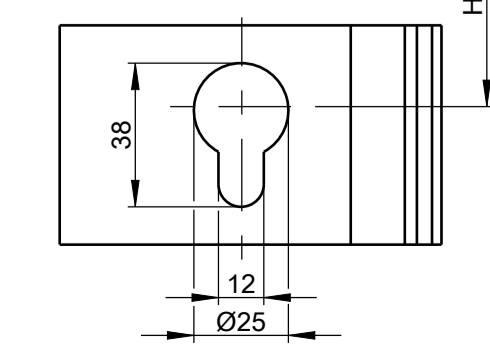

= 13 for SECURY V (manual locks): D = 33 - 35
= 20 for SECURY V (manual locks): BS = from 40
= 20 for SECURY A (Automatic): BS = for all backsets

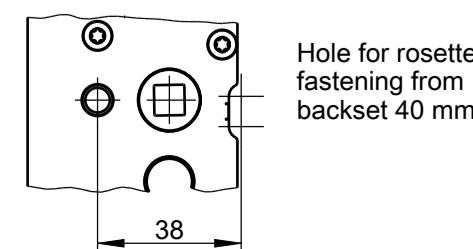

Hole for rosette fastening from backset 40 mm

AX = axis
V = lock position (depending on profile)
Further sectional views refer to sheet 7

Sectional depiction of multi-point locks

AX	Height of U-profile	Height of U-profile
5	6	8
6	6	8
8	6	8
Dimension Z		Dimension W
≥ 12	18 min. 17	3 3.5
11	17	3
10	17	2
9	15	2

Frame milling for striker
Item 9.1C, 9.1F

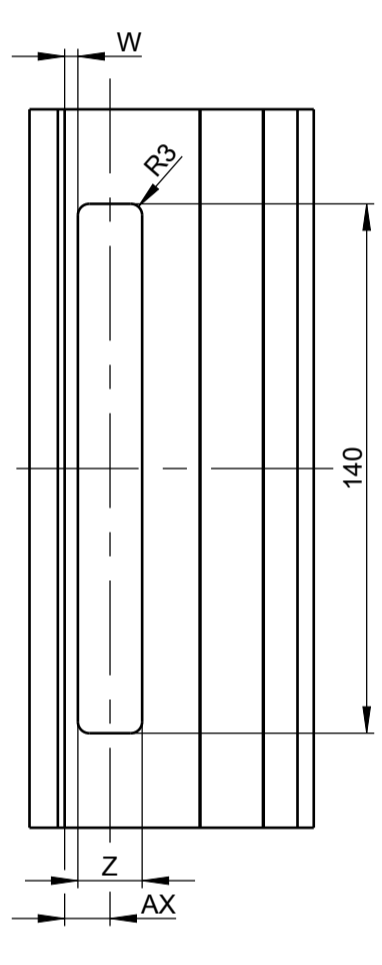

Frame milling for
striker with
monitoring contact
Item 51C, 51D

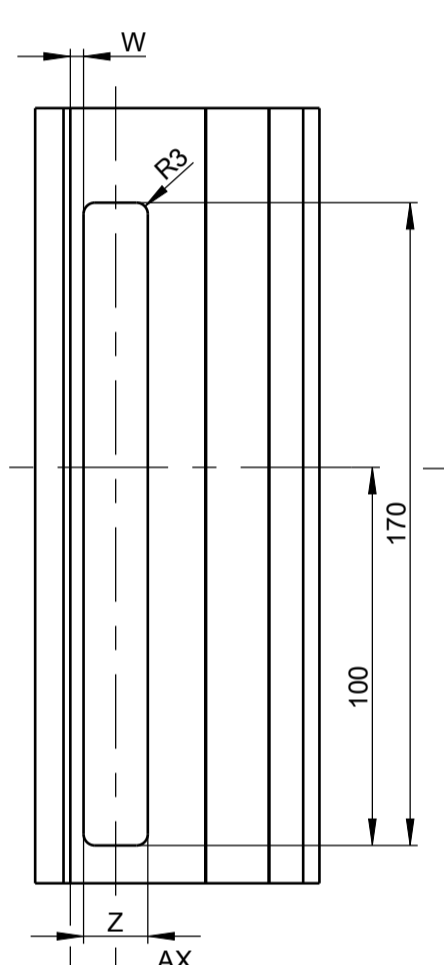

Double latchbolt

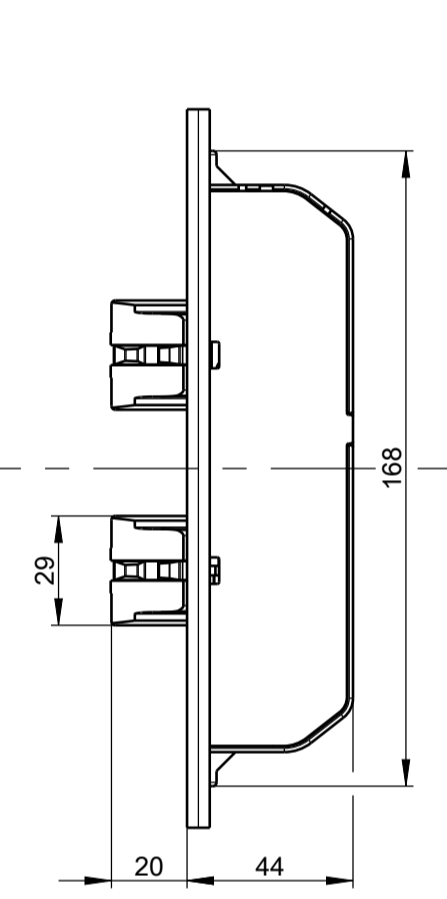

Double bolt (DR)

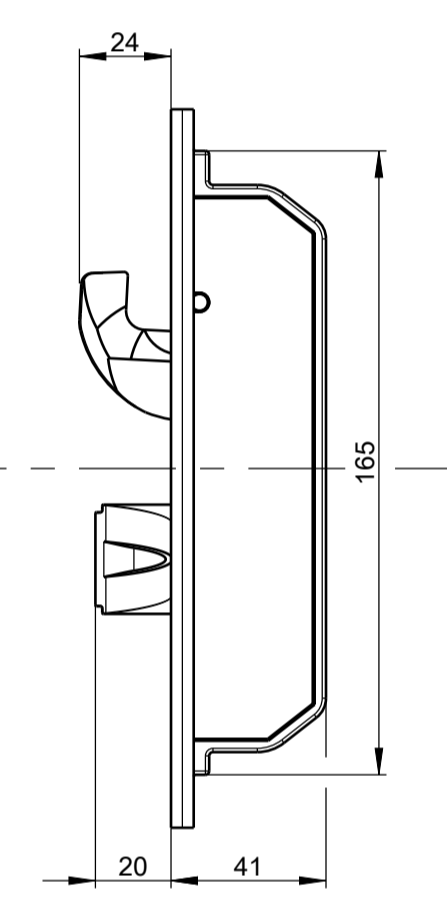

Leaf milling for
double latchbolt,
double bolt

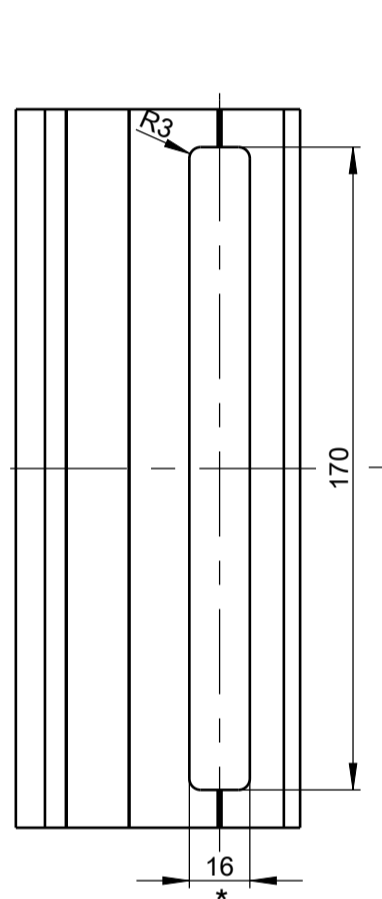

Automatic DR bolt

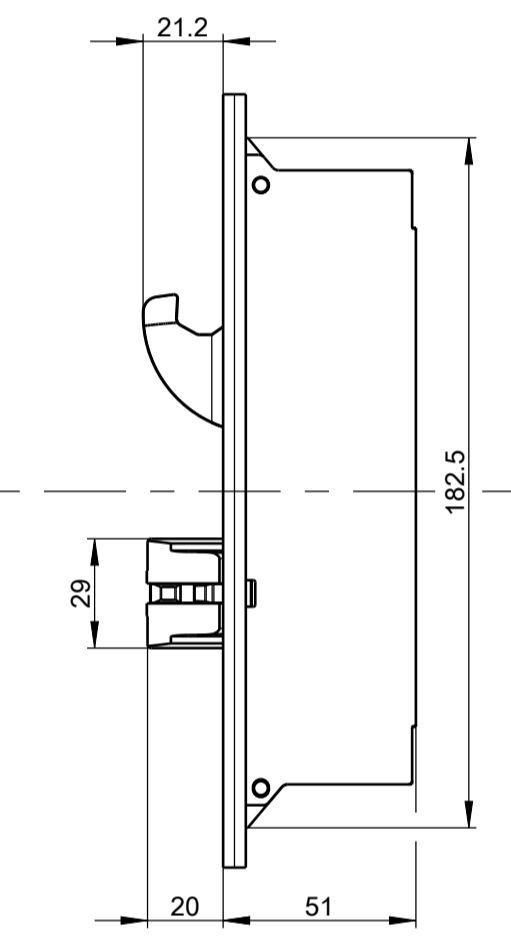

Leaf milling for
Automatic DR bolt

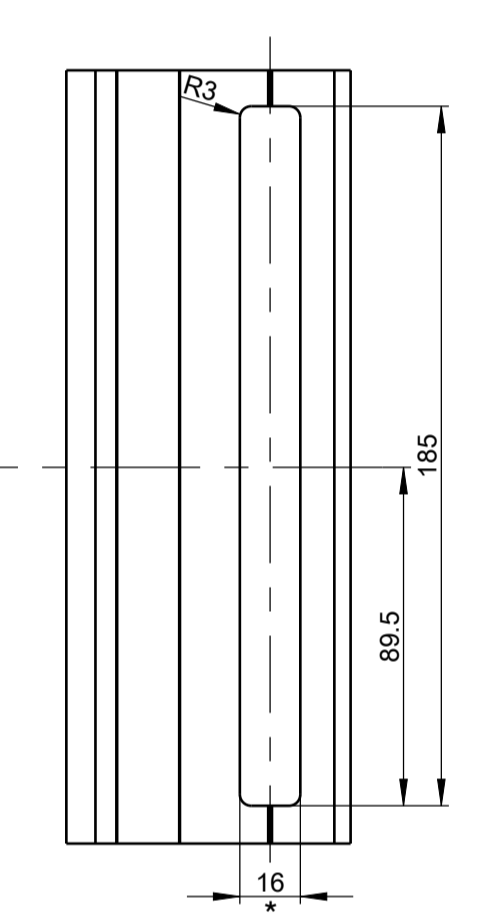

* For faceplate 16
aim at dimension 15.5

Double latchbolt
Striker (AX ≥ 12)

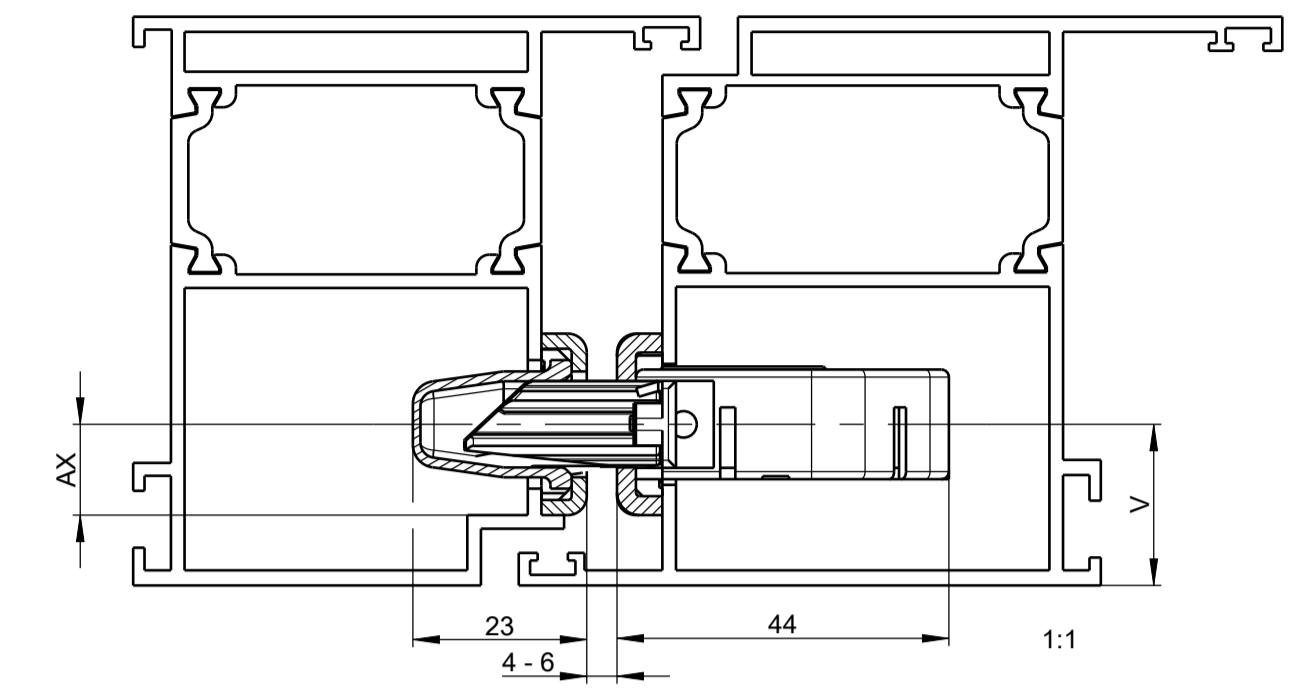

Double bolt (DR)
Striker (AX ≥ 12)

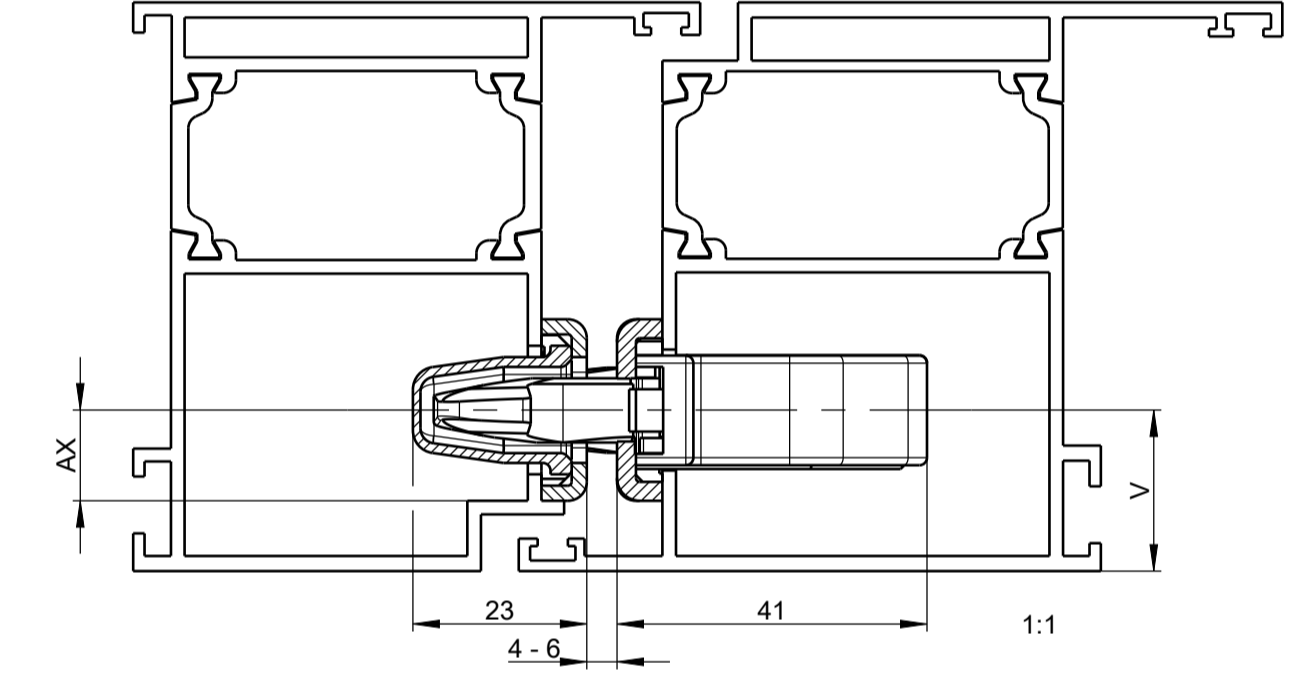

Automatic DR bolt
Striker (AX ≥ 12)

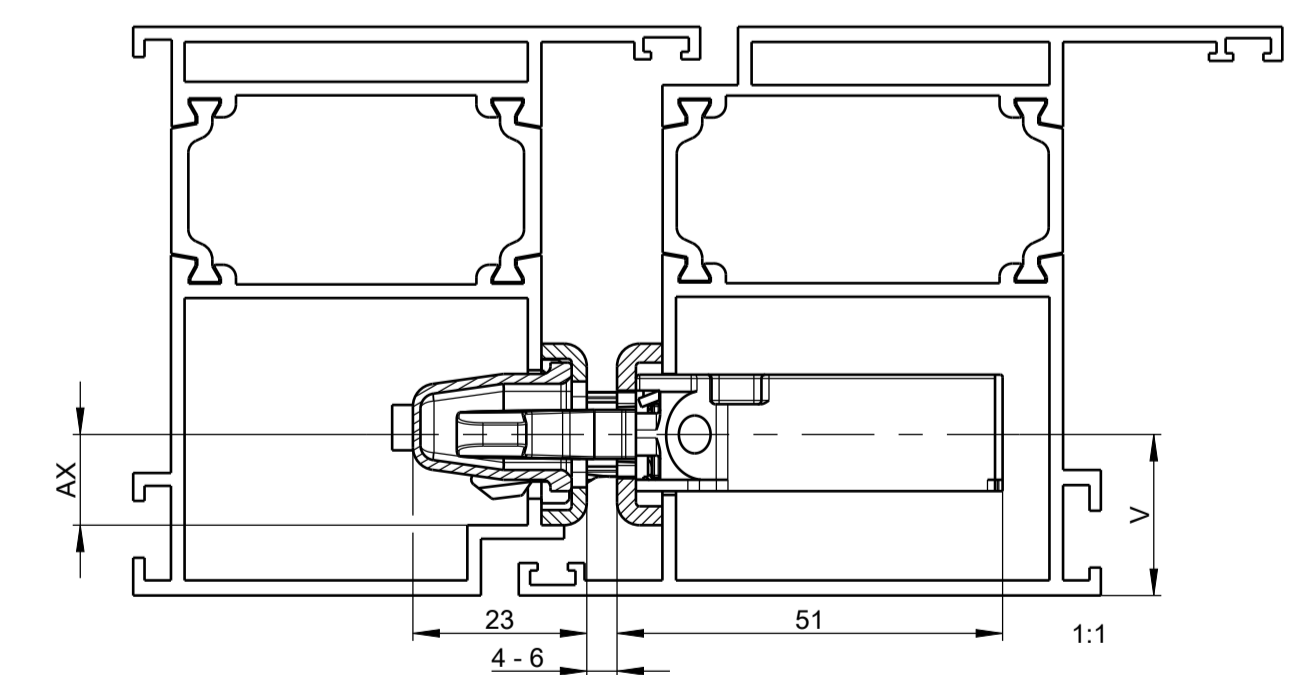

AX = axis
V = lock position (depending on profile)
Further sectional views refer to sheet 6

Sectional depiction of
multi-point locks

Electric strike

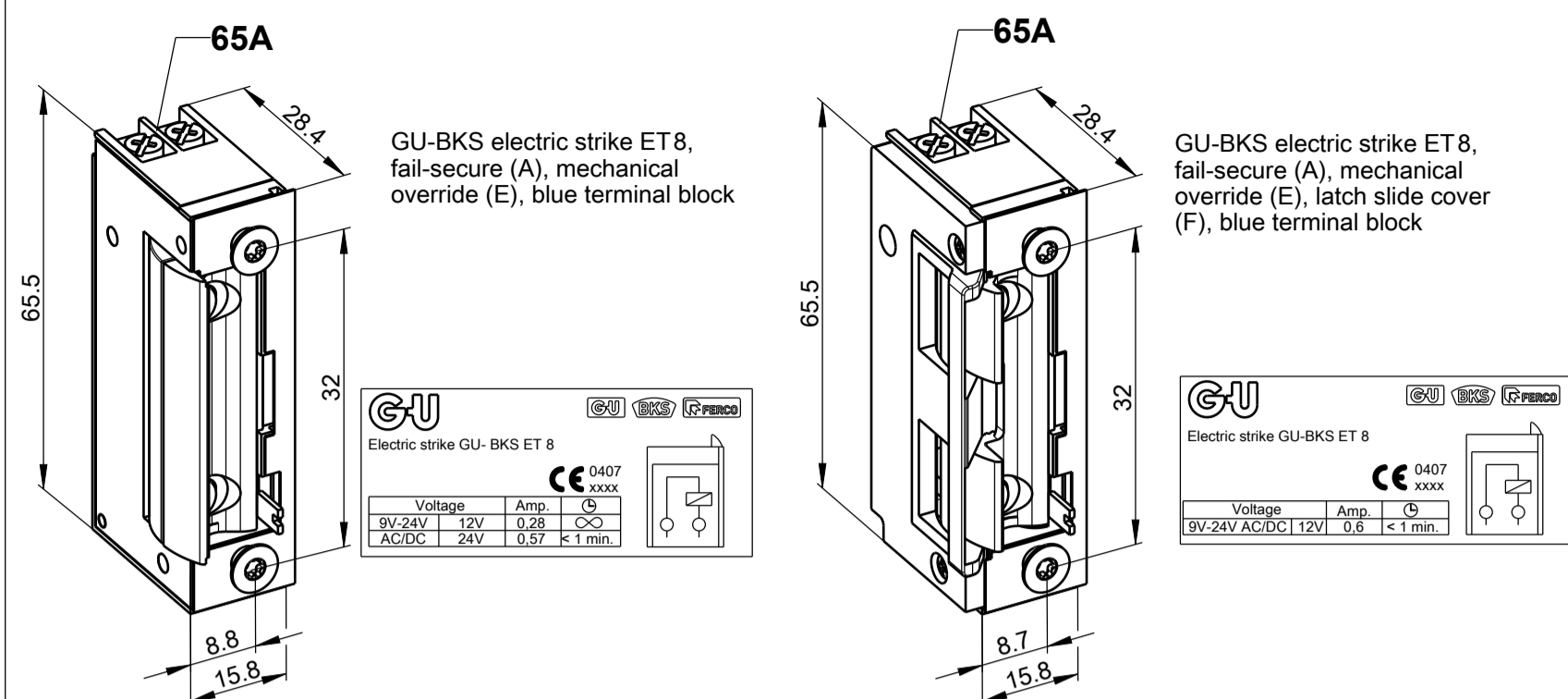

Frame milling for GU-BKS electric strike ET 8

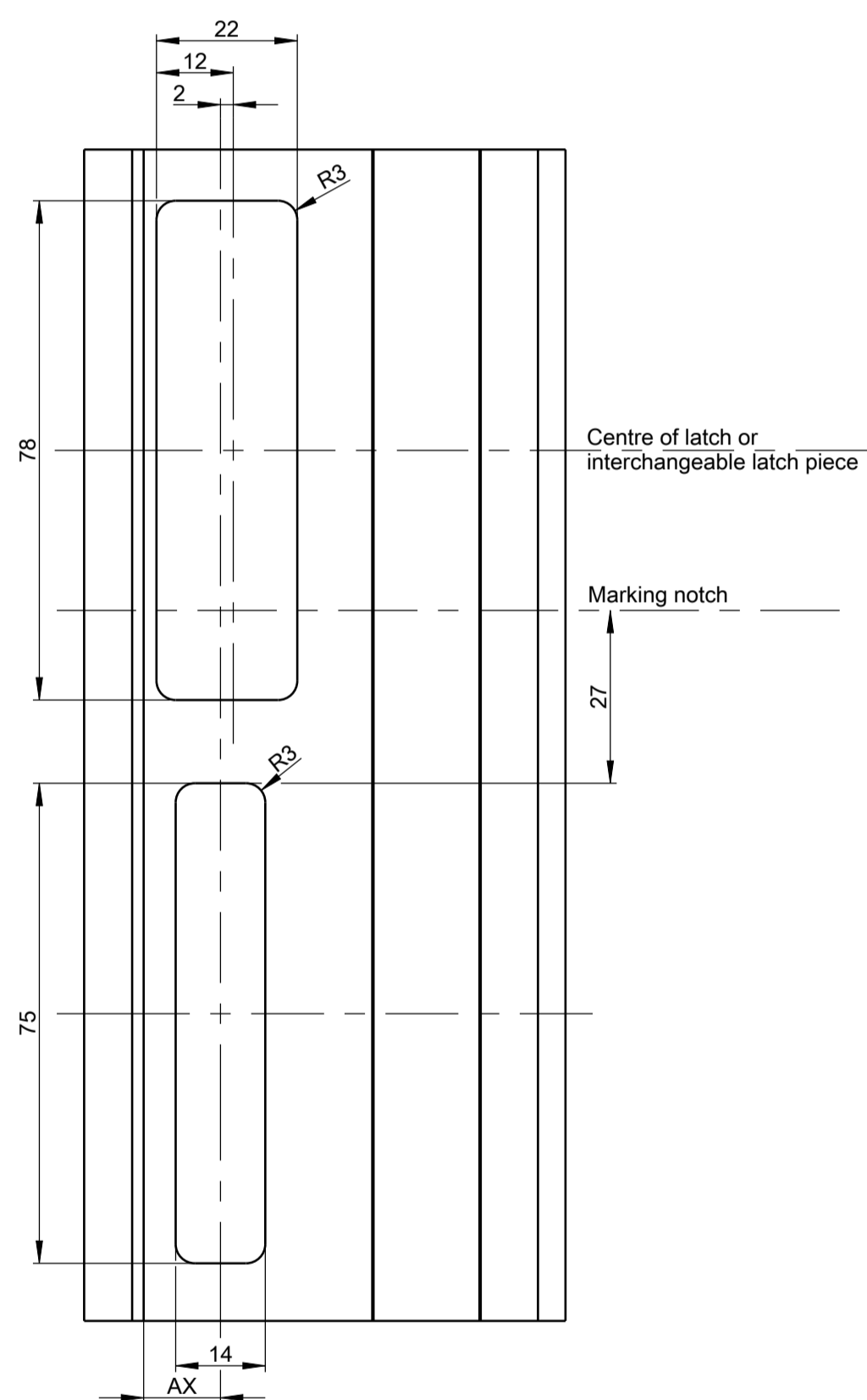

Lock case

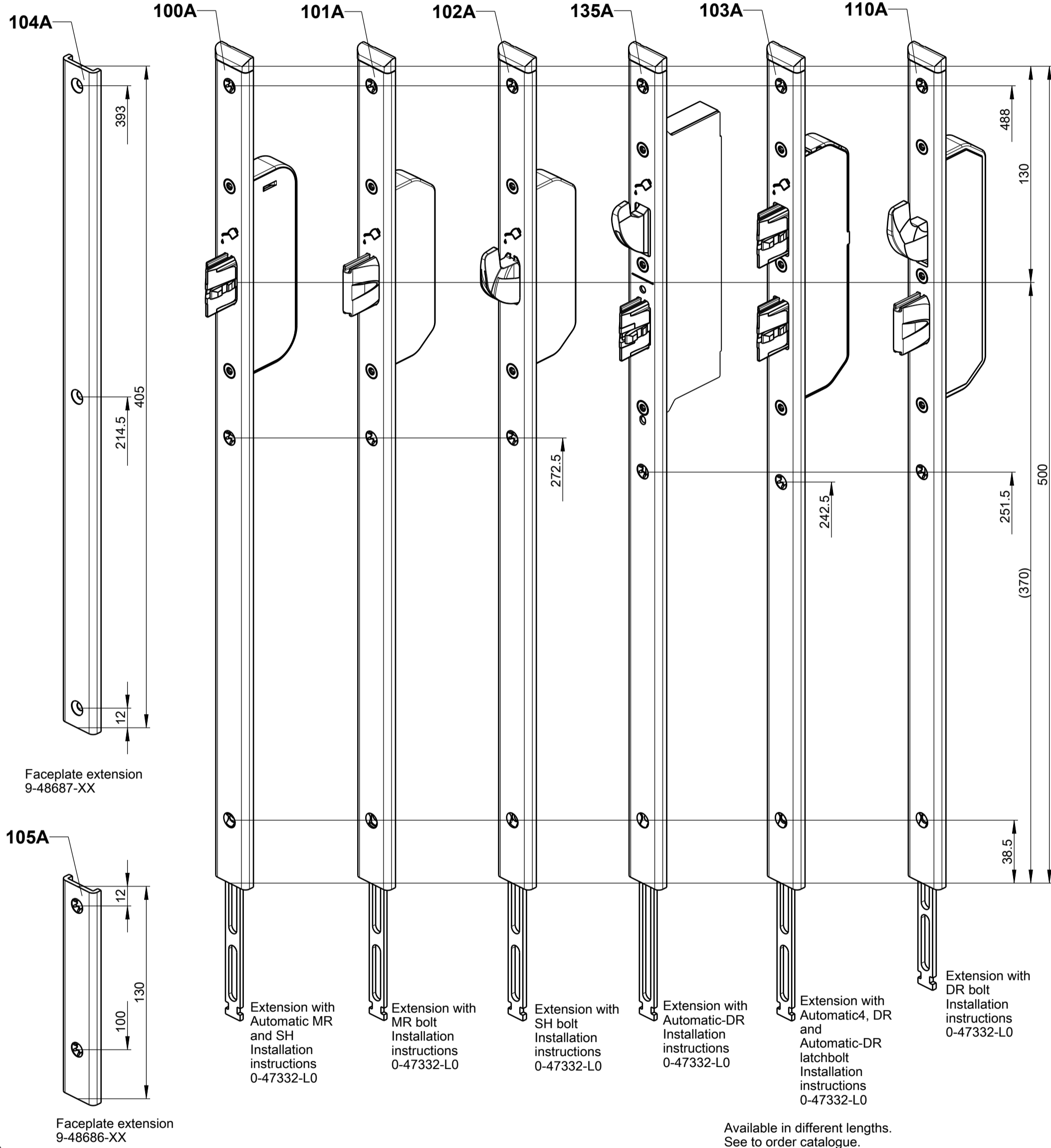
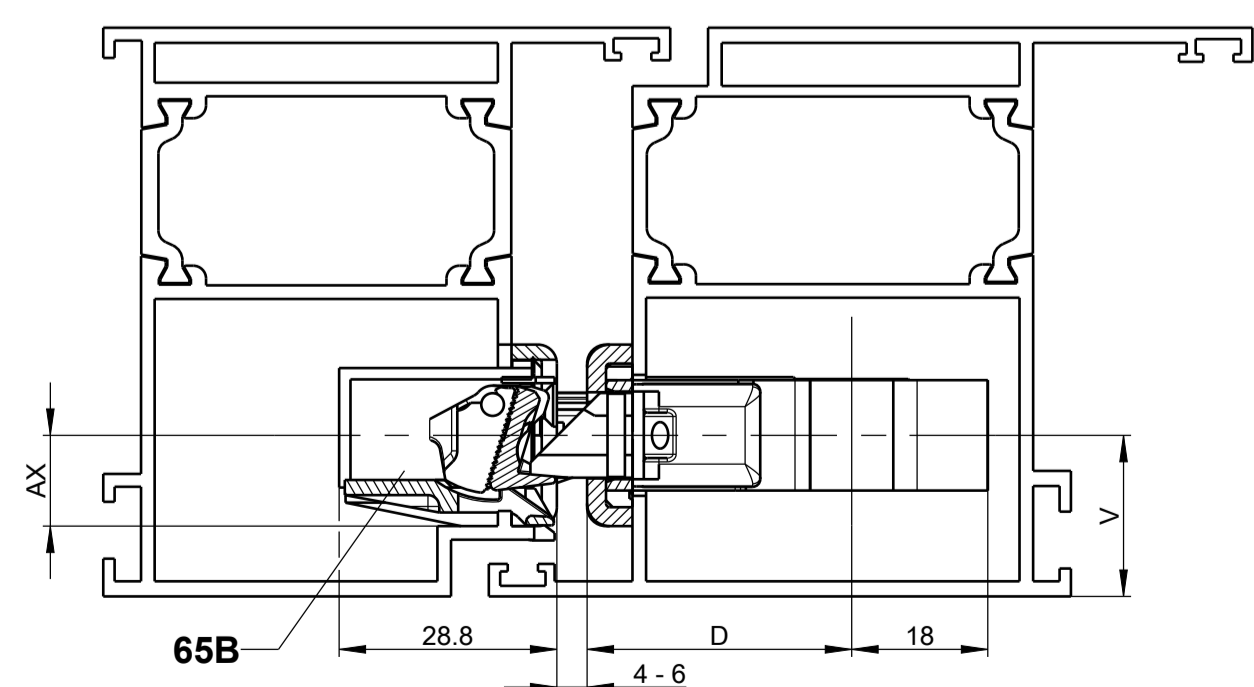

Hinge-side locking device

Adjustment information:
Install the wedged keeps as close as possible to the hinges. The toothed area of the drill-in cam must be set in parallel with that of the security plate (see sectional drawing on the right). Verify proper hardware functioning.

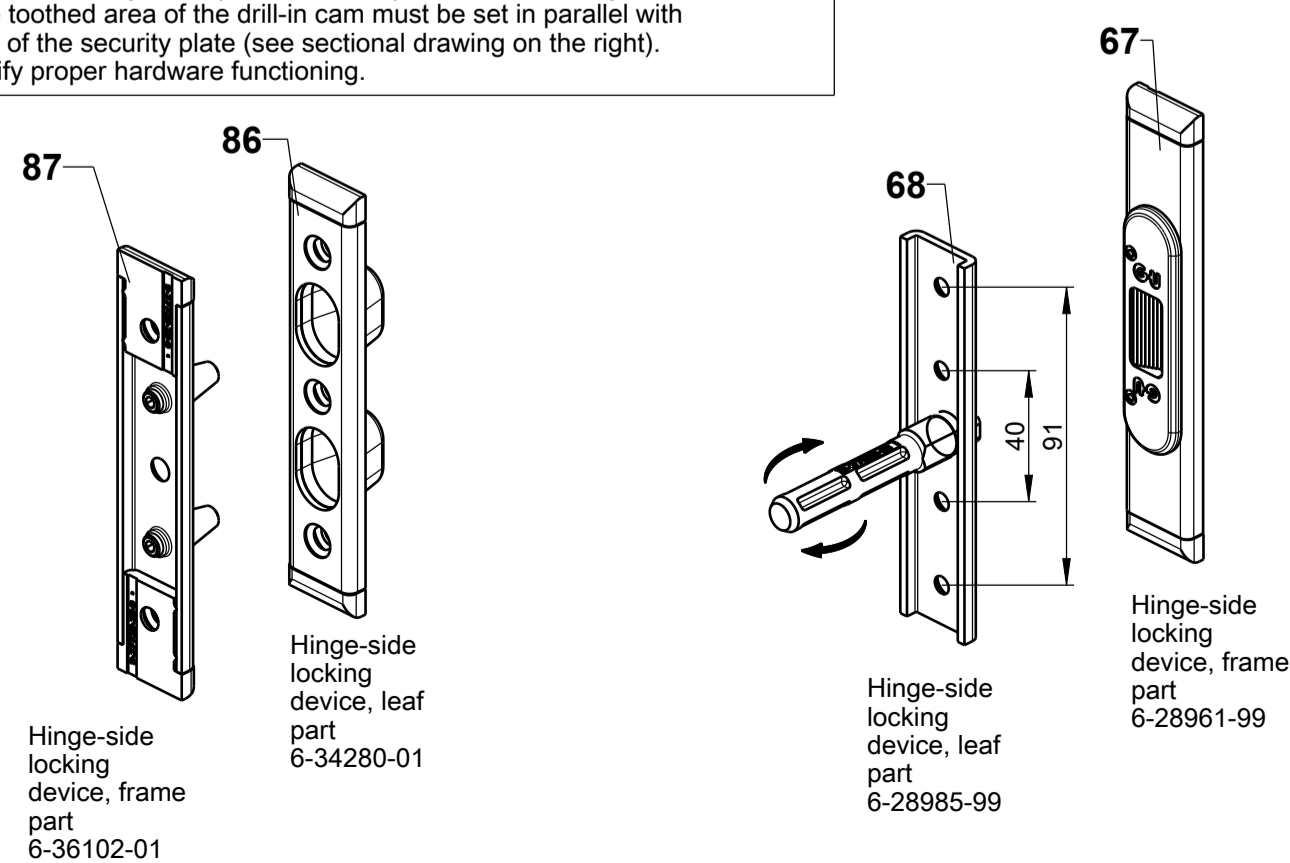

Hinge-side locking device

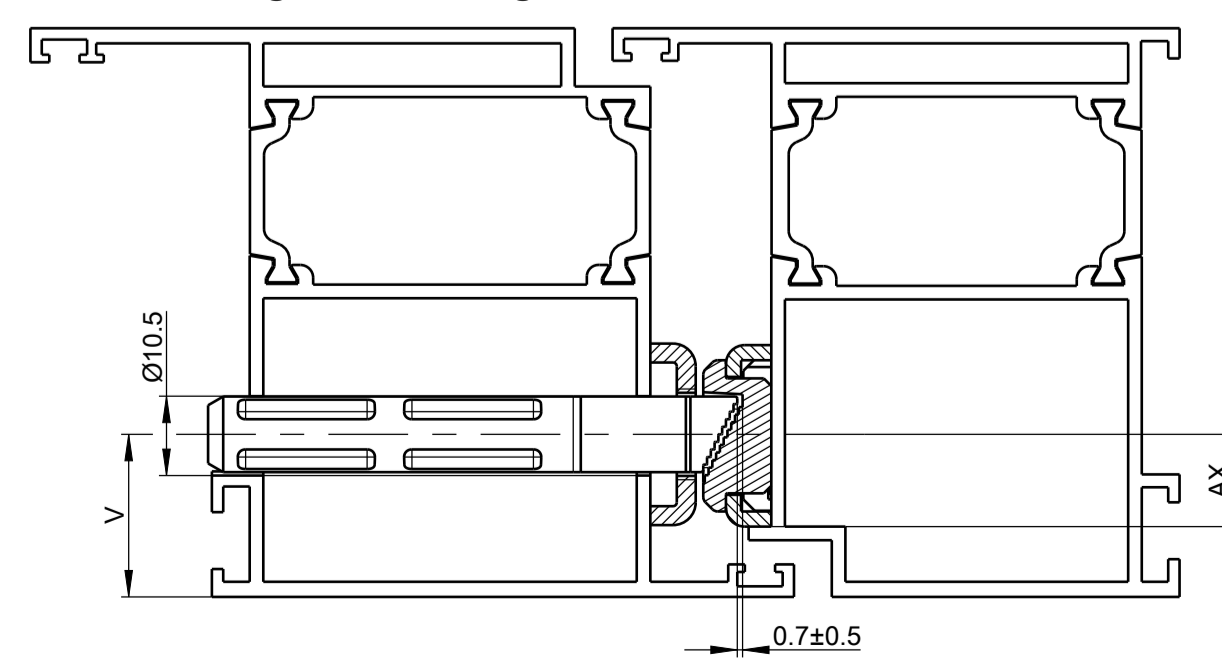

Cable duct

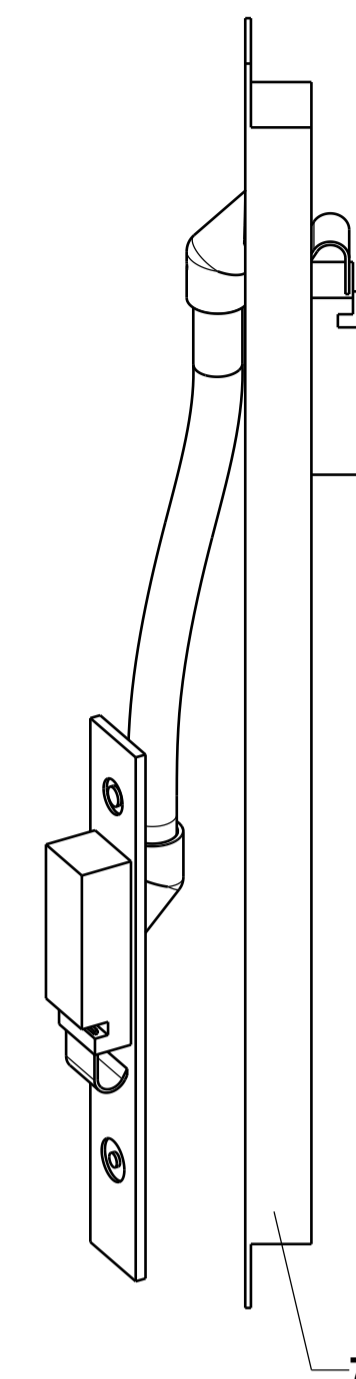

Detachable due to pluggable connector

Installation instructions: 0-45510-L0

See to order catalogue.

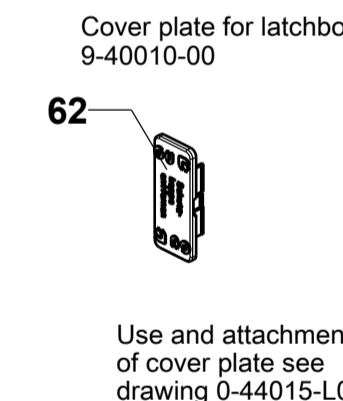
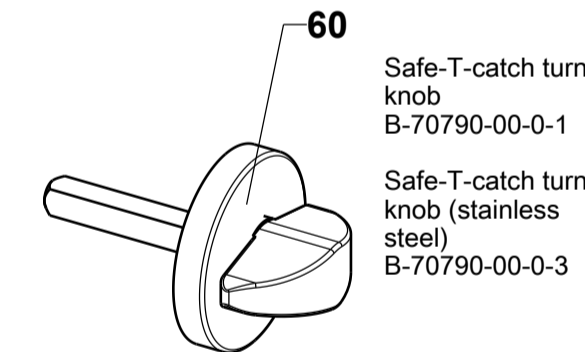
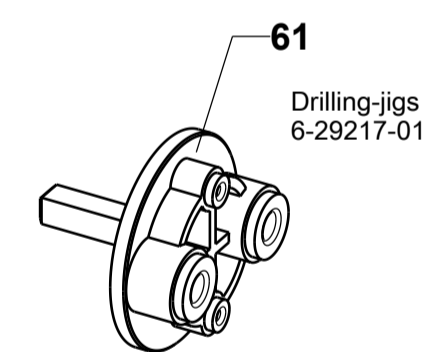

SECUREconnect

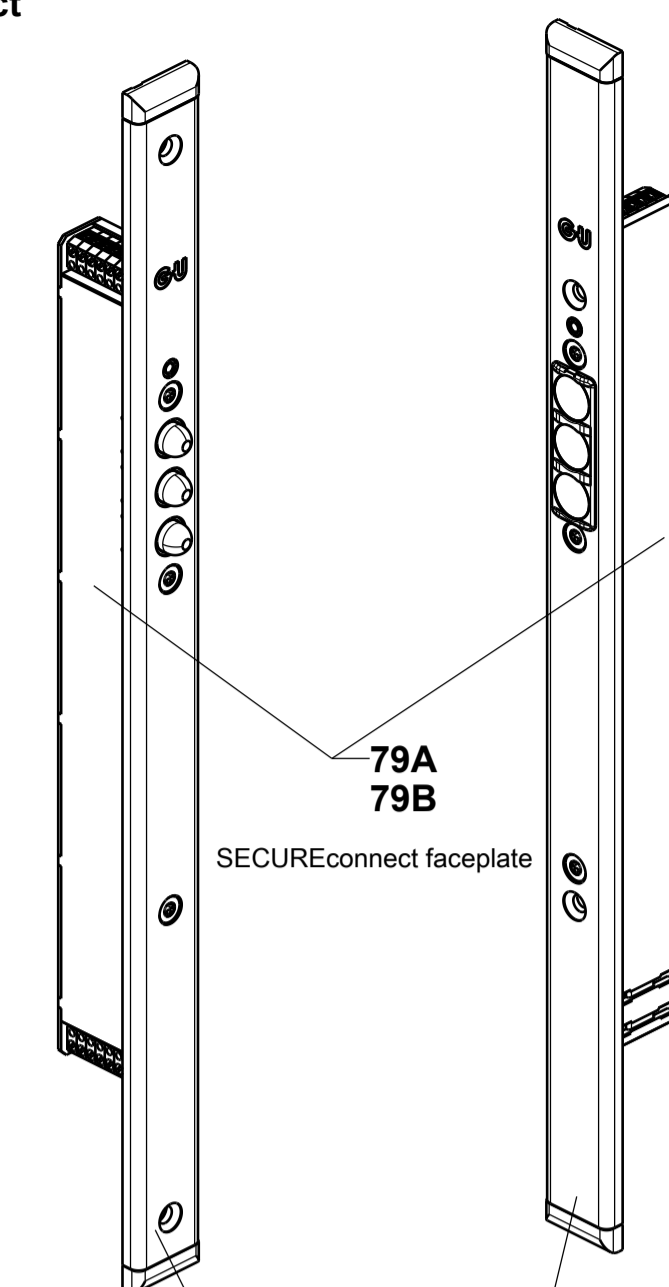

Operating instructions: 0-45654-L0

Installation instructions: 0-45733-L0

with integrated power supply unit

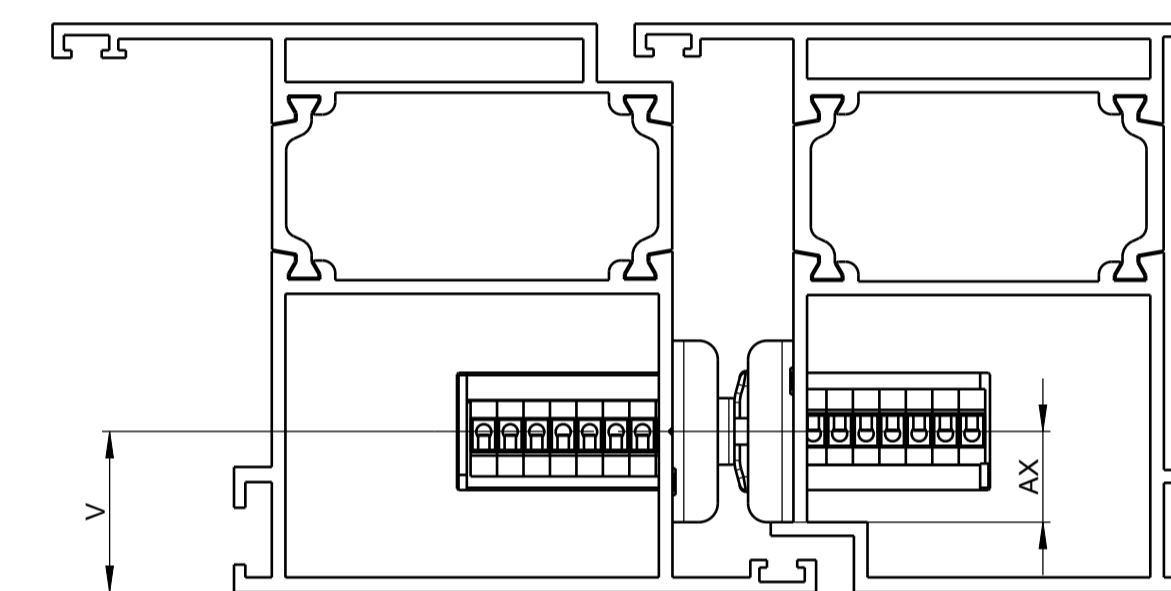

See to order catalogue.

House entrance door hinge

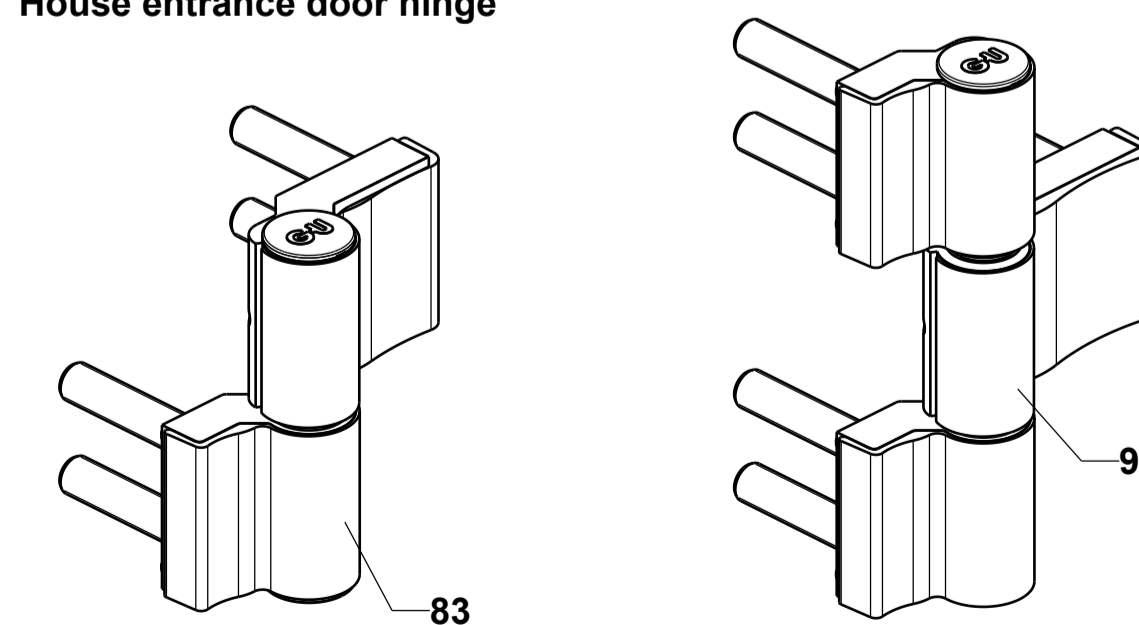

See to order catalogue.

AX = axis
V = lock position (depending on profile)

Accessories

Description:
GU-BKS door lock
Neutral aluminium and narrow stile systems