

1-leaf panic/emergency door			
Item	Description	Part no.	Remark
6H	Multi-point lock SECURY ePOWER PT1 SH3, function T, outward	K-19654-99	Flat faceplate = 24 x 3 U-faceplate = 24 x 6 Backset BS = 35, 40, 45 Hole distance HD = 92 (PC) Hole distance HD = 94 (RC) Follower □9 DLH
8.1A	Latch&deadbolt striker with ILP, height 6 or 8 mm 24 x 3	See order catalogue	
9.1A	Striker without adjustment SH striker with concealed adjustment	See order catalogue	
123A	Contact plate	See order catalogue	

Accessories			
Item	Description	Part no.	Remark
65A	Electric strike GU-BKS ET 8		
77	Cable link, detachable, concealed	See order catalogue	
78	Cable link, accessories		
79A	SECUREconnect 200	B-55600-20-4-6	
80	SECUREconnect faceplate (frame-side) for PVC	6-35513-99	
81A	SECUREconnect faceplate	9-43903-99	
81B	SECUREconnect with controller and swarf guard	See order catalogue	
83	House entrance door hinge GU A 316 3D	H-0178X-00	
83A	House entrance door hinge GU R 8163	See order catalogue	
95A	Narrow stile lever set with rosettes (PC)	B-7203X-11	
95B	Push bar	B-74000-XX	
95C	Touch bar	B-7441X-XX	
95D	Electrically-locking Touch Bar EVT	B-7442X-XX	
104A	Top extension piece	9-48687-XX	
105A	Bottom extension piece	9-48686-XX	
106A	Split spindle	B-78430-XX	
106B	Split spindle	B-78430-XX	
106C	Split spindle	B-78430-XX	
106D	Split spindle (inward-opening)	B-78420-XX	
109A	Fixing screw	B-78500-XX	

**Attention!**  
The three-dimensional depictions of the hardware components are not true to scale.

The profile sections shown are non-committal suggestions.

**Attention!**  
For profile cylinders with 90° locking cam position: after the installation the cam must point to the hinge-side in key withdrawal position.  
With the key withdrawn, the locking cam position must comply with DIN 18252.

All conventional profile cylinders according to DIN 18252 can be used.  
(No freewheel cylinder required.)

The product guidelines of the profile manufacturer regarding construction, assembly, max. sash/leaf dimensions, max. sash/leaf weights and material qualities (e.g. linear profile expansion) are to be observed.

BS = Backset  
HD = Hole distance  
V = lock position (depending on profile)  
AX = axis

The responsibility for safe and durable hardware fastening lies with the door fabricator.

Use fixing screws max. Ø 4.2 to install the SECURY multi-point lock.

Use fixing screws max. Ø 4.5 to install SECURY accessories.

Do not use drilling screws to fasten the multi-point lock because drilling chips might enter the lock!

See installation and maintenance instructions: 0-48779-L0 and 0-47647-L0

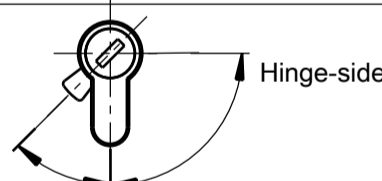
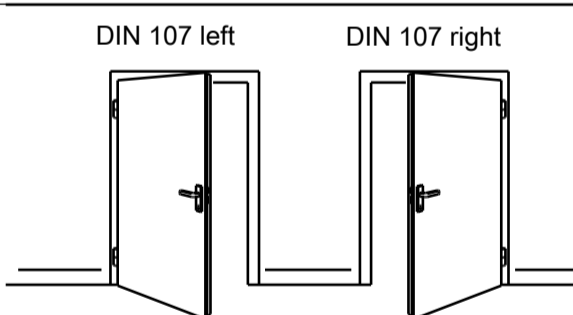
<p>The product guidelines of the profile manufacturer regarding construction, assembly, max. sash/leaf dimensions, max. sash/leaf weights and material qualities (e.g. linear profile expansion) are to be observed.</p> <p>For RC-tested elements, the additional locking elements and the lock case may have to be backfilled at the side and rear to absorb high forces. Depending on the profile system and material properties, the pressure-resistant backfill must be individually adapted.</p>	<p><b>Attention!</b></p> <p>The three-dimensional depictions of the hardware components are not true to scale.</p> <p># Drilling dimensions may vary with special locking point positions.</p>
<p>For mounting and operating a SECURY multi-point lock, the following advice must be observed:</p> <ol style="list-style-type: none"> <li>1. Installation according to GU drawing only.</li> <li>2. L&amp;D striker and strikers must be exactly aligned with each other.</li> <li>3. The use of latch&amp;deadbolt strikers with adjustable interchangeable latch piece is only permitted if adjustable strikers are used for the Automatic locking elements.</li> <li>4. If the interchangeable latch piece requires adjustment, the strikers must be justified accordingly.</li> <li>5. Ensure that the locking elements enter into the strikers freely.</li> <li>6. With the door open, it is possible to check the SECURY Automatic lock for proper functioning as follows: See installation and maintenance instructions.</li> <li>7. Use appropriate securing devices to transport the door.</li> </ol>	<p>Do not use drilling screws to fasten the multi-point lock because drilling chips might enter the lock!</p>
<p><b>Attention!</b></p> <p>For profile cylinders with 90° locking cam position: after the installation the cam must point to the hinge-side. With the key withdrawn, the locking cam position must comply with DIN 18252.</p>  <p>Hinge-side</p>  <p>DIN 107 left    DIN 107 right</p>	<p>BS = Backset HD = Hole distance V = lock position (depending on profile) AX = axis</p>
<p>- Use fixing screws max. Ø 4.2 to install GU-SECURY multi-point lock.</p> <p>- Use fixing screws max. Ø 4.5 to install GU-SECURY accessories.</p> <p>The responsibility for safe and durable hardware fastening lies with the door fabricator.</p>	<p>For optimal hardware fixing we recommend the use of rivet nuts.</p>

<b>Sheet 2</b>	SECURY system technology L = 1750
<b>Sheet 3</b>	Motor-driven multi-point lock
<b>Sheet 4</b>	Release motor Locking motor Electric strike
<b>Sheet 5</b>	Accessories

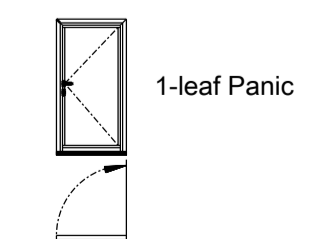
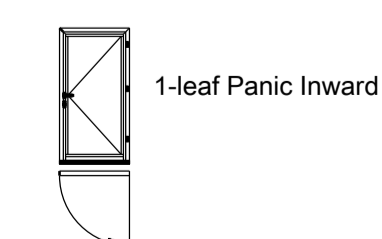

XX Size depending on profile, refer to GU order catalogue.

**Parts list**

Description: Multi-point lock SECURY ePOWER according to EN 179 and EN 1125 Neutral PVC profiles											
GU	Date	Change No.	Sig	Ver.	Replacement for	Revision	Iteration	Level	Scale	Drawing No.	Size
	04.10.2022	G40069	Ei	Na	--	3	4	Released	1:1	0-47439-L0-EN	A1 1/6

65A  
Optionally with item 8.1A

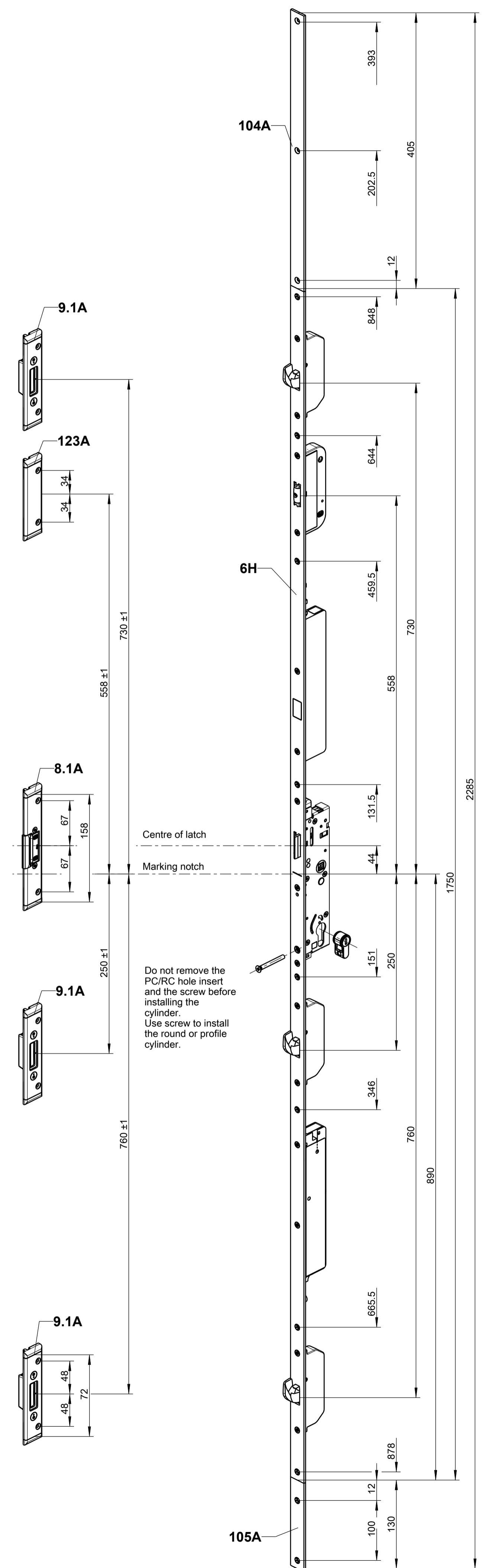

⚠ Attention!  
During installation, ensure that the wiring is not damaged by sharp edges.

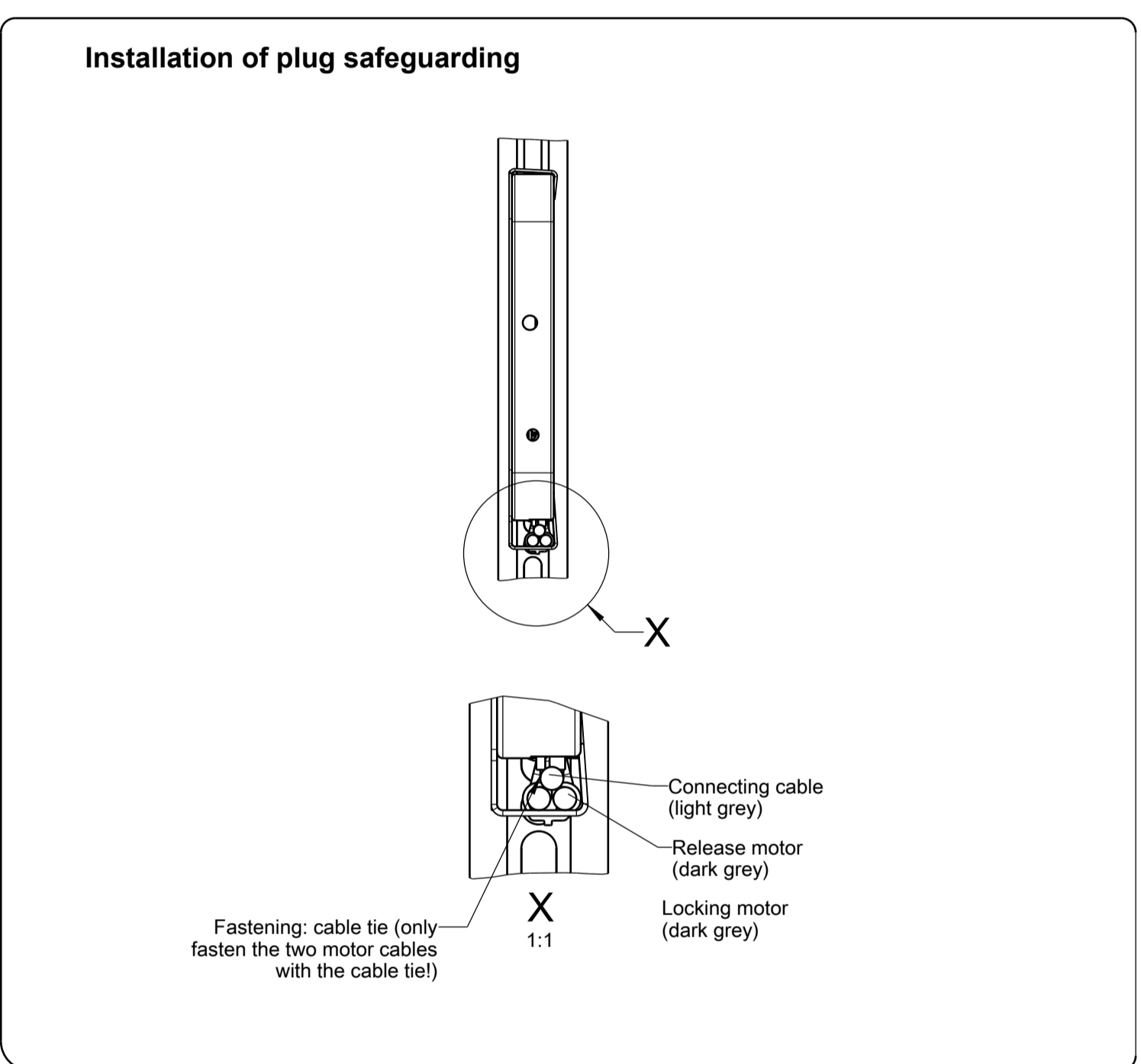
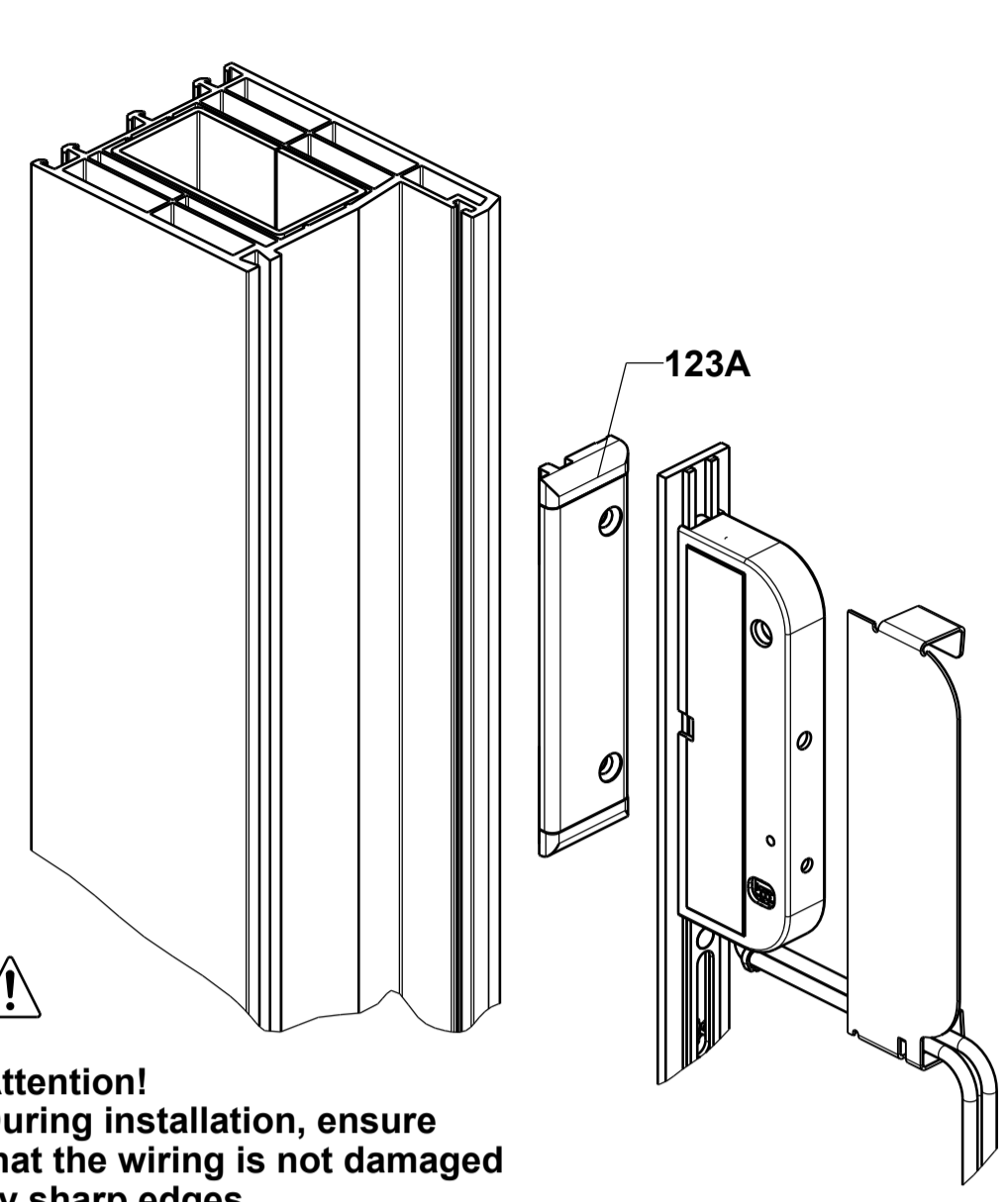

2 and 3  
Connection of release and locking motor

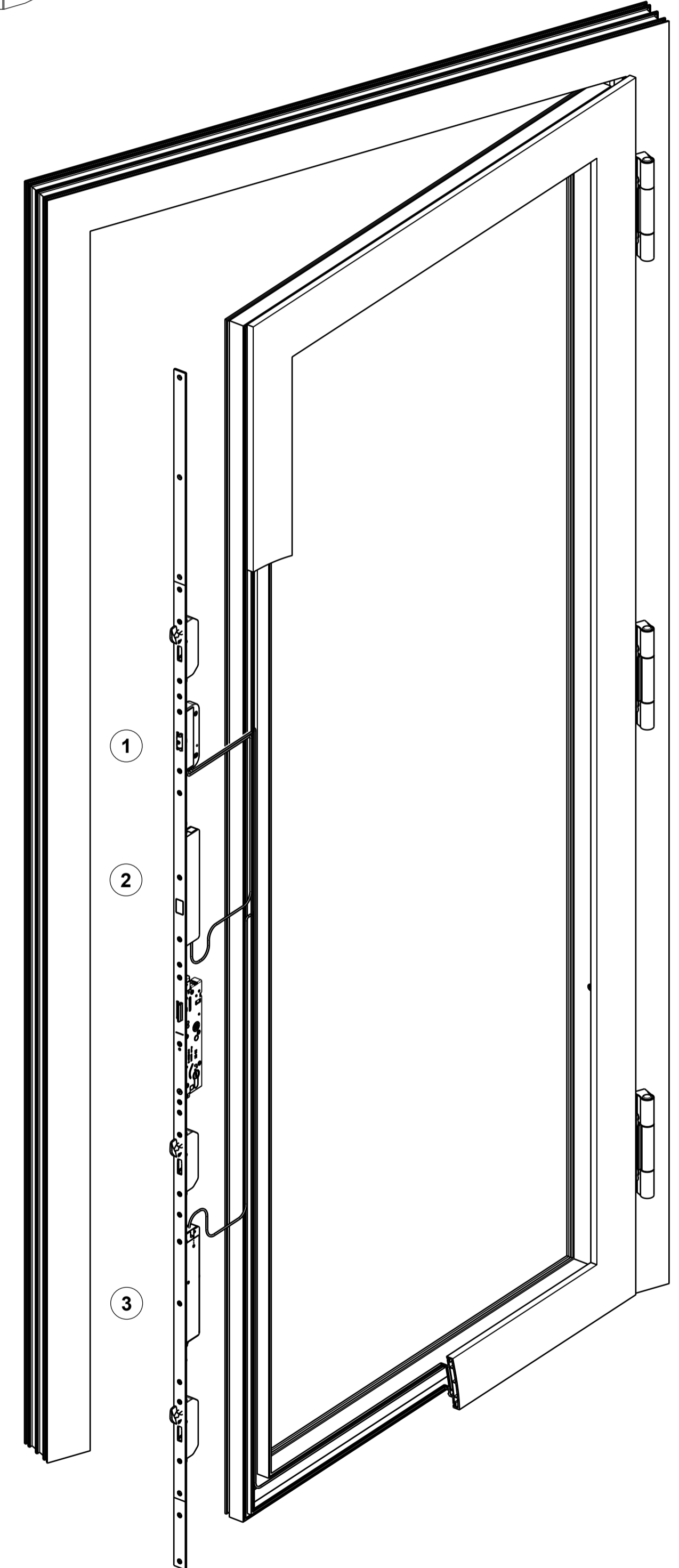
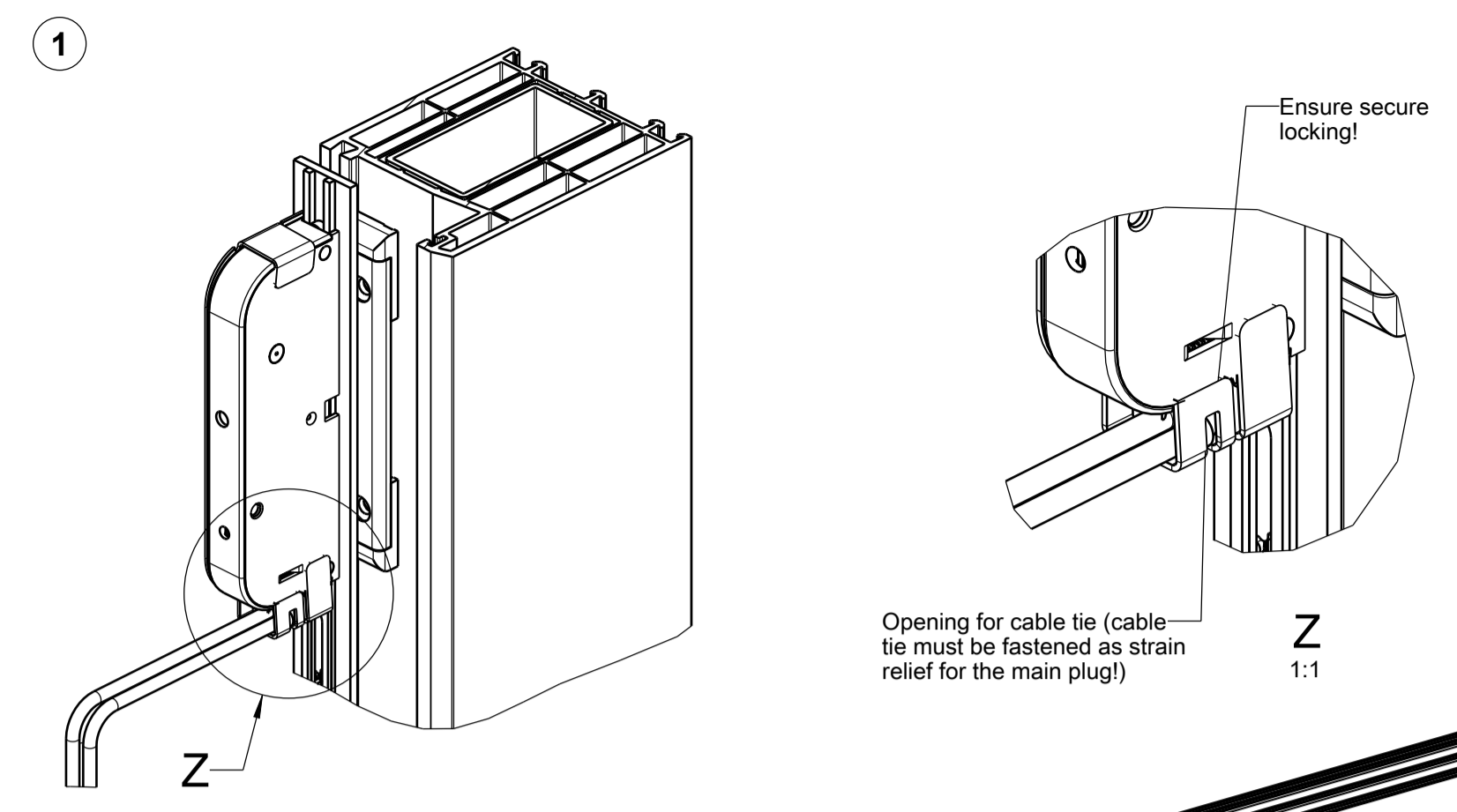
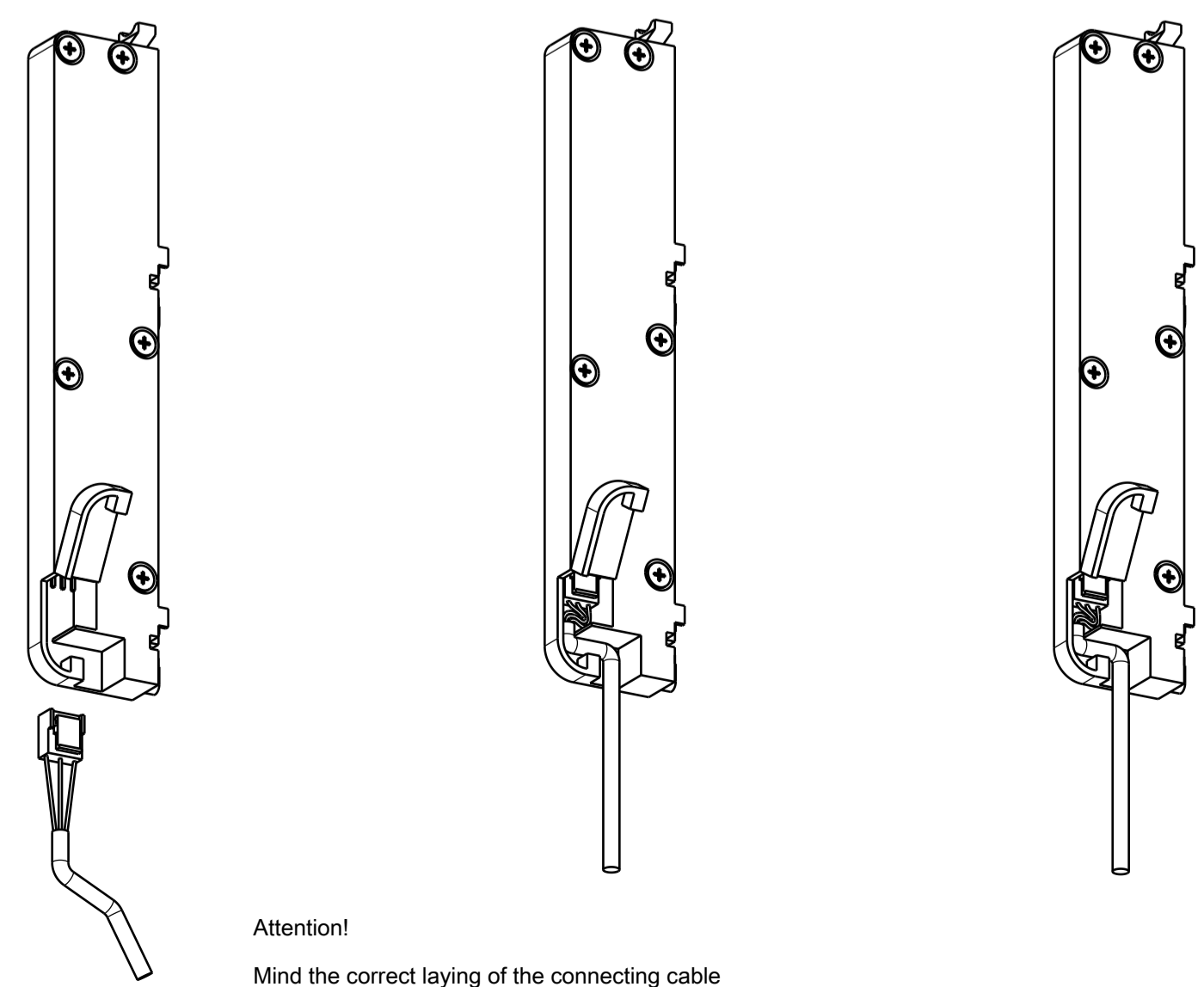

Depicted in drawing:  
Faceplate = 24 x 3, AX = 13  
Accessories: 30 x 5  
Installation and operating instructions: 0-47647

SECURITY system technology  
L = 1750

Frame milling for striker

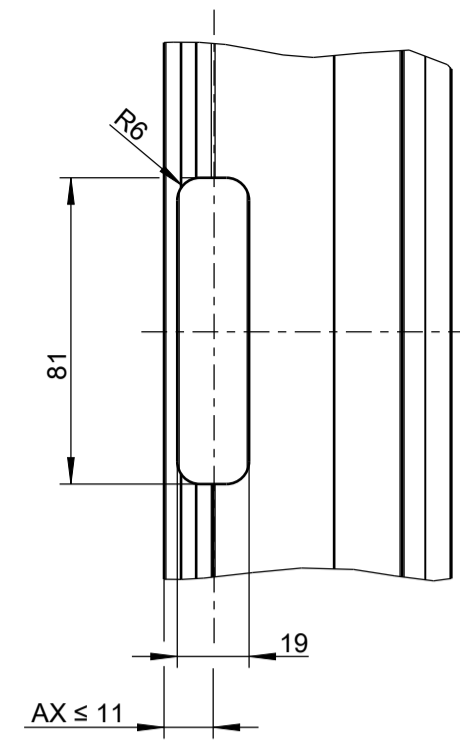

Hook bolt

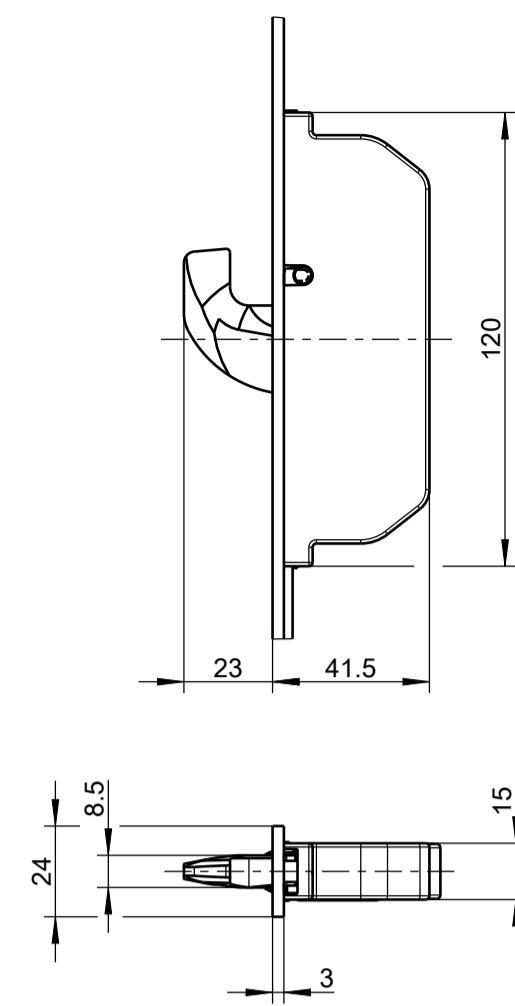

Leaf milling for hook bolt

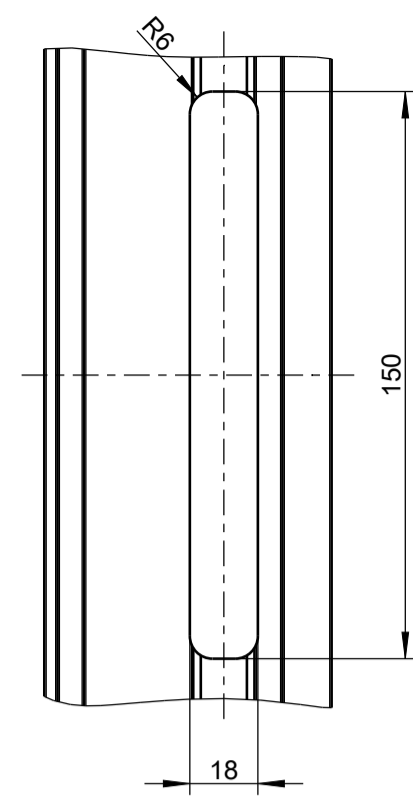

Control unit

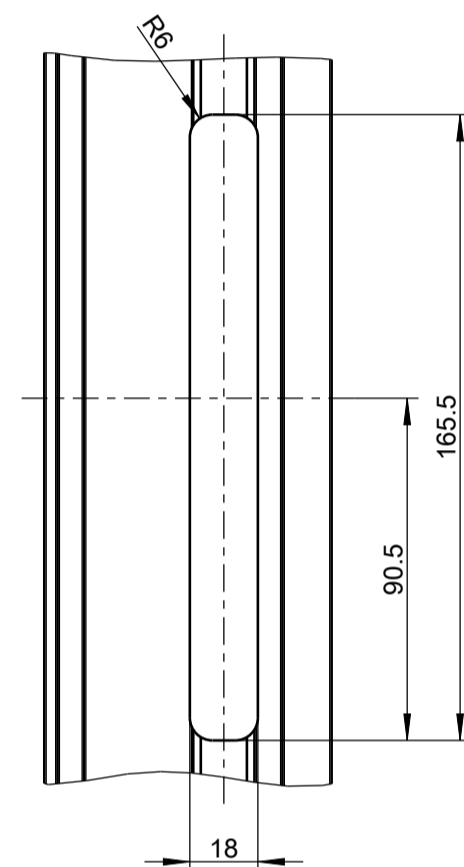
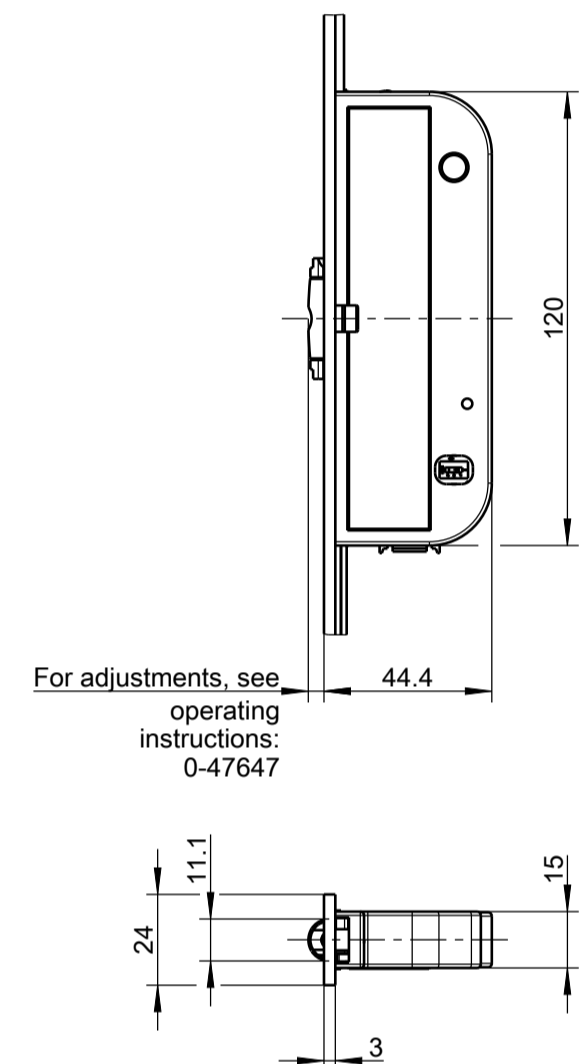

Hook bolt Striker

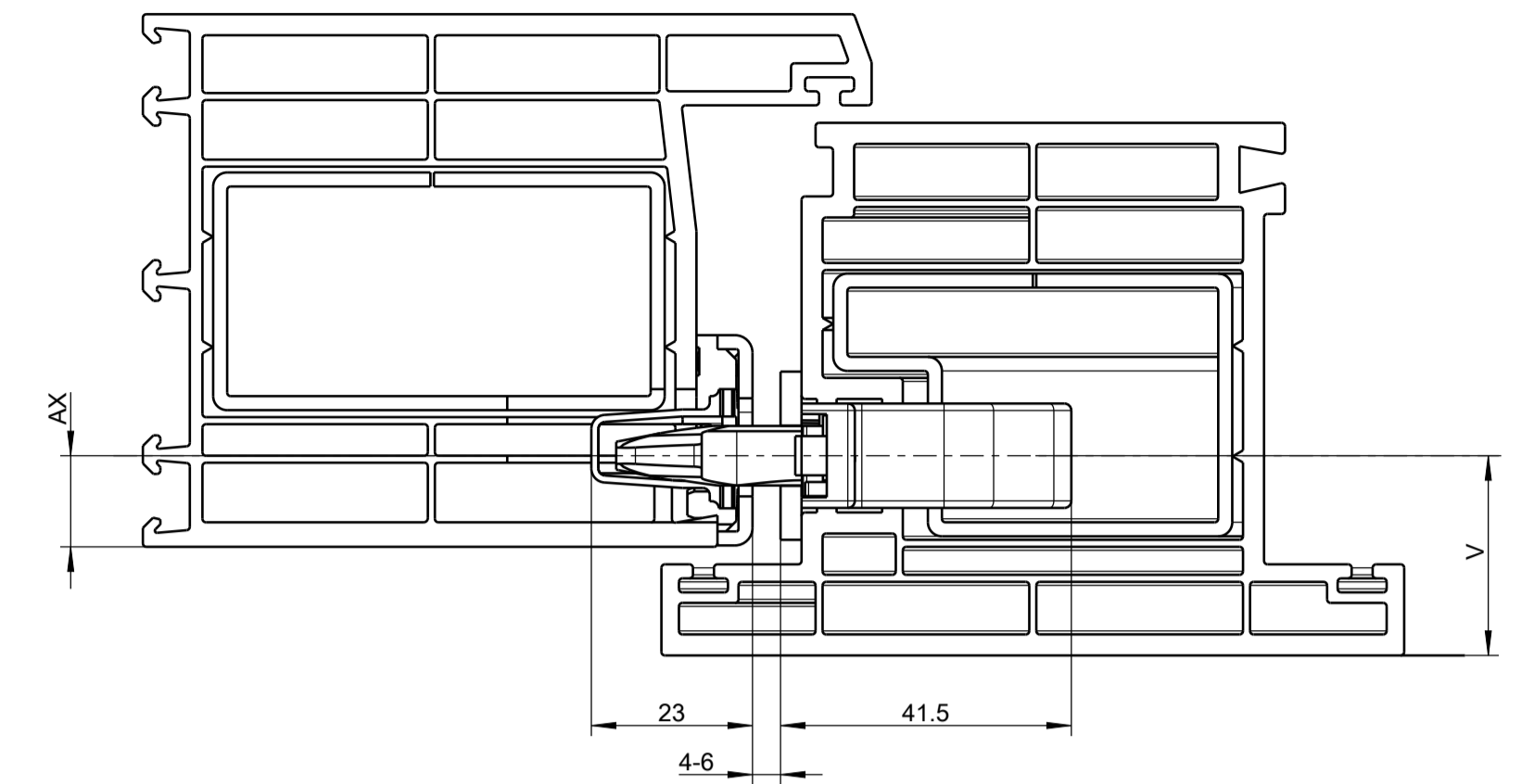

Control unit Contact plate

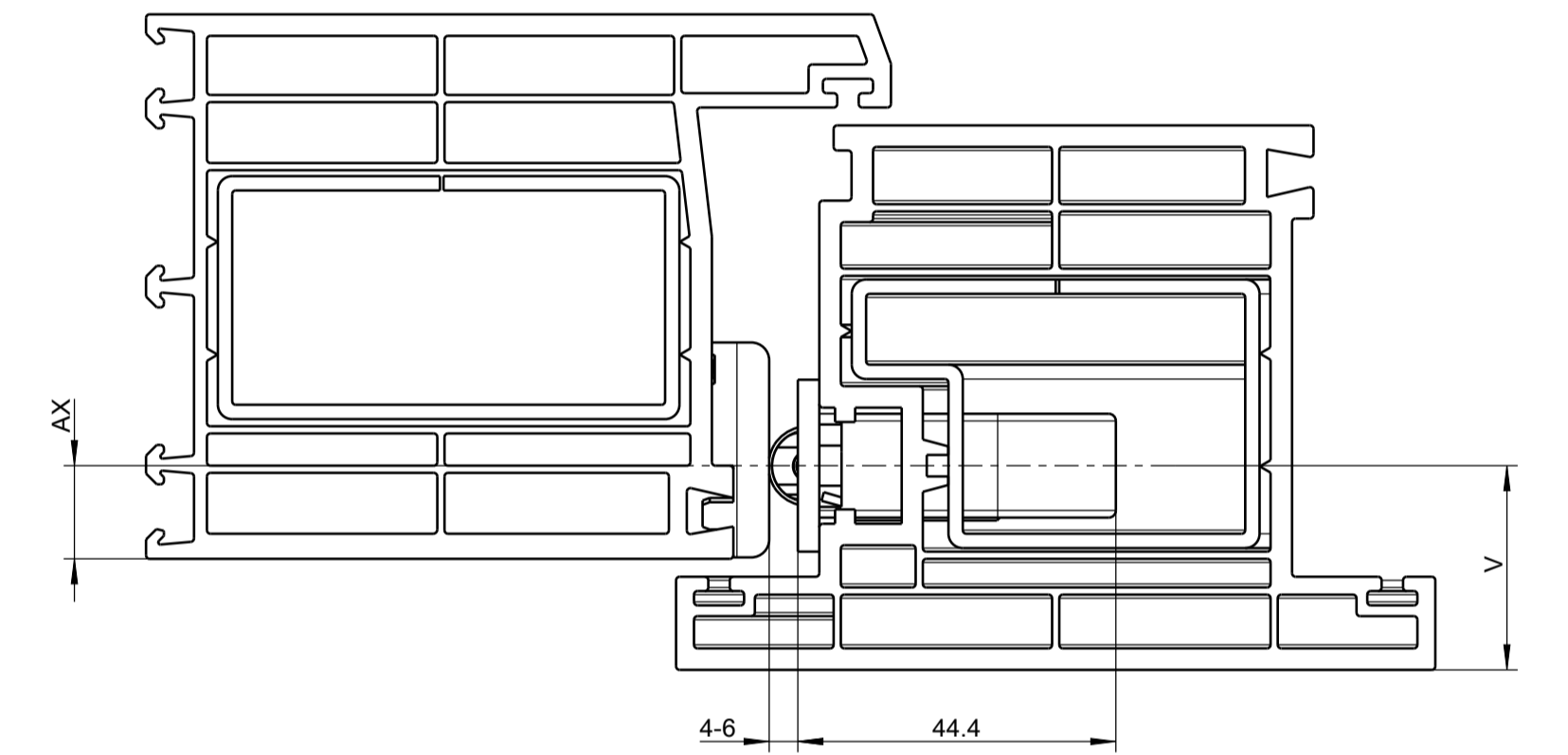

Frame milling for L&D striker

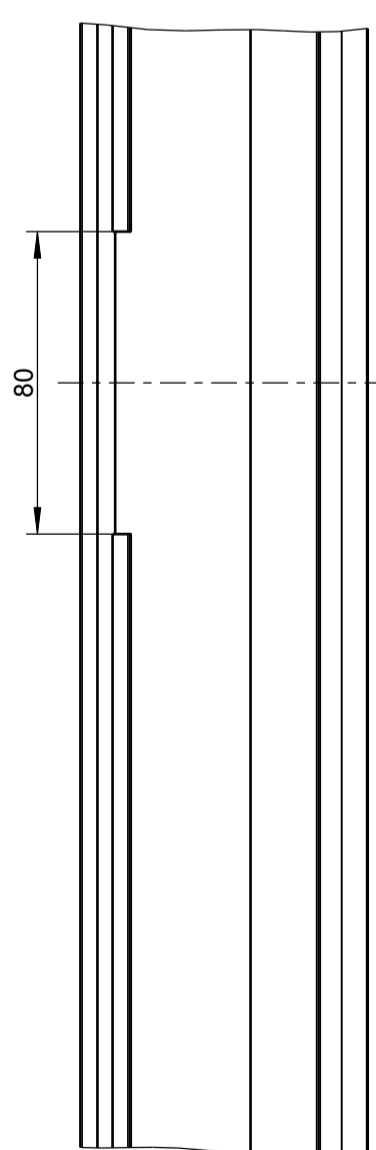

Lock case with PC hole

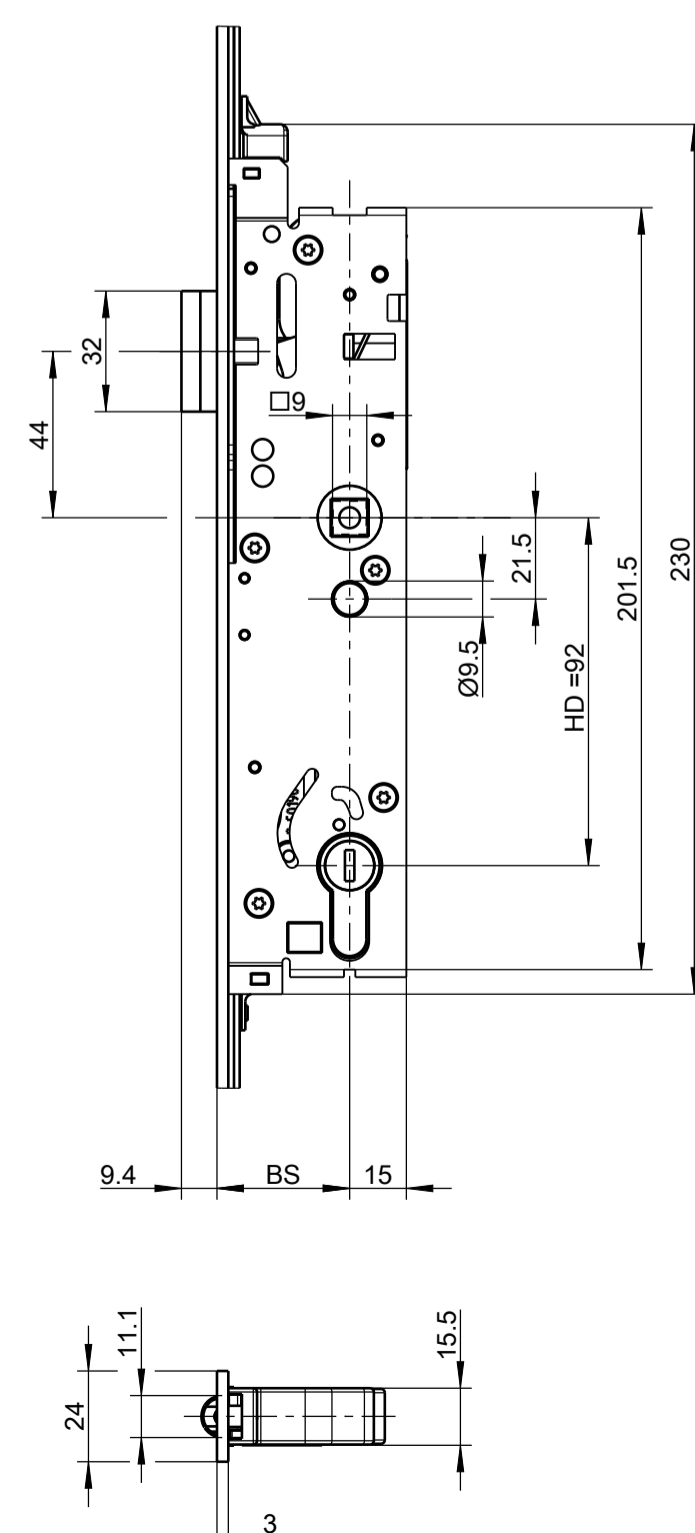

Lock case with RC hole

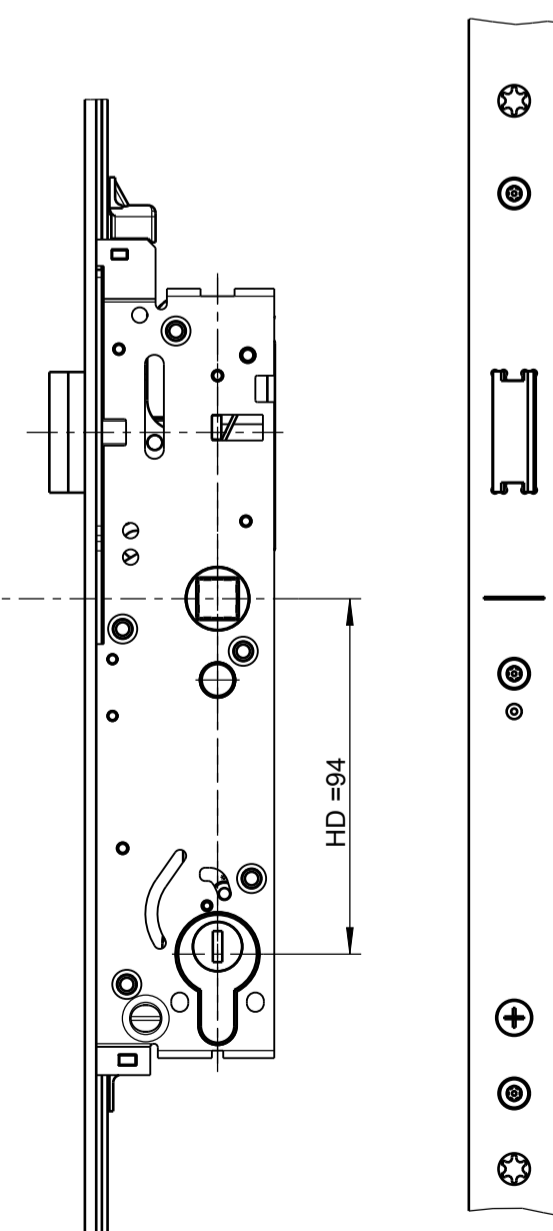

Leaf milling for lock case

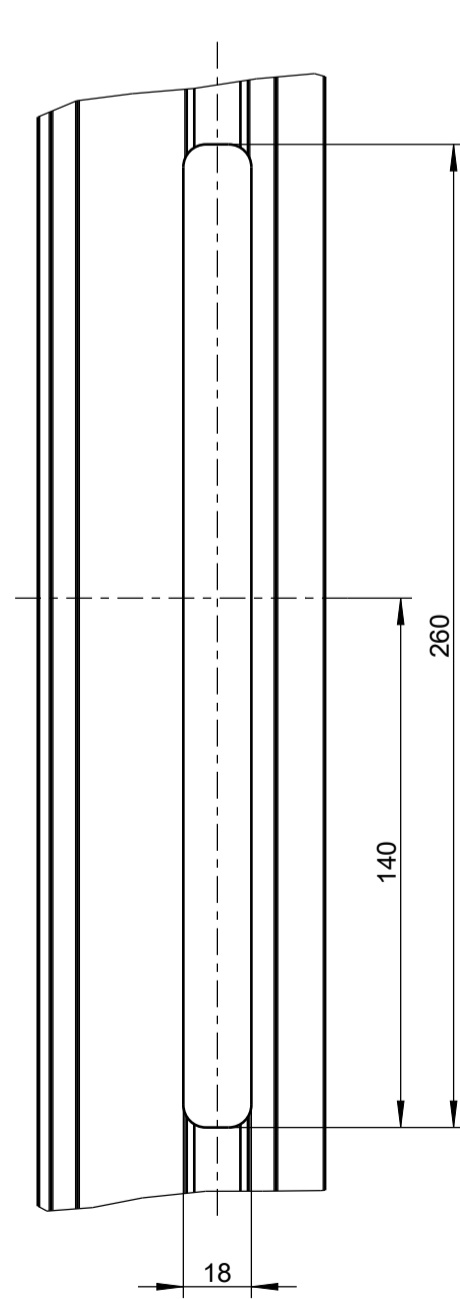

Leaf milling for PC hole

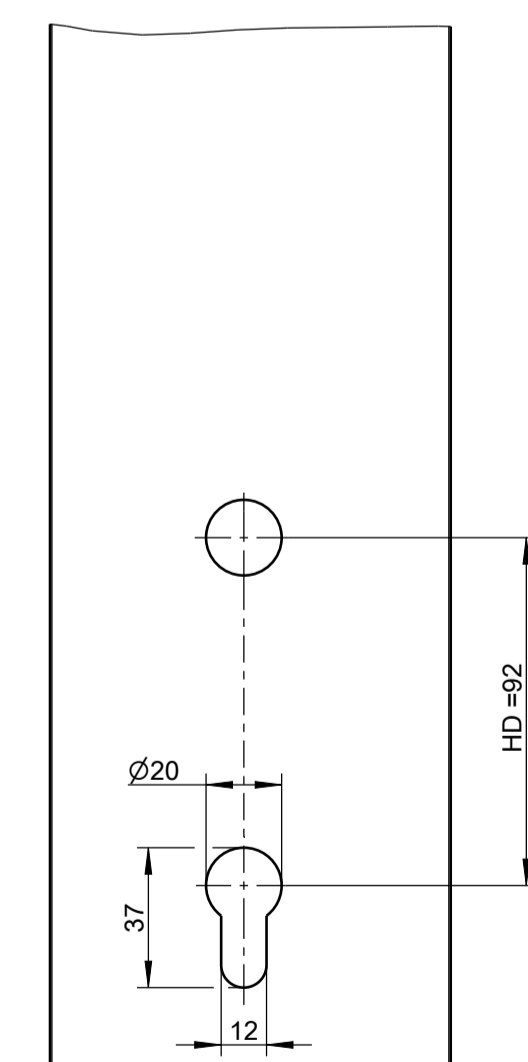

Leaf milling for RC hole

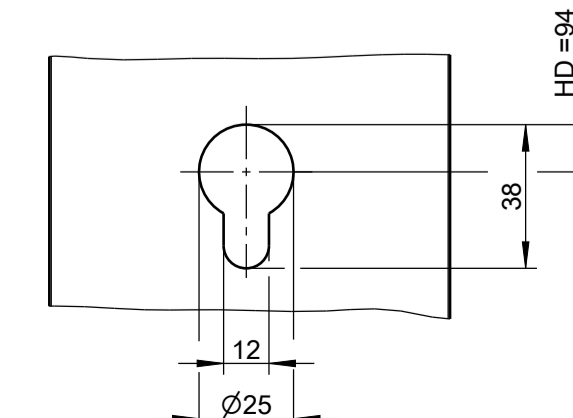

Lock case

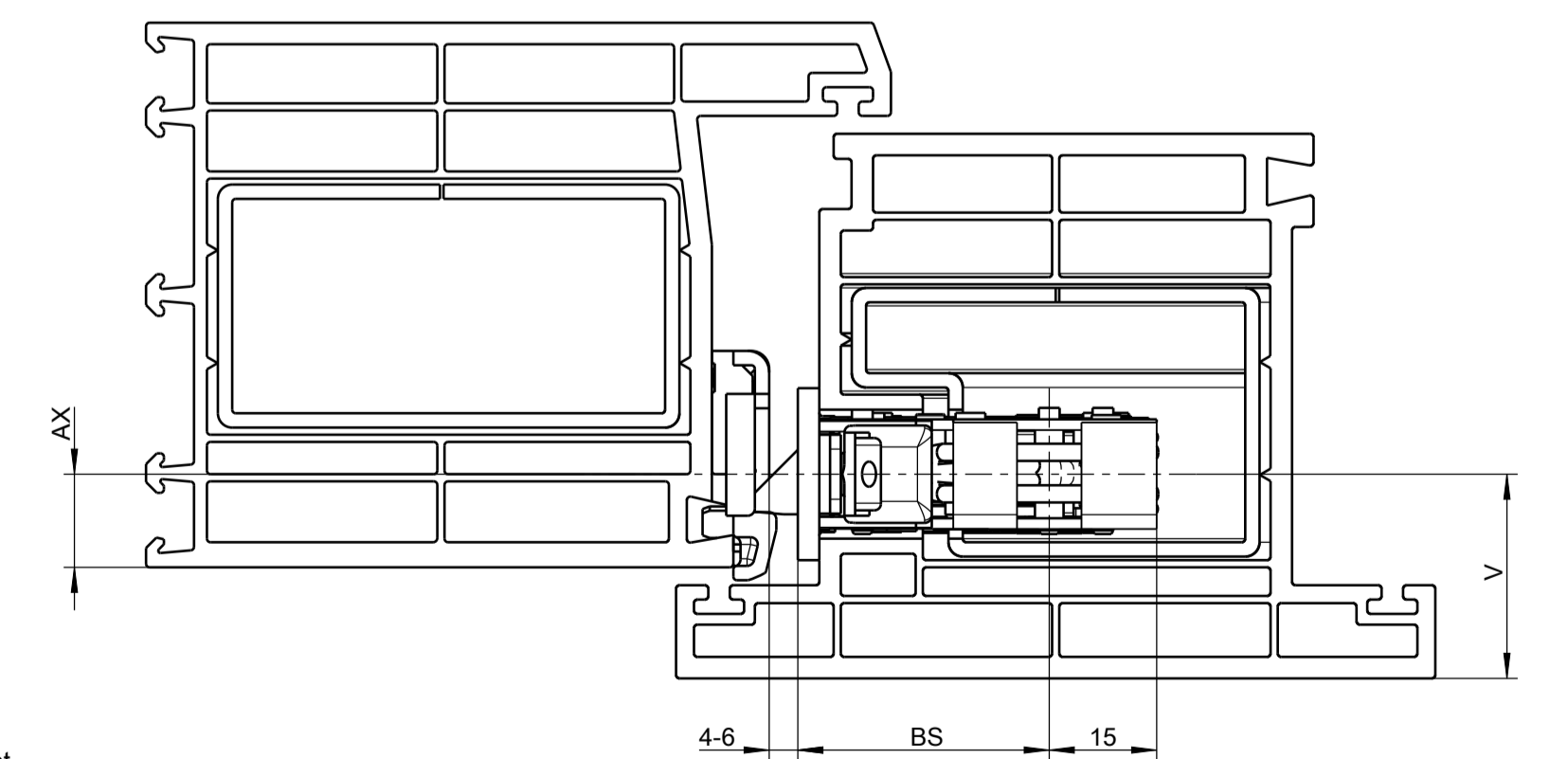

BS = Backset  
HD = Hole distance  
V = lock position (depending on profile)  
AX = Axis

Depicted in drawing:  
Faceplate = 24 x 3, AX = 13  
Accessories: 30 x 5

Installation and operating instructions: 0-47647

Sectional views of multi-point locks

Frame milling for GU-BKS electric strike ET 8

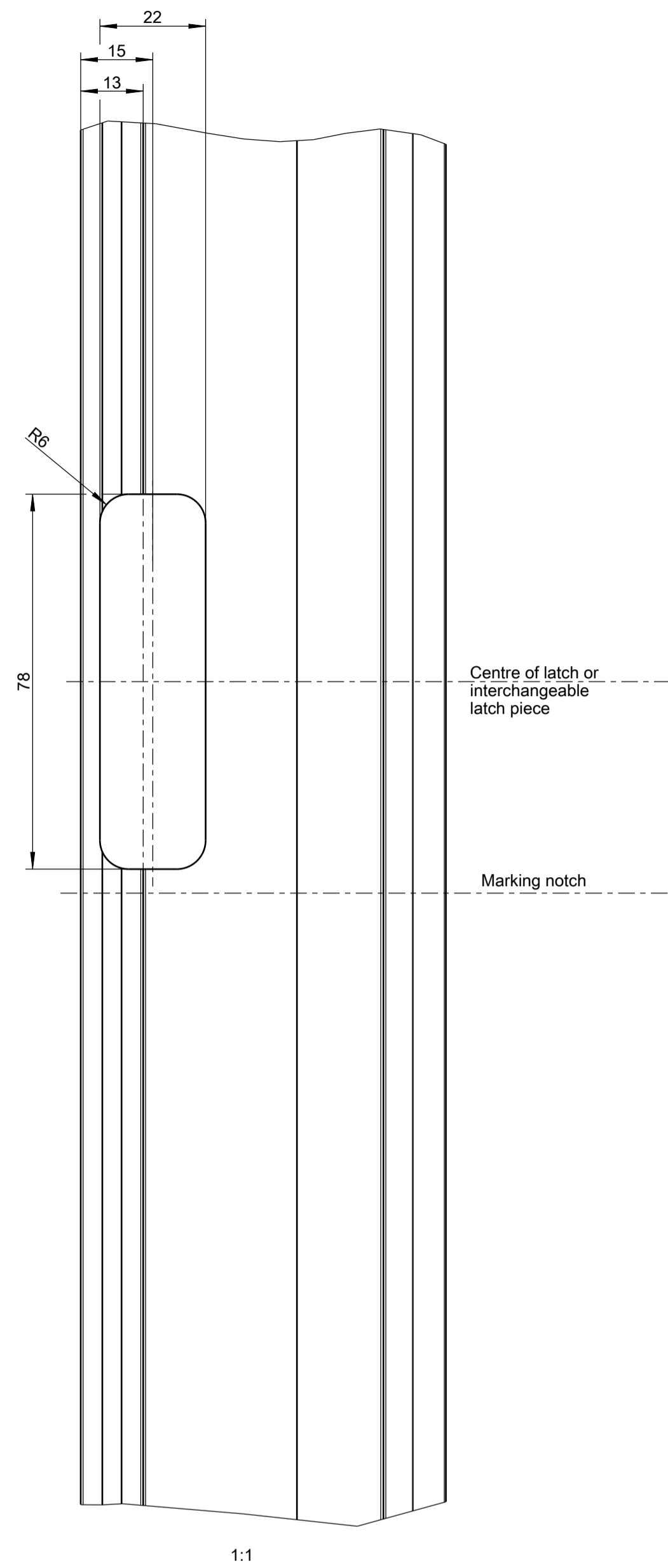

Lock case

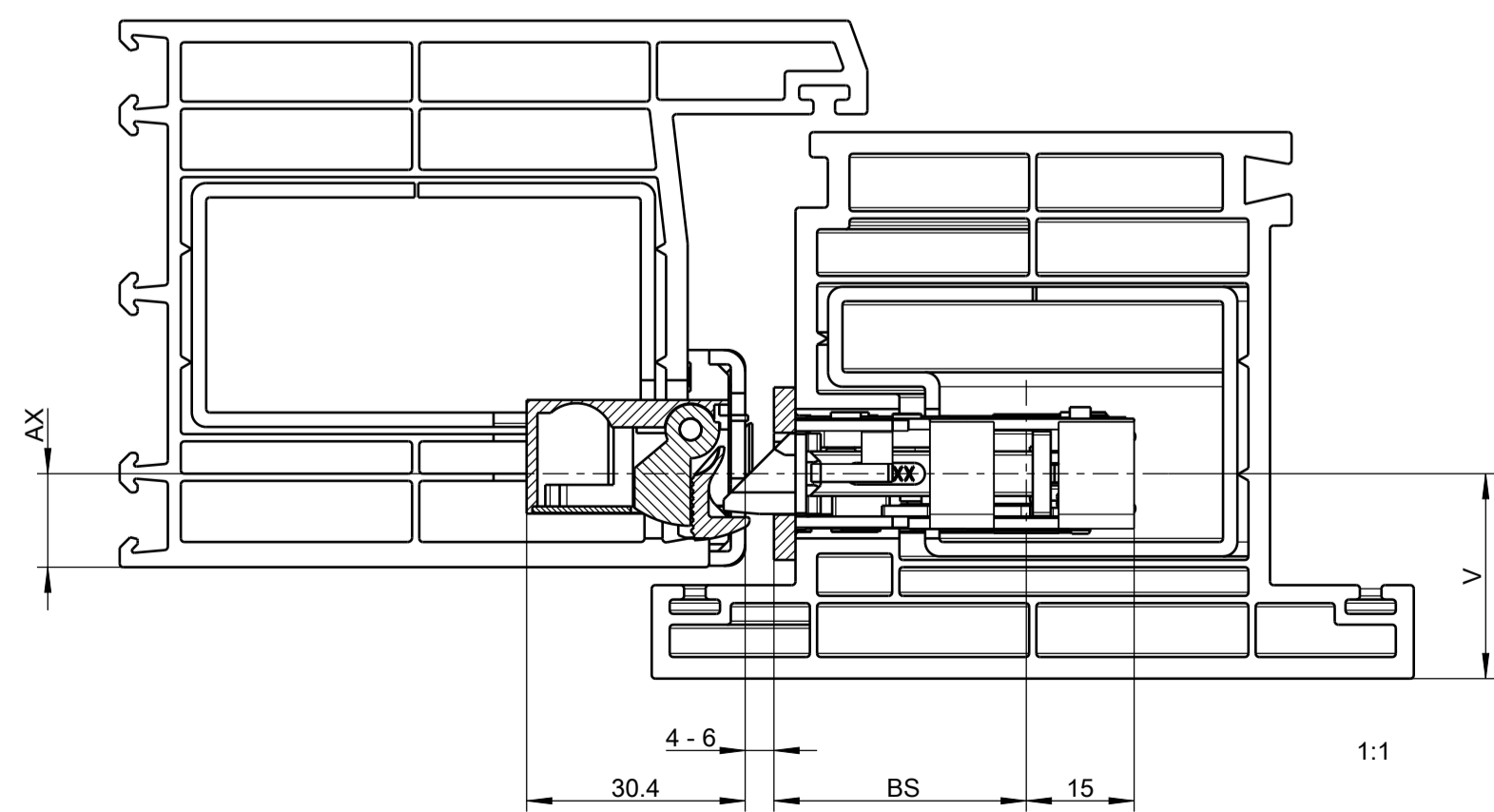

Release motor

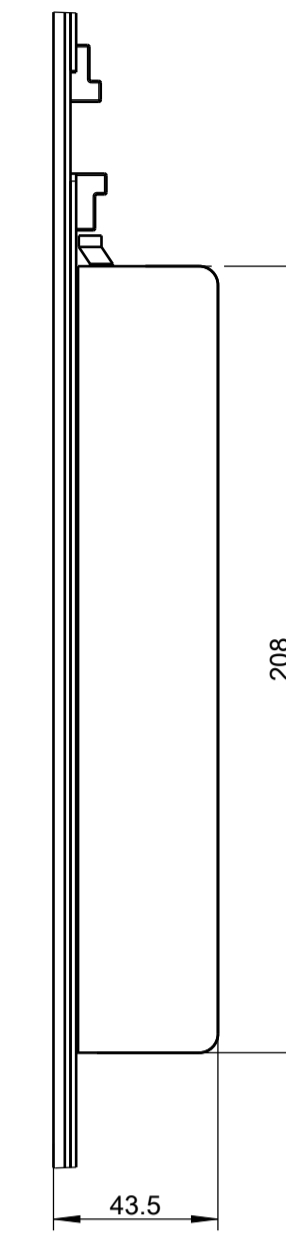

Leaf milling for release motor

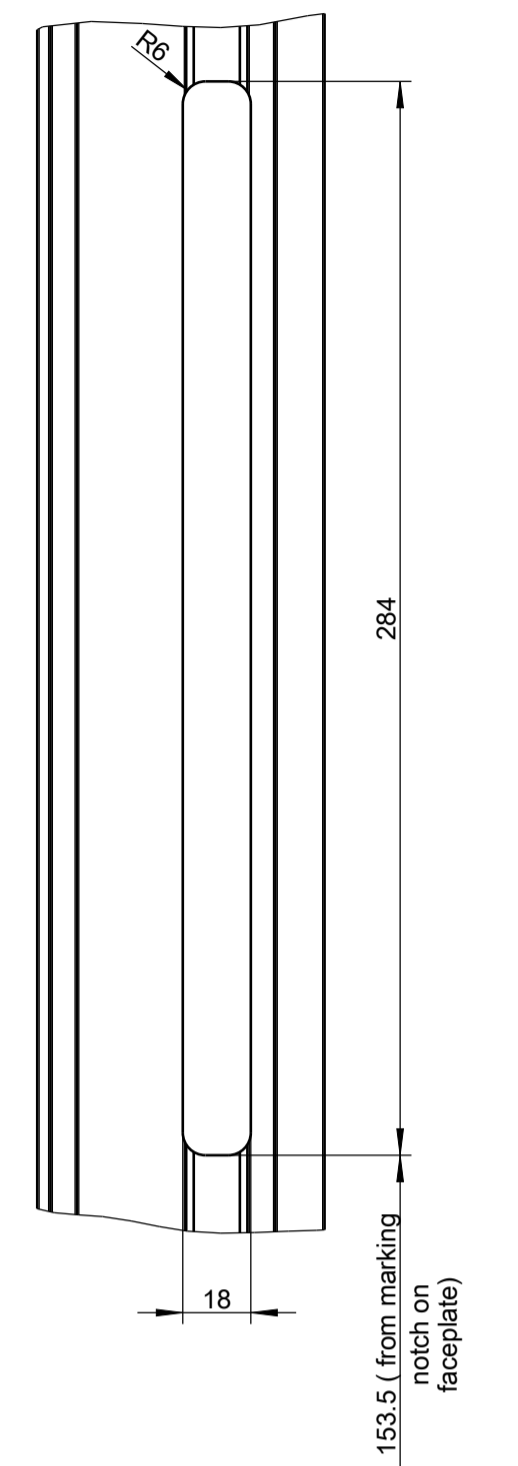

Locking motor

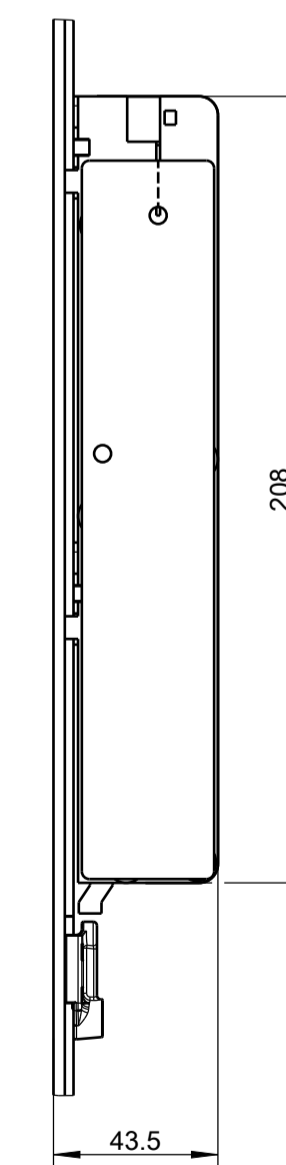

Leaf milling for locking motor

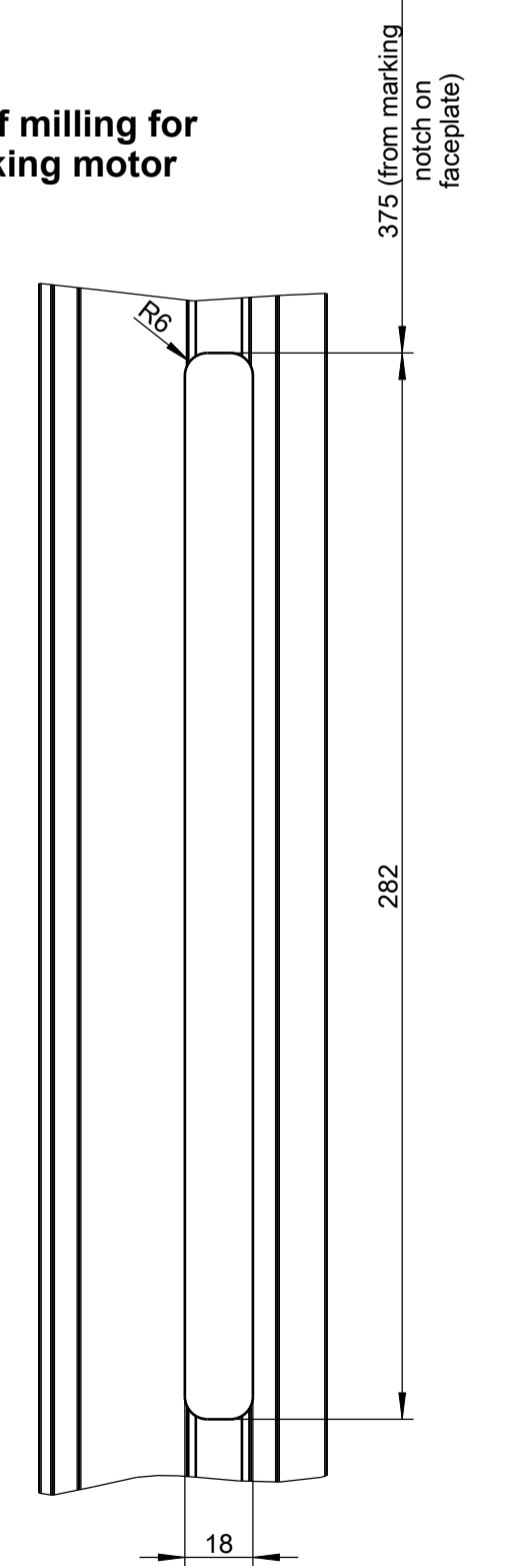

BS = Backset  
 HD = Hole distance  
 V = lock position (depending on profile)  
 AX = Axis

Depicted in drawing:  
 Faceplate = 24 x 3, AX = 13  
 Accessories: 30 x 5

Installation and operating instructions: 0-47647

Release motor  
 Locking motor  
 Electric strike

Description: Multi-point lock SECURITY ePOWER according to EN 179 and EN 1125 Neutral PVC profiles										Scale	Drawing No.	Size	Sheet
GU	Date	Change No.	Sig	Ver.	Replacement for	Revision	Iteration	Level	Released	1:1	0-47439-L0-EN	A1	4/6
	04.10.2022	G40069	EI	Na	--	3	4						

1-leaf Panic

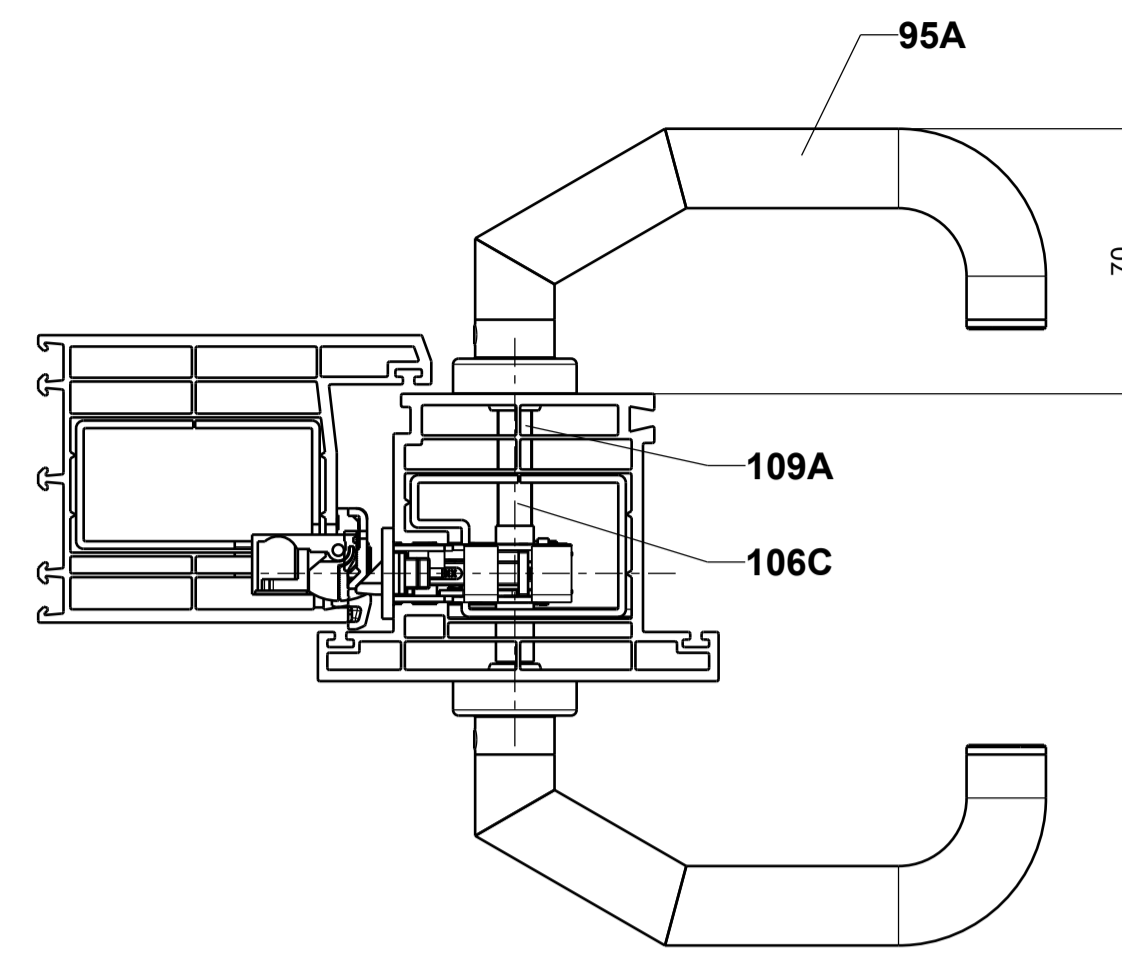
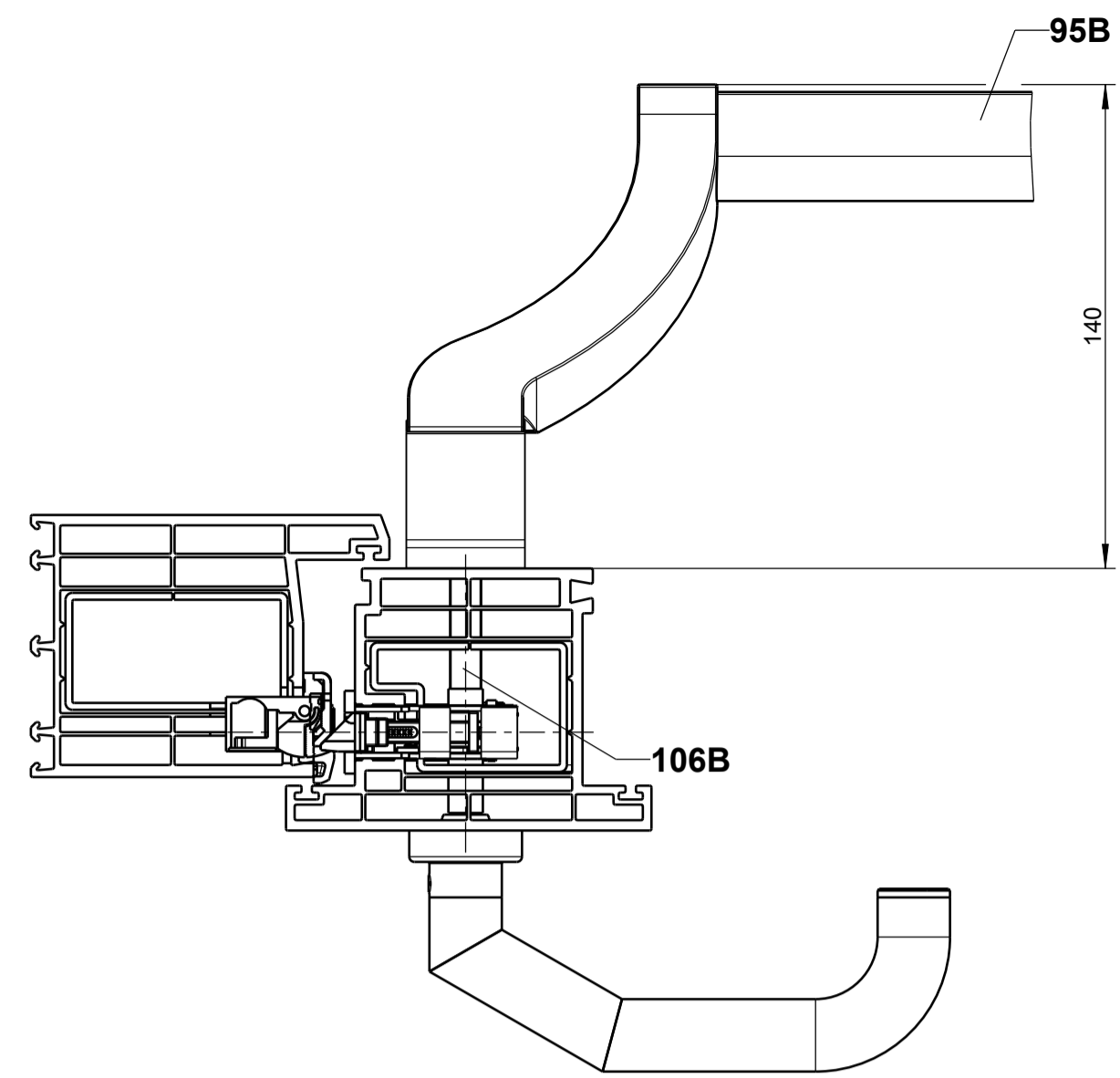
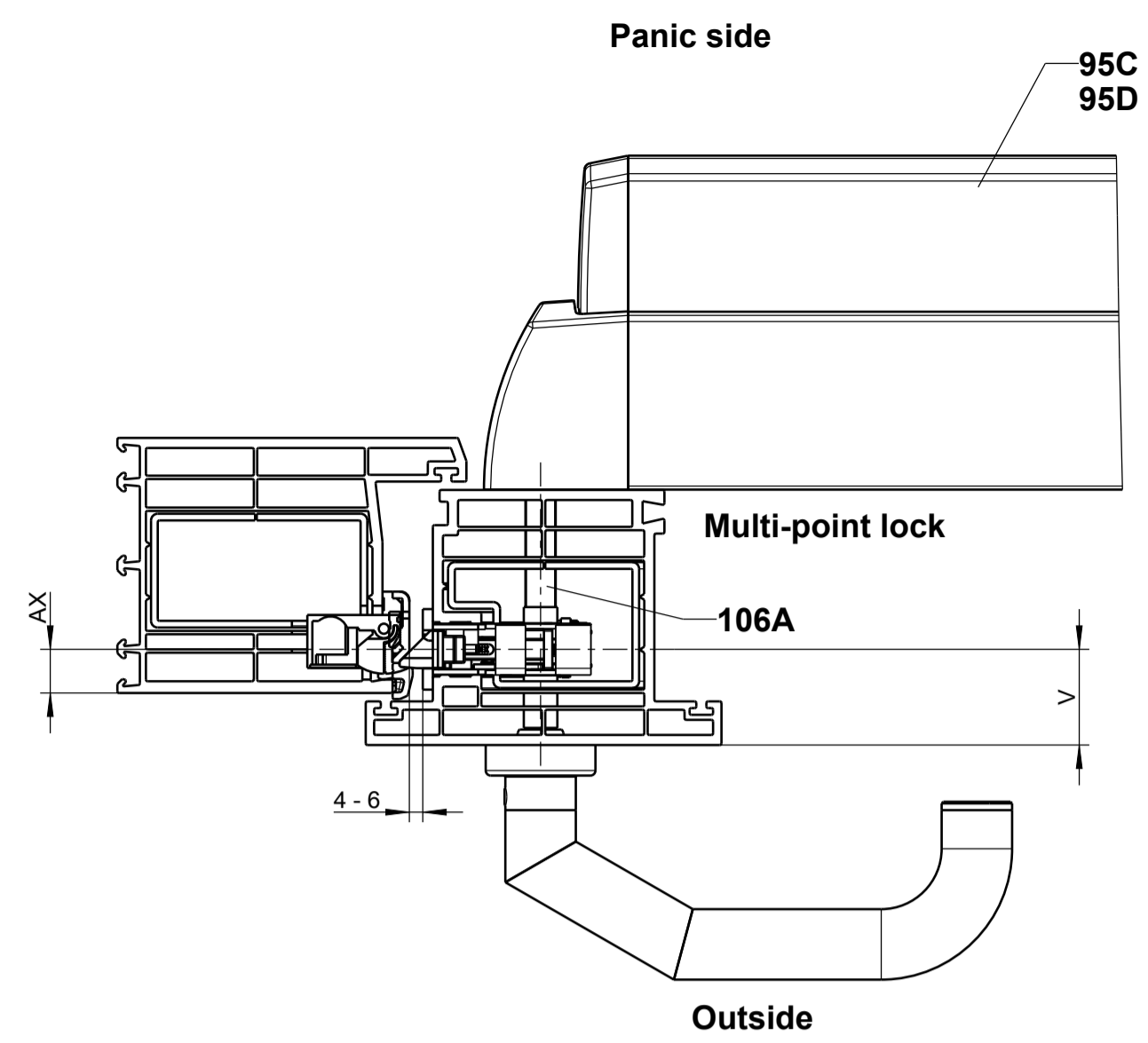

1-leaf Panic  
Inward

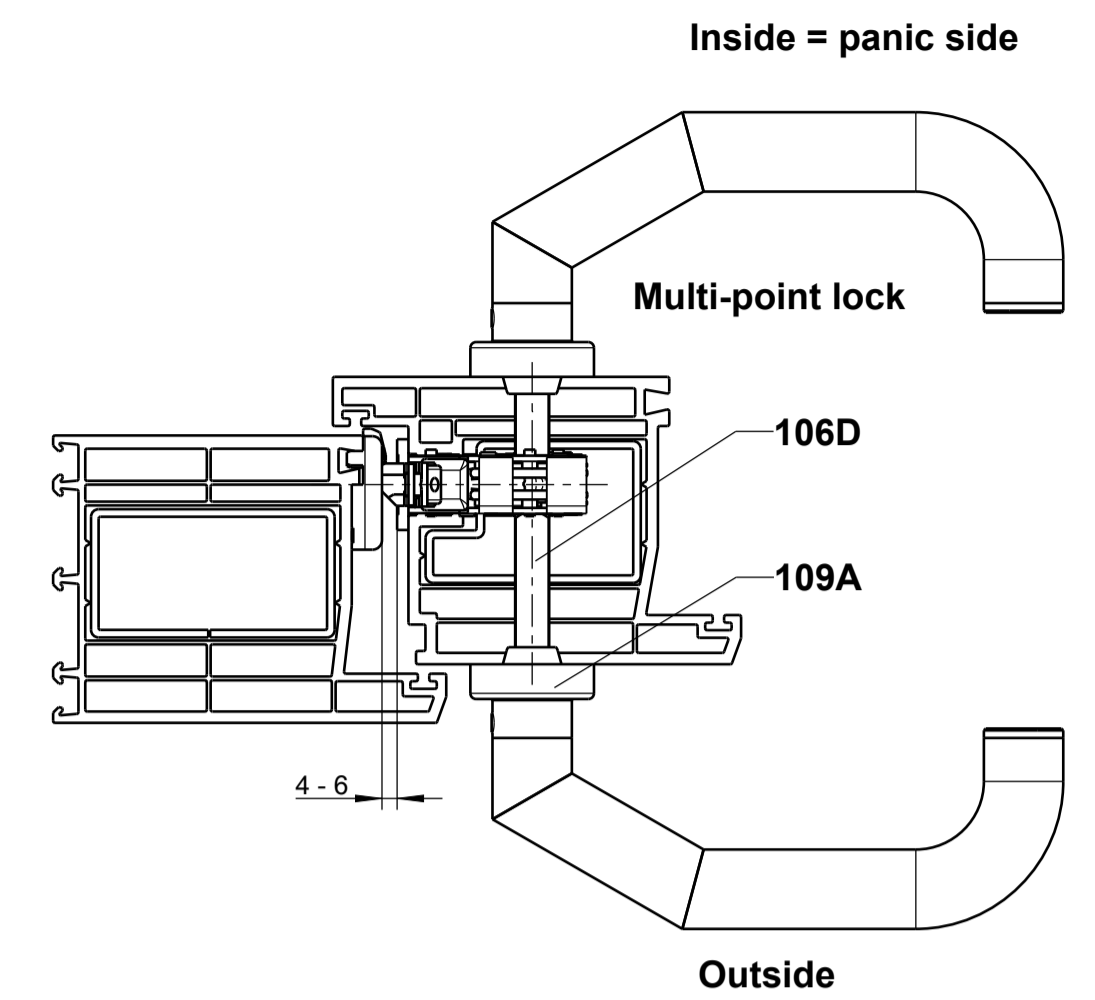

Hook bolt  
Striker

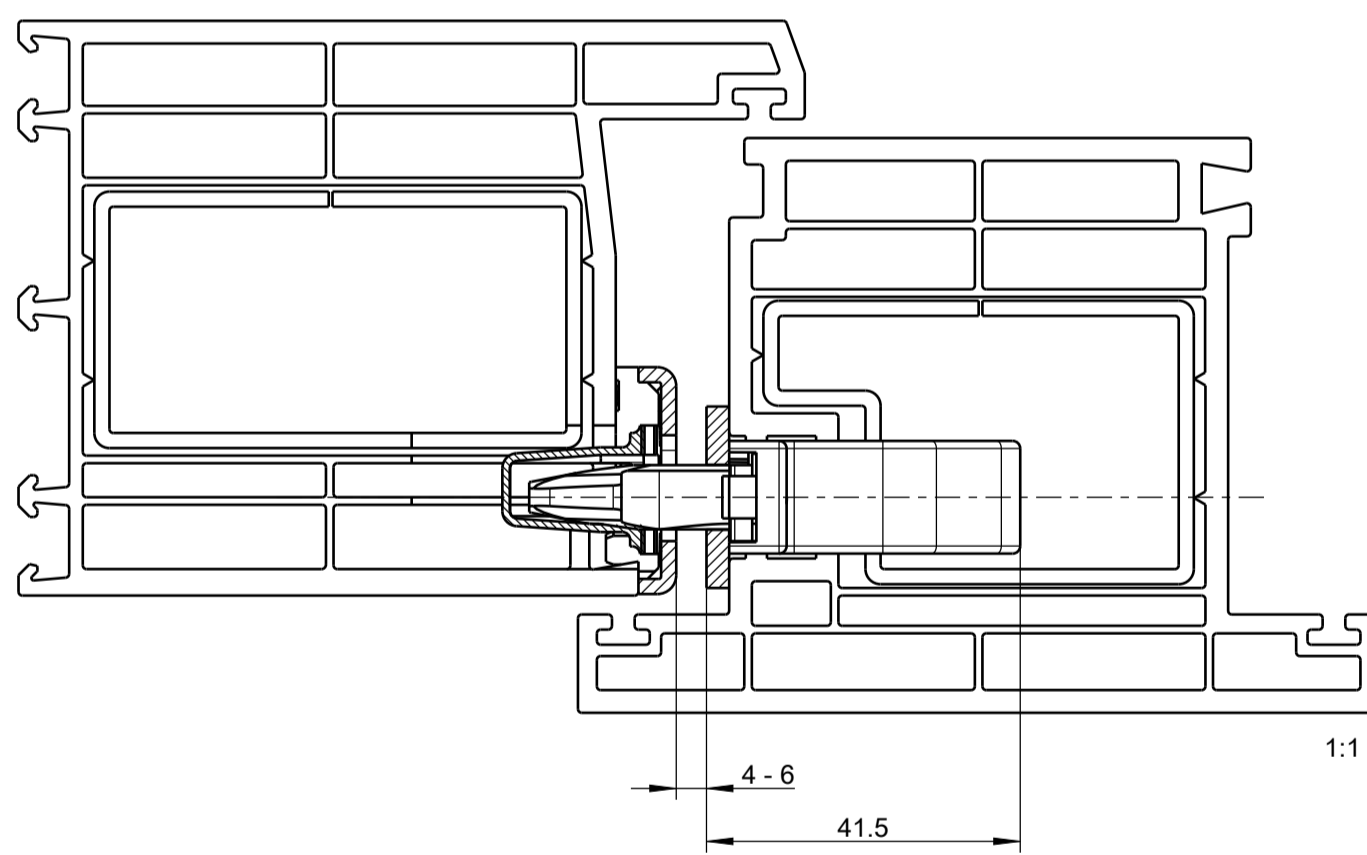

Control unit  
Frame milling for contact plate

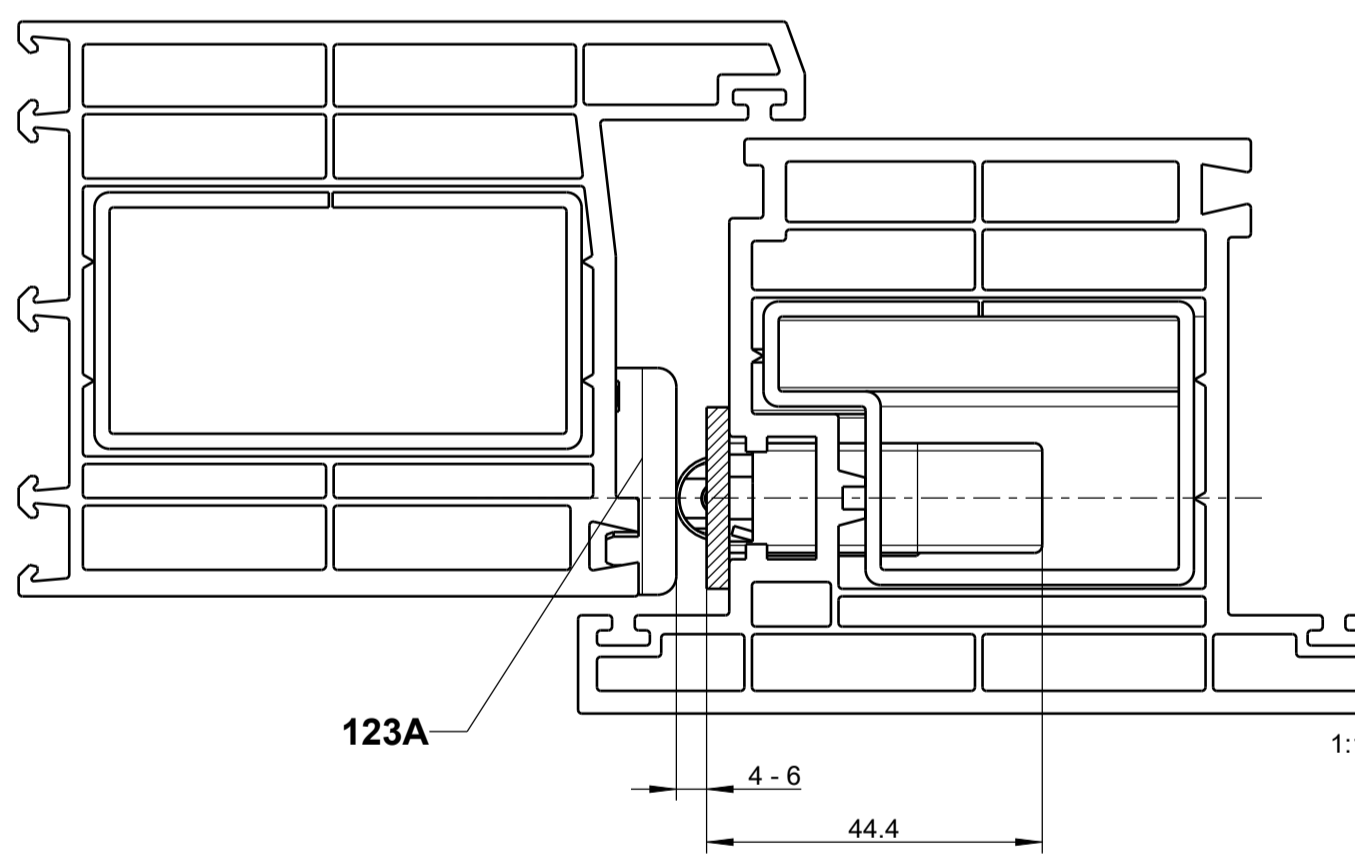

Lock case

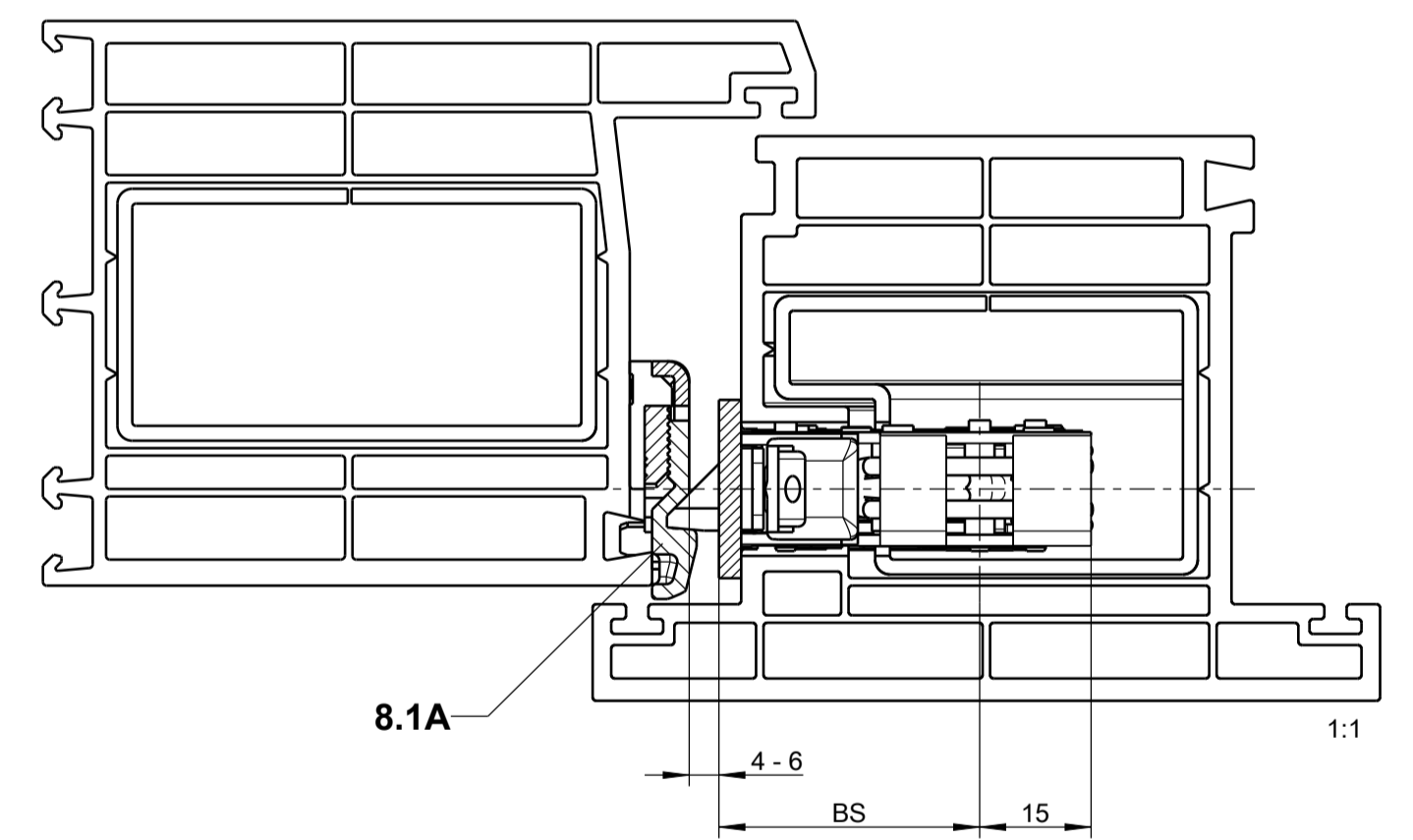

Door hardware for escape doors  
Motor-driven multi-point lock

Description: Multi-point lock SECURITY ePOWER according to EN 179 and EN 1125 Neutral PVC profiles										Scale	Drawing No.	Size	Sheet
GU	Date	Change No.	Sig	Ver.	Replacement for	Revision	Iteration	Level	Released	1:2	0-47439-L0-EN	A1	5/6
	04.10.2022	G40069	EI	Na	--	3	4						



The documents accompanying this product were issued when the product was manufactured. You should verify at www.gu.com if the technical documents you have at hand are up to date. Do not use parts from other technical documents.

EN FR ES RU

SECUREconnect

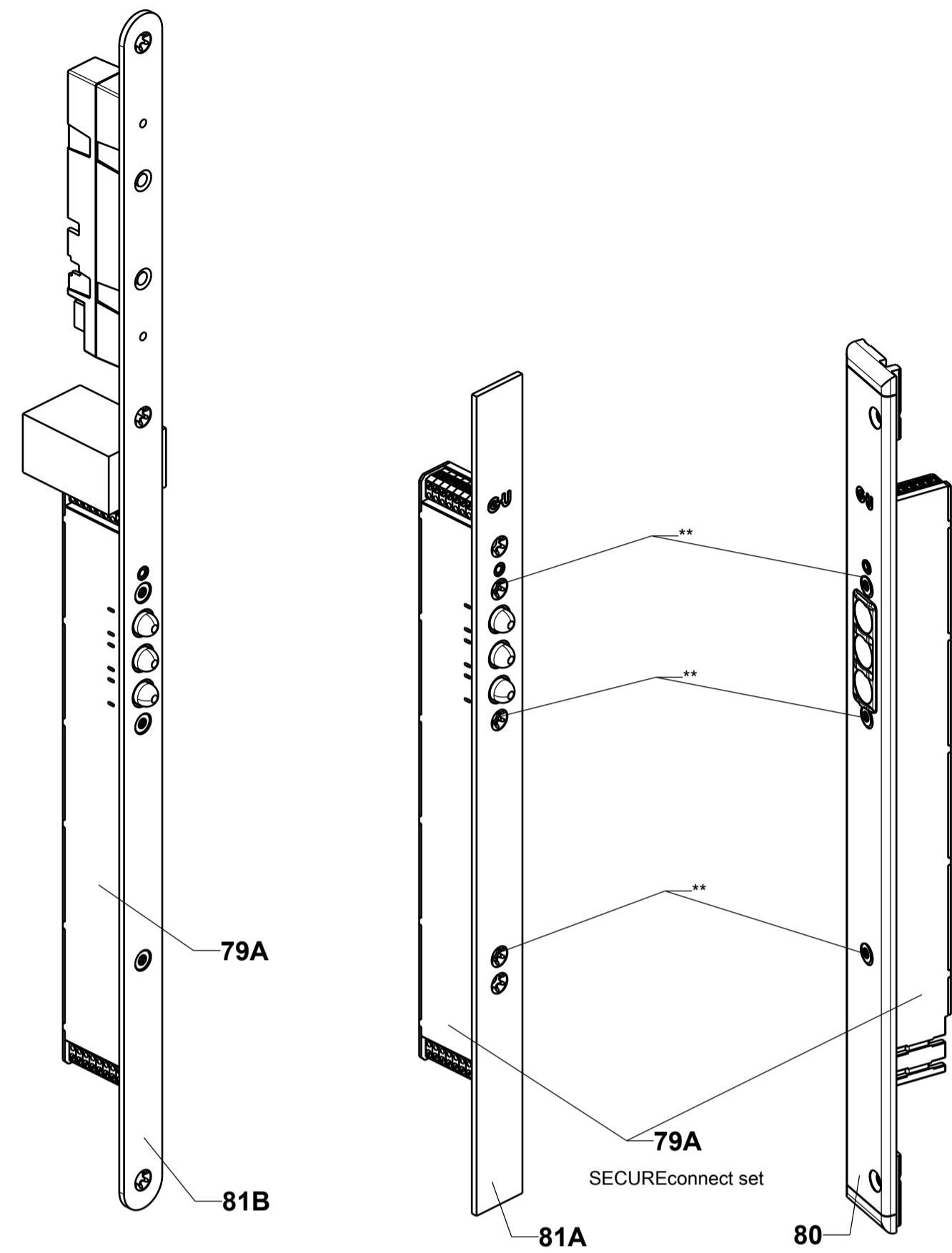

SECUREconnect U-faceplate with moulding

Operating instructions: B-55600-34-4-6 / C59501167  
 Installation instructions: 0-45733-L0  
 with integrated power supply unit

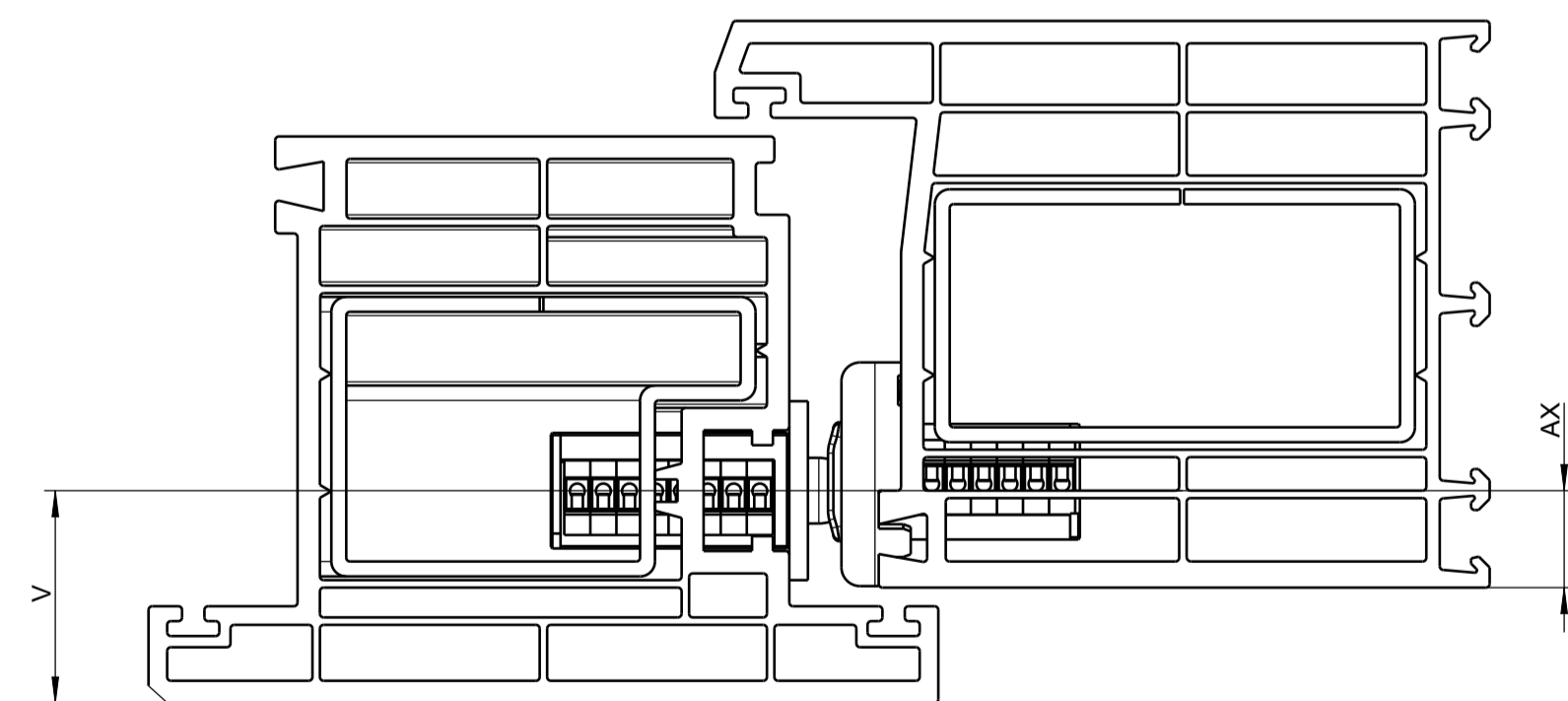

1:1

Cable link

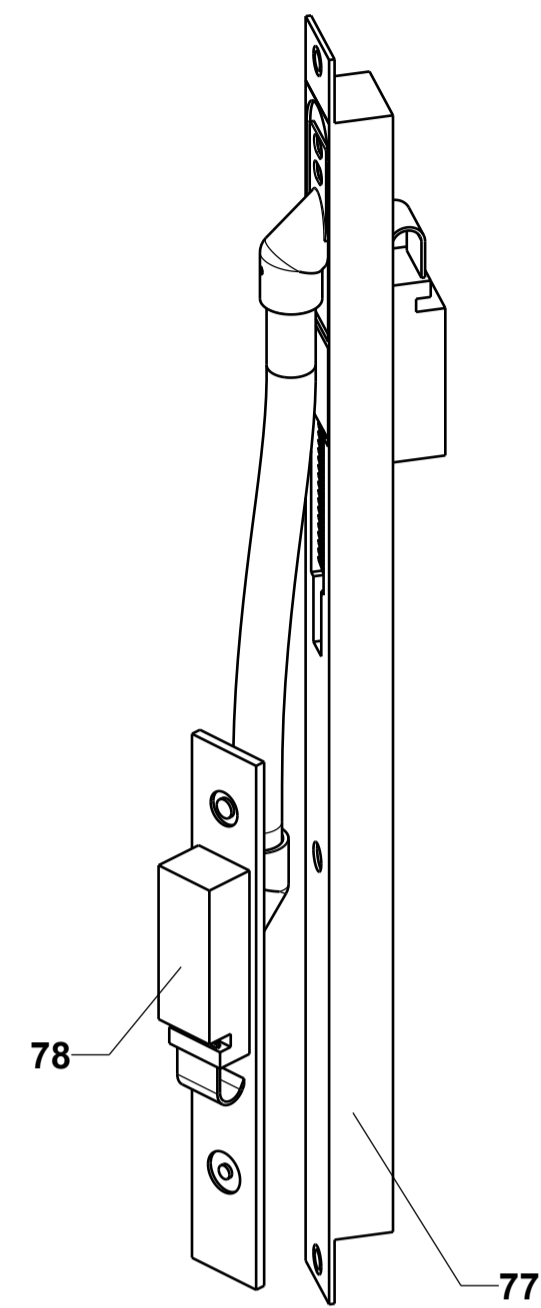

Detachable due to pluggable connector  
 (provided detachable type of  
 cable link is used)

Installation instructions: 0-45510

See order catalogue.

House entrance door hinge

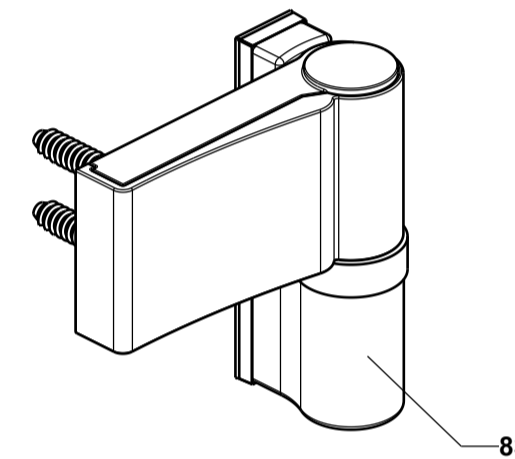
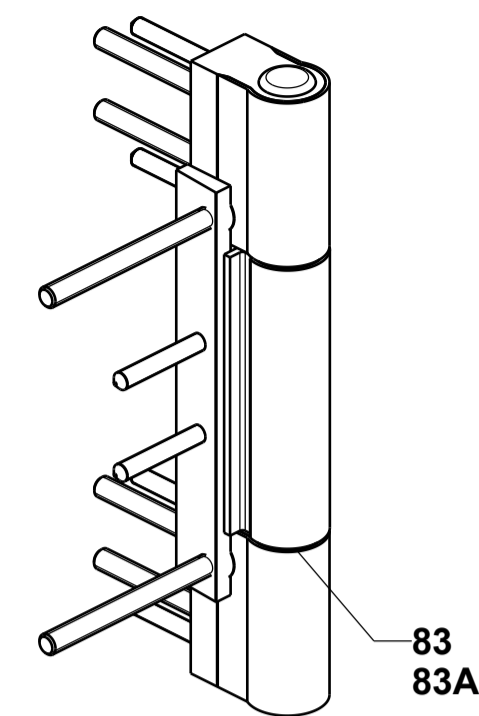

Use security set  
 H-01484-00 for  
 outward-opening doors.

See order catalogue.

Electric strike

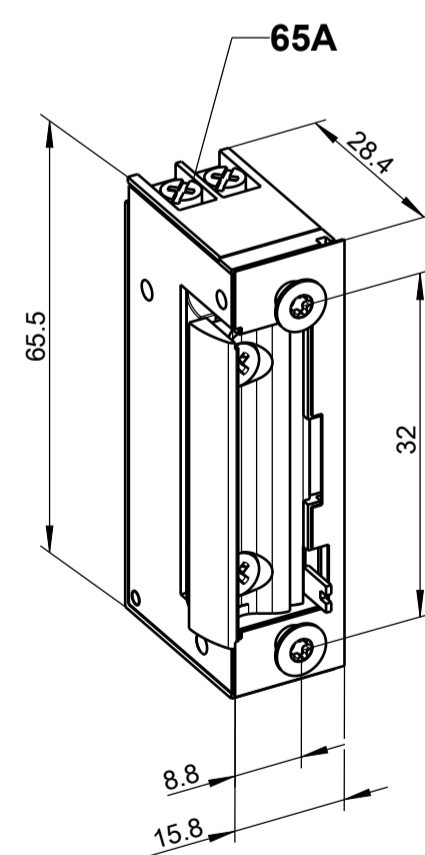

GU-BKS electric strike ET8,  
 fail-secure (A), mechanical  
 override (E), blue terminal  
 block

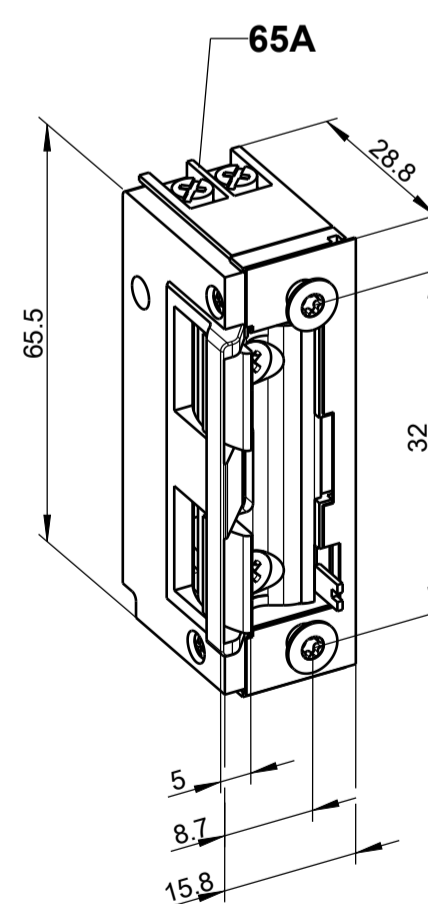

GU-BKS electric strike ET8,  
 fail-secure (A), mechanical  
 override (E), latch slide  
 cover (F), blue terminal  
 block

1:1

BS = Backset  
 HD = Hole distance  
 V = lock position (depending on profile)  
 AX = Axis

Depicted in drawing:  
 Faceplate = 24 x 3, AX = 13  
 Accessories: 30 x 5

Installation and operating instructions: 0-47647

Accessories

Description:  
 Multi-point lock SECURY ePOWER  
 according to EN 179 and EN 1125  
 Neutral PVC profiles